

Proposed Easement

Purpose	Shown	Serv Ten	Dom Ten
Sanitary Sewer and Right of Way	(A) (B)	Lot 2 Lot 1	Lot 1 Lot 2

100
D.P. 19099

PT SE 35
D.P. 1069

103
D.P. 19099

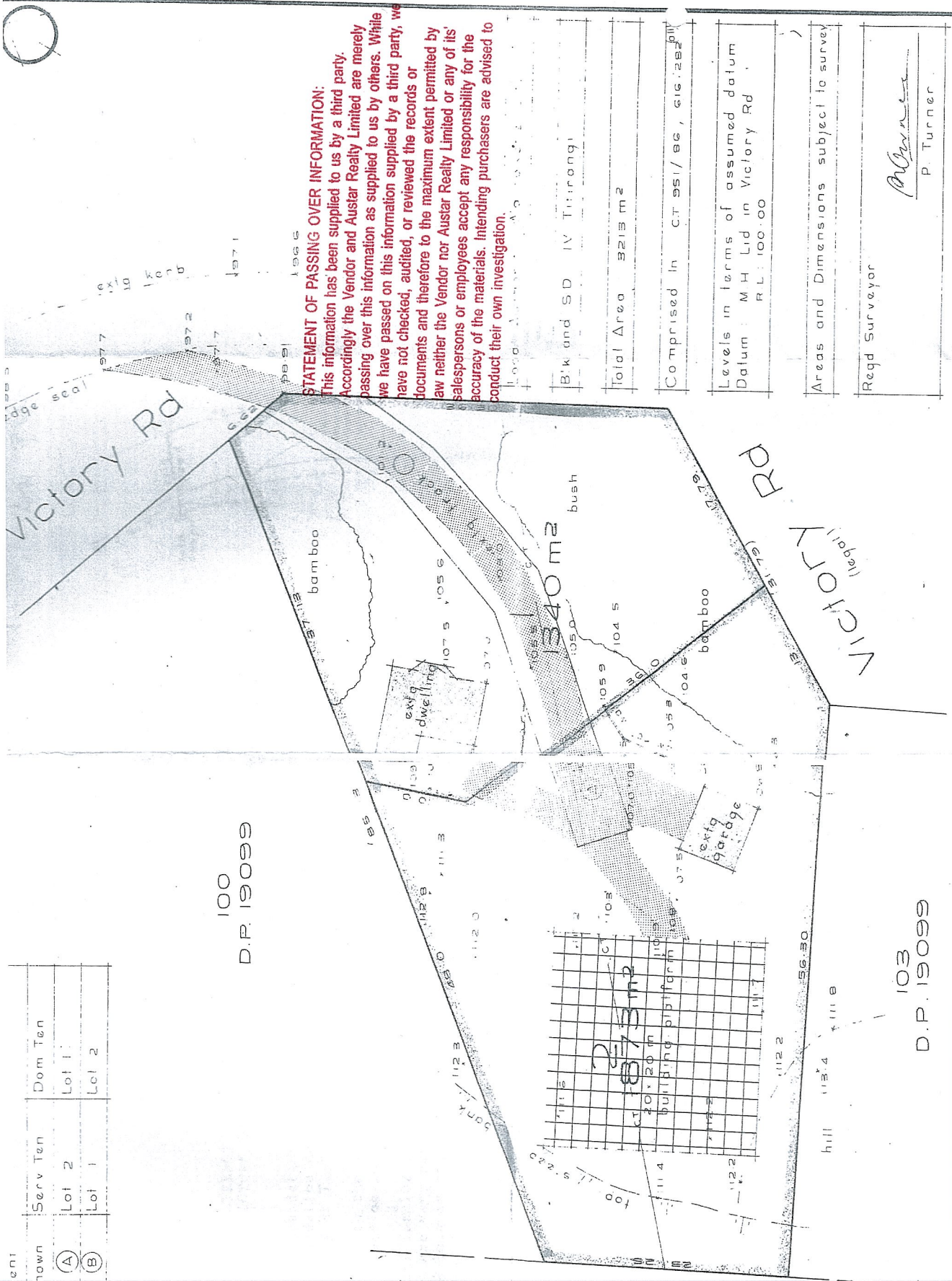

STATEMENT OF PASSING OVER INFORMATION:
 This information has been supplied to us by a third party. Accordingly the Vendor and Austar Realty Limited are merely passing over this information as supplied to us by others. While we have passed on this information supplied by a third party, we have not checked, audited, or reviewed the records or documents and therefore to the maximum extent permitted by law neither the Vendor nor Austar Realty Limited or any of its salespersons or employees accept any responsibility for the accuracy of the materials. Intending purchasers are advised to conduct their own investigation.

B'k and SD IV Titirangi
Total Area 3213 m ²
Comprised in CT 951/86, 616, 282, 911
Levels in terms of assumed datum Datum: M H Lid in Victory Rd RL: 100.00
Areas and Dimensions subject to survey
Regd Surveyor <i>P. Turner</i> P. Turner

Scale: 1:250

Prepared	Checked	Approved

Client: Wilton : Victory Rd, Laingholm
 Project: Proposed Subdivision Lots 101, 102, 103

Job No: C6017
 CATO CONSULTANTS LIMITED
 Registered Land and Engineering Surveyors
 Land Development Consultants
 PO Box 21 395
 Napier 9101/31/01

