

STATEMENT OF PASSING OVER INFORMATION:

This information has been supplied to us by a third party. Accordingly, the Vendor and Austar Realty Limited are merely passing over this information as supplied to us by others. While we have passed on this information supplied by a third party, we have not checked, audited, or reviewed the records or documents and therefore to the maximum extent permitted by law neither the Vendor nor Austar Realty Limited or any of its' salespersons or employees accept any responsibility for the accuracy of the materials. Intending purchasers are advised to conduct their own investigation.

Austar Realty Ltd
DX DP96002
Blockhouse Bay
AUCKLAND



Applicant	Austar Realty Ltd
LIM address	84 Kauri Point Road Laingholm
Application number	8270145221
Customer Reference	84 Kauri Point Road
Date issued	5-Mar-2019
Legal Description	LOT 384 DP 17523
Certificates of title	NA478/220

Disclaimer

This Land Information Memorandum (LIM) has been prepared for the applicant for the purpose of section 44A of the Local Government Official Information and Meetings Act 1987.

The LIM includes information which:

- Must be included pursuant to section 44A of the Local Government Official Information and Meetings Act 1987
- Council at its discretion considers should be included because it relates to land
- Is considered to be relevant and reliable

This LIM does not include other information:

- Held by council that is not required to be included
- Relating to the land which is unknown to the council
- Held by other organisations which also hold land information

Council has not carried out an inspection of the land and/or buildings for the purpose of preparing this LIM. Council records may not show illegal or unauthorised building or works on the land.

The applicant is solely responsible for ensuring that the land or any building on the land is suitable for a particular purpose and for sourcing other information held by the council or other bodies. In addition, the applicant should check the Certificate of Title as it might also contain obligations relating to the land.

The text and attachments of this document should be considered together.

This Land Information Memorandum is valid as at the date of issue only.

s44A(2)(a) Information identifying any special feature or characteristics of the land

This information should not be regarded as a full analysis of the site features of this land, as there may be features that the Council is unaware of. The applicant is solely responsible for ensuring that the land is suitable for a particular purpose including development.

Site Contamination

No land contamination data are available in Council's regulatory records.

Wind Zones

Wind Zone(s) for this property: Specific engineering design (not covered by NZS 3604:2011)

The wind zones are based on wind speed data specific to all building sites as outlined in NZS 3604:2011. Other factors such as topographic classes, site exposure and ground roughness determine the actual wind bracing demands and bracing elements required for the building.

For further information refer to NZS 3604:2011 Section 5 — Bracing Design

Soil Issues

Soil issues recorded. The land may not be suitable for particular development or land use purposes. A soil report may be required to/must be submitted with any building and/or resource consent application.

Effective Date	Description	Details
30/06/2000	Stability Sensitive	Please note this property was previously shown under the Transitional District Plan as being located in a Stability sensitive area.

If any soil information/reports have been prepared in relation to this property, they will be available for viewing at an Auckland Council Service Centre.

Flooding

This statement entitled "Flooding" appears on all LIMs.

Known flooding information is displayed on the map attached to this LIM entitled "Special Land Features – Natural Hazards - Flooding".

The information shown in the "Special Land Features - Natural Hazards - Flooding" map is also shown on the Auckland Council online map viewer (Geomaps), at www.aucklandcouncil.govt.nz, which is updated from time to time.

Any proposed development may require a flooding assessment to be provided by the applicant.

The absence of flooding on the "Special Land Features - Natural Hazards - Flooding" map does not exclude the possibility of the site flooding, particularly from Overland Flow Paths which may be on other properties.

Exposure Zones

New Zealand Standard 3604:2011 classifies all properties in New Zealand into zones based on environmental features including wind, earthquake, snow load and exposure. These zones are relevant to building requirements, such as strength of buildings, materials that should be used and maintenance. All building sites are classified as being in Exposure Zones Extreme Sea Spray, B, C, or D, depending on the severity of exposure to wind driven salt.

This property is classified as: Zone D

High — Coastal areas with high risk of wind-blown sea-spray salt deposits. This is defined as within 500m of the sea including harbours, or 100m from tidal estuaries and sheltered inlets. The coastal area also includes all offshore islands including Waiheke Island, Great Barrier Island. Within each of the zones there are different environmental locations that require fittings and fixtures appropriate to its designation as outlined Tables 4.1 to 4.3 in NZS 3604:2011 being either "closed", "sheltered" or "exposed". For further information refer to NZS 3604:2011 Section 4 — Durability.

s44A(2)(b) Information on private and public stormwater and sewerage drains

Information on private and public stormwater and sewerage drains is shown on the **underground services map** attached.

Note: Private drainage is the responsibility of the land owner up to and including the point of connection to the public sewer or drain.

s44(2)(ba) Information notified to Council by a drinking water supplier under Section 69ZH of the Health Act 1956

Prospective purchasers should be aware of other drinking water systems connected to this property. There may also be private drinking water supply systems such as rainwater tanks or private water bores. You are advised to clarify the drinking water supply with the current landowner.

No Information has been notified to Council.

s44A(2)(bb) Information Council holds regarding drinking water supply to the land

For metered water information, please contact **Watercare (09) 422 2222** for services provided to this property.

s44A(2)(c) Information relating to any rates owing in relation to the land

Billing Number/ Rate Account:	12341886854
Rates levied for the Year 2018/2019 :	\$2,742.14
Total rates to clear for the current year (including any arrears):	\$742.58

The rates figures are provided as at 8 a.m. 05/03/2019. It is strongly advised these are not used for settlement purposes.

Retrofit Your Home Programme

The Retrofit Your Home programme provides financial assistance, advice and information to householders wanting to create an improved home environment.

The scheme contributes to the achievement of the Air Quality National Environmental Standards encouraging the installation of clean heat and insulation in homes as well as supporting access to central government grants and subsidies. The programme offers homeowners a retrofit plan for their homes and financial assistance up to \$5000 repaid through a targeted rate.

 Auckland Council (09) 890 7898 if you require further information

 retrofit@aucklandcouncil.govt.nz

s44A(2)(d) Consents, Certificates, Notices, Orders or Requisitions affecting the land or any buildings on the land(da) the information required to be provided to a territorial authority under section 362T(2) of the Building Act 2004:s44A and (2)(e) Information concerning any Certificate issued by a Building Certifier pursuant to the Building Act 1991 or the Building Act 2004

Note: if the land is part of a cross lease title or unit title, consents and permits for the other flats or units may be included in this LIM. If the land has been subdivided there may be consents and permits included that relate to the original property.

It is recommended that the full property file is viewed and compared with the actual building and activities on the land to identify any illegal or unauthorised building works or activities.

Financial / development contributions

Financial and development contributions are relevant for recently subdivided land, vacant lots, new residential unit(s) or where there is further development of a site. If any financial or development contribution has not been paid, Council can recover outstanding amount(s) from a subsequent owner of the land.

Please note that financial contributions and development contributions may be paid in land, cash or a combination of these. The form of payment of contributions may be subject to negotiation but final discretion remains with the Council.

Resource Management

Planning

84 Kauri Point Road Laingholm

Application No.	Description	Decision	Decision Date
LUC-2000-2326	Land Use Consent Consent to convert existing garage. Further than 3m from existing dwelling (bush living)	Granted	12/12/2000

Subdivisions

There are **NO** Subdivision resource consents recorded.

Engineering Approvals

There are **NO** Engineering approvals recorded.

If there are any conditions, then only that portion of the consent will be included in the attachments section. The applicant should satisfy themselves as to whether all conditions of resource consents for this property have been met.

Further Information

The Council may hold additional information for this property, for example concerning resource consents for discharges to air, land or water issued by the former Auckland Regional Council prior to 1 November 2010. If you would like Auckland Council to search for this type of information, please contact us.

Building

84 Kauri Point Road Laingholm

Application No.	Description	Issue Date	Status
BPM-1975-2938	Garage	31/12/1975	Issued (See Note 1)
ABA-1999-3928	Installation of woodburning stove	05/08/1999	CCC Issued 13/12/1999 (See Note 2)
ABA-2001-17	Connect wastewater drainage from minor unit to drain	05/01/2001	CCC Issued 26/01/2001 (See Note 2)

Note	Description
1	Permit issued prior to the Building Act 1991 taking effect. Code Compliance Certificates (CCC) were not required.
2	Code Compliance Certificate (CCC) for this consent was issued.

Please note that prior to the Building Act 1991; Councils were not required to maintain full records of building consents [etc] issued under the Building Act. While Auckland Council has always endeavoured to maintain full records of pre-Building Act 1991 matters, not all records for this period have survived and in other cases where building work is documented, information may be incomplete. Council does not accept responsibility for any omission.

It is recommended that the Council property file is viewed and compared with the actual building and activities on site to identify any illegal or unauthorised building works or activities.

Unauthorised Building Works

Prior to the Auckland Council amalgamation, legacy Councils had different processes for dealing with Unauthorised/Unconsented Work. These records are listed below.

From 1st August 2011, Independent Building reports or plans, for unauthorised work that was carried out

without a permit prior to 1992, may be submitted to Council to be placed on the relevant Property File, subject to payment of a fee. These reports are not included in a LIM. Please contact us or visit one of our Service Centres if you wish to view the Property File.

Reference	Description	Note
A reference number is not recorded by Council for this type of record	Auckland Council is aware that Unauthorised Works have been carried out on this property. REQ-2001-203 Garage/studio was changed to minor unit.	Refer to Property File for further information.

Compliance Schedules (Building Warrant of Fitness)

The Council has no record of a Compliance Schedule for this property/building.

If it is evident that any specified systems such as lifts or commercial fire alarms are present in the building, the owner must ensure there is a current compliance schedule or building warrant of fitness.

Swimming/Spa Pool Barriers

The Council has no record of a swimming pool or spa pool being registered on this property. Swimming pools and spa pools must have a barrier that complies with the Building Act 2004.

Pool barrier information is available for viewing at <http://www.aucklandcouncil.govt.nz>

Licences

There are NO current licences recorded

s44A(2)(ea) Information notified under Section 124 of the Weathertight Homes Resolution Services Act 2006

The Council has not been notified of any information under Section 124 of the Weathertight Homes Resolution Services Act 2006 relating to this property.

s44A (2)(f) Information relating to the use to which the land may be put and any conditions attached to that use

Purchasers or those intending to develop the land should satisfy themselves that the land is suitable for any intended use or future development proposal. In addition to any site specific limitations recorded below, general restrictions that apply across the region may be relevant to any development proposals on this property.

Auckland Unitary Plan - Operative in Part (AUP:OP)

The **Auckland Unitary Plan - Operative in part(AUP:OP)** applies to this property and should be carefully reviewed and considered, as it may have implications for how this property can be developed and/or used. Those parts of the Auckland Unitary Plan that are operative replace the corresponding parts of legacy regional and district plans. However, certain parts of the AUP:OP are the subject of appeals and have not

become operative. If a property is subject to an appeal this will be identified on the attached Unitary Plan Property Summary Report. Where this is the case, both the Auckland Unitary Plan Decisions version and the legacy regional and district plans will need to be considered.

The AUP:OP zones, controls, overlays, precincts, and designations that apply to this property are set out in the Property Summary Report, which is attached to this memorandum.

The AUP:OP can be viewed here:

<https://www.aucklandcouncil.govt.nz/unitaryplan>

The legacy regional and district plans can be viewed here:

<https://www.aucklandcouncil.govt.nz/districtplans>

<https://www.aucklandcouncil.govt.nz/regionalplans>

The appeals to the AUP:OP can be viewed here:

<https://www.aucklandcouncil.govt.nz/unitaryplanappeals>

Auckland Council District Plan - Hauraki Gulf Islands Section (Operative 2013) (DP:HGI)

While the regional provisions in the AUP:OP apply to the Hauraki Gulf Islands, and are set out in the Property Summary Report attached to this memorandum, the AUP:OP does not contain any district provisions for the Hauraki Gulf Islands. If the Property Summary Report attached to this memorandum lists its zone as "Hauraki Gulf Islands", the district provisions that apply are in the Auckland Council District Plan Hauraki Gulf Islands Section (Operative 2013) (DP:HGI).

The relevant maps of the DP:HGI are attached to this memorandum, if applicable. The text of the DP:HGI can be found here:

<https://www.aucklandcouncil.govt.nz/haurakigulfislands>

Plan Changes and Notices of Requirement

Changes to the AUP:OP and DP:HGI may be proposed from time to time. These proposed plan changes may relate to either the maps or the text of those plans. Any proposed changes to the AUP:OP relevant to this property will be listed as a modification in the Property Summary Report attached to this memorandum. However, proposed changes to the DP:HGI will not appear on the Property Summary report. That information can be found on the Auckland Council website.

Please refer to the AUP:OP for information on any proposed Plan Changes or see the Auckland Council modifications website at:

<https://www.aucklandcouncil.govt.nz/unitaryplanmodifications>

Information relating to any proposed Plan Changes to DP:HGI can be found here:

<https://www.aucklandcouncil.govt.nz/haurakigulfislands>

From time to time a requiring authority, such as a Ministry of the Crown or a council controlled organisation, may notify Auckland Council that they require certain land to be designated for a certain purpose. If this property is the subject of such a notice of requirement, that notice may have implications for how this property can be developed or used from the date it is received by Council.

If this property is not on the Hauraki Gulf Islands, any notices of requirement applicable will be listed as a modification in the Property Summary Report attached to this memorandum.

If this property is on the Hauraki Gulf Islands, any notice of requirement will be available on the Auckland Council Website.

Information on all current notices of requirement can be found on the modifications page here:

<https://www.aucklandcouncil.govt.nz/unitaryplanmodifications>

Copies of the appeals to the Auckland Unitary Plan can be viewed online at:
<https://www.aucklandcouncil.govt.nz/unitaryplanappeals>

Information concerning Caveat, Bond, Encumbrance, Consent Notice and Covenant

For any information concerning Caveats, Bonds, Encumbrances, Consent Notices or Covenants, please refer to the Certificate of Title for this property.

s44A(2)(g) Information regarding the land which has been notified to Council by another statutory organisation

No information has been notified to Council.

s44A(2)(h) Information regarding the land which has been notified to Council by any network utility operator pursuant to the Building Act 1991 or Building Act 2004

Underground Services and District Plan maps are attached.

Please note: Height restrictions apply where overhead power lines cross the site. Works near water services utilities may require approval. Works near high-pressure Gas, Oil or LPG pipelines create risk of damage and must first be approved. Please contact the relevant Utility provider in your area for further information.

Any escape of gas or liquid from the pipelines is potentially dangerous and requires immediate action as soon as discovered (Dial 111 and ask for the Fire Service).

Attachments

As the placement of the building/s on the attached maps is based on aerial photography we cannot guarantee the accuracy. A formal survey will indicate the exact location of the boundaries.

- Auckland Unitary Plan Property Summary Report
- Auckland Unitary Plan - Operative in part Maps and Map Legend
- Auckland Council District Plan - Hauraki Gulf Islands Section (if applicable)
- Underground Services & Utilities Map and Map Legend
- Special Land Features Map and Map Legend

Please note Map Legends have been created for use across the region and may contain features which were not captured by the previous legacy Councils; therefore the information may not be available for these maps. Please contact the Resource Management Planning Team in your area for further information on any features which may or may not appear on your map.

- As Built Drainage Plan : ABA-2000-017
- As Built Drainage Plan : 84 Kauri Point Road
- Consent Conditions : LUC-2000-2326

Auckland Unitary Plan Operative in part (15th November 2016) Property Summary Report

Address

84 Kauri Point Road Laingholm

Legal Description

LOT 384 DP 17523

Appeals

Seeking changes to zones or management layers - ENV-2017-AKL-000167 - Waitakere Ranges Heritage Area Overlay - [View PDF](#)

Modifications

Notice of Requirements - NoR 7: Proposed Northern Runway - Airspace Restriction Designations - [View PDF](#) - Notified - 15/02/2018

Zones

Residential - Large Lot Zone

Precinct

Controls

Controls: Macroinvertebrate Community Index - Native

Controls: Macroinvertebrate Community Index - Urban

Overlays

Natural Heritage: Outstanding Natural Landscapes Overlay [rcp/dp] - Area 72 - South Titirangi

Natural Heritage: Ridgeline Protection Overlay - Modified

Natural Heritage: Waitakere Ranges Heritage Area Overlay - Extent of Overlay

Natural Heritage: Waitakere Ranges Heritage Area Overlay - WRHA_07 - Subdivision Schedule

Natural Resources: Significant Ecological Areas Overlay - SEA_T_5539 - Terrestrial

Designations



DISCLAIMER:
 This map/plan is illustrative only and all information should be independently verified on site before taking any action.
 Copyright Auckland Council. Land Parcel Boundary information from LINZ (Crown Copyright Reserved). Whilst due care has been taken, Auckland Council gives no warranty as to the accuracy and plan completeness of any information on this map/plan and accepts no liability for any error, omission or use of the information. Height datum: Auckland 1946.

Built Environment
84 Kauri Point Road Laingholm
LOT 384 DP 17523

0 7 14 21
 Meters
Scale @ A4
 = 1:1,000
Date Printed:
 5/03/2019



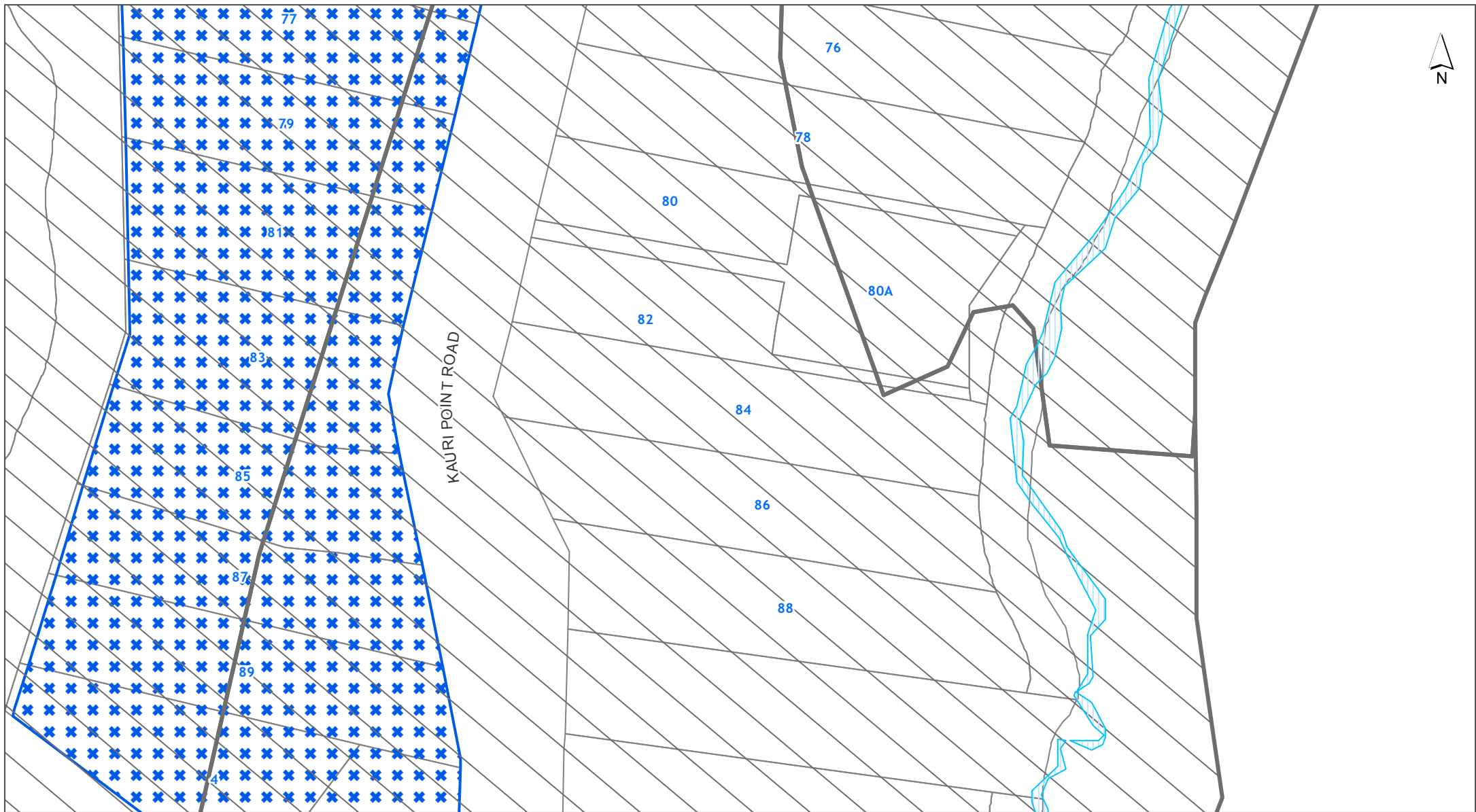

DISCLAIMER:
This map/plan is illustrative only and all information should be independently verified on site before taking any action. Copyright Auckland Council. Land Parcel Boundary information from LINZ (Crown Copyright Reserved). Whilst due care has been taken, Auckland Council gives no warranty as to the accuracy and plan completeness of any information on this map/plan and accepts no liability for any error, omission or use of the information. Height datum: Auckland 1946.

Controls
84 Kauri Point Road Laingholm
LOT 384 DP 17523

0 7 14 21
Meters
Scale @ A4
= 1:1,000
Date Printed:
5/03/2019





DISCLAIMER:
 This map/plan is illustrative only and all information should be independently verified on site before taking any action. Copyright Auckland Council. Land Parcel Boundary information from LINZ (Crown Copyright Reserved). Whilst due care has been taken, Auckland Council gives no warranty as to the accuracy and plan completeness of any information on this map/plan and accepts no liability for any error, omission or use of the information. Height datum: Auckland 1946.

Designations

84 Kauri Point Road Laingholm

LOT 384 DP 17523



Scale @ A4
 = 1:1,000

Date Printed:
 5/03/2019





DISCLAIMER:
 This map/plan is illustrative only and all information should be independently verified on site before taking any action.
 Copyright Auckland Council. Land Parcel Boundary information from LINZ (Crown Copyright Reserved). Whilst due care has been taken, Auckland Council gives no warranty as to the accuracy and plan completeness of any information on this map/plan and accepts no liability for any error, omission or use of the information. Height datum: Auckland 1946.

Historic Heritage and Special Character
84 Kauri Point Road Laingholm
LOT 384 DP 17523

0 7 14 21
 Meters
Scale @ A4
 = 1:1,000
Date Printed:
 5/03/2019





DISCLAIMER:
 This map/plan is illustrative only and all information should be independently verified on site before taking any action.
 Copyright Auckland Council. Land Parcel Boundary information from LINZ (Crown Copyright Reserved). Whilst due care has been taken, Auckland Council gives no warranty as to the accuracy and plan completeness of any information on this map/plan and accepts no liability for any error, omission or use of the information. Height datum: Auckland 1946.

Infrastructure
84 Kauri Point Road Laingholm
LOT 384 DP 17523

0 7 14 21
 Meters
Scale @ A4
 = 1:1,000
Date Printed:
 5/03/2019





DISCLAIMER:
This map/plan is illustrative only and all information should be independently verified on site before taking any action. Copyright Auckland Council. Land Parcel Boundary information from LINZ (Crown Copyright Reserved). Whilst due care has been taken, Auckland Council gives no warranty as to the accuracy and plan completeness of any information on this map/plan and accepts no liability for any error, omission or use of the information. Height datum: Auckland 1946.

Mana Whenua
84 Kauri Point Road Laingholm
LOT 384 DP 17523

0 7 14 21
Meters
Scale @ A4
= 1:1,000
Date Printed:
5/03/2019



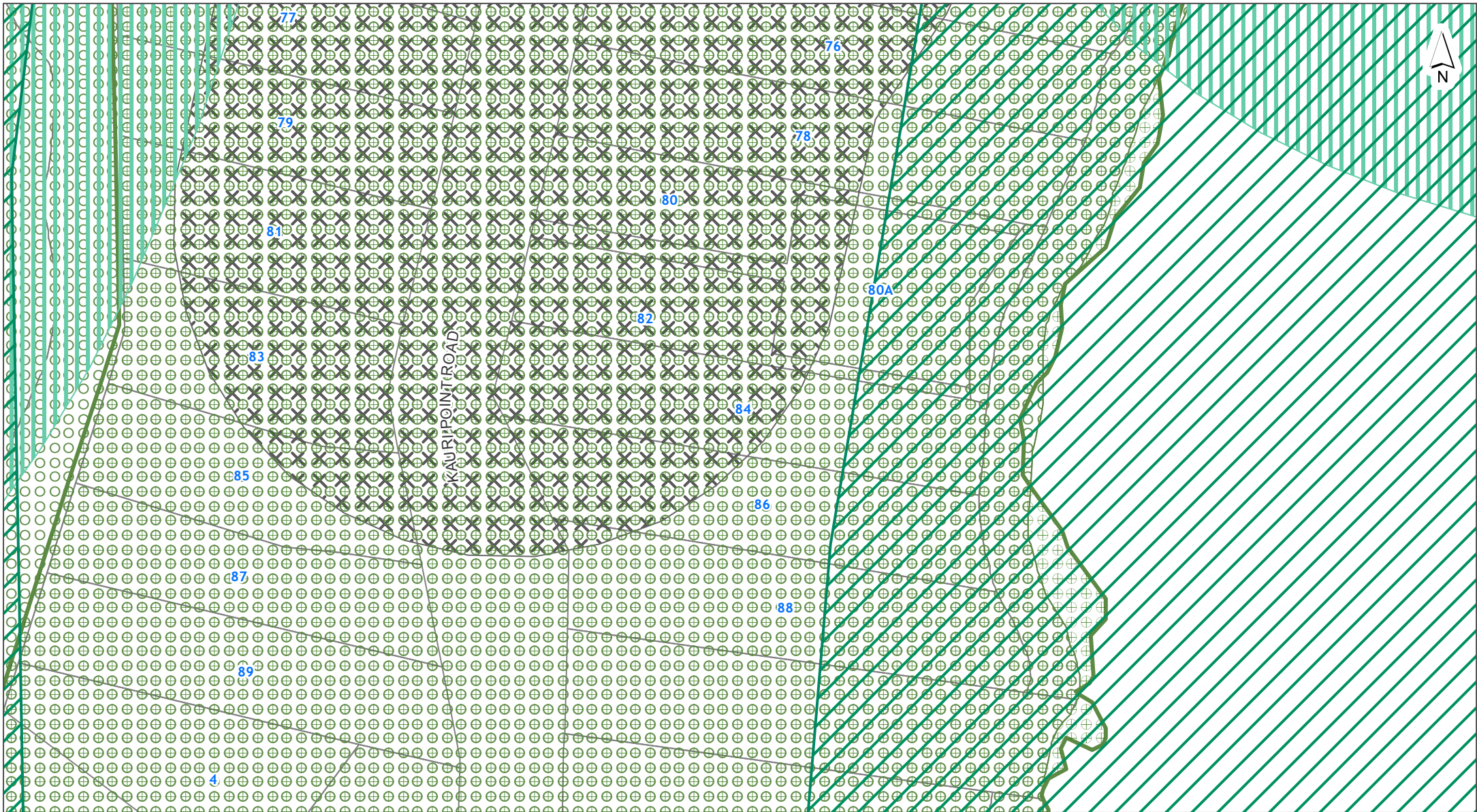

DISCLAIMER:
This map/plan is illustrative only and all information should be independently verified on site before taking any action. Copyright Auckland Council. Land Parcel Boundary information from LINZ (Crown Copyright Reserved). Whilst due care has been taken, Auckland Council gives no warranty as to the accuracy and plan completeness of any information on this map/plan and accepts no liability for any error, omission or use of the information. Height datum: Auckland 1946.

Natural Heritage
84 Kauri Point Road Laingholm
LOT 384 DP 17523



Scale @ A4
= 1:1,000

Date Printed:
5/03/2019



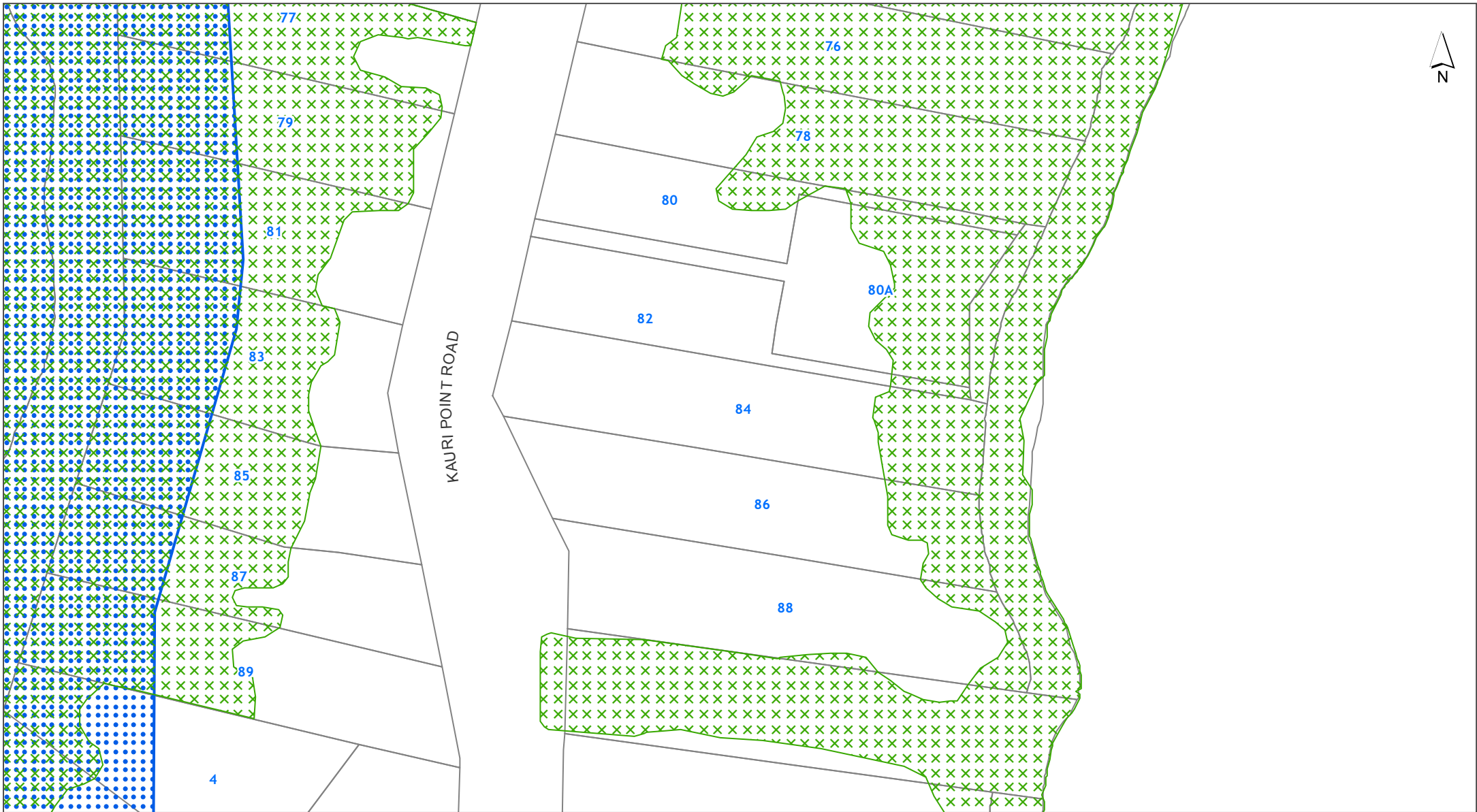

DISCLAIMER:
This map/plan is illustrative only and all information should be independently verified on site before taking any action. Copyright Auckland Council. Land Parcel Boundary information from LINZ (Crown Copyright Reserved). Whilst due care has been taken, Auckland Council gives no warranty as to the accuracy and plan completeness of any information on this map/plan and accepts no liability for any error, omission or use of the information. Height datum: Auckland 1946.

Natural Resources
84 Kauri Point Road Laingholm
LOT 384 DP 17523

0 7 14 21
Meters
Scale @ A4
= 1:1,000
Date Printed:
5/03/2019





DISCLAIMER:
 This map/plan is illustrative only and all information should be independently verified on site before taking any action.
 Copyright Auckland Council. Land Parcel Boundary information from LINZ (Crown Copyright Reserved). Whilst due care has been taken, Auckland Council gives no warranty as to the accuracy and plan completeness of any information on this map/plan and accepts no liability for any error, omission or use of the information. Height datum: Auckland 1946.

Precincts
 84 Kauri Point Road Laingholm
 LOT 384 DP 17523

0 7 14 21
 Meters
 Scale @ A4
 = 1:1,000
 Date Printed:
 5/03/2019



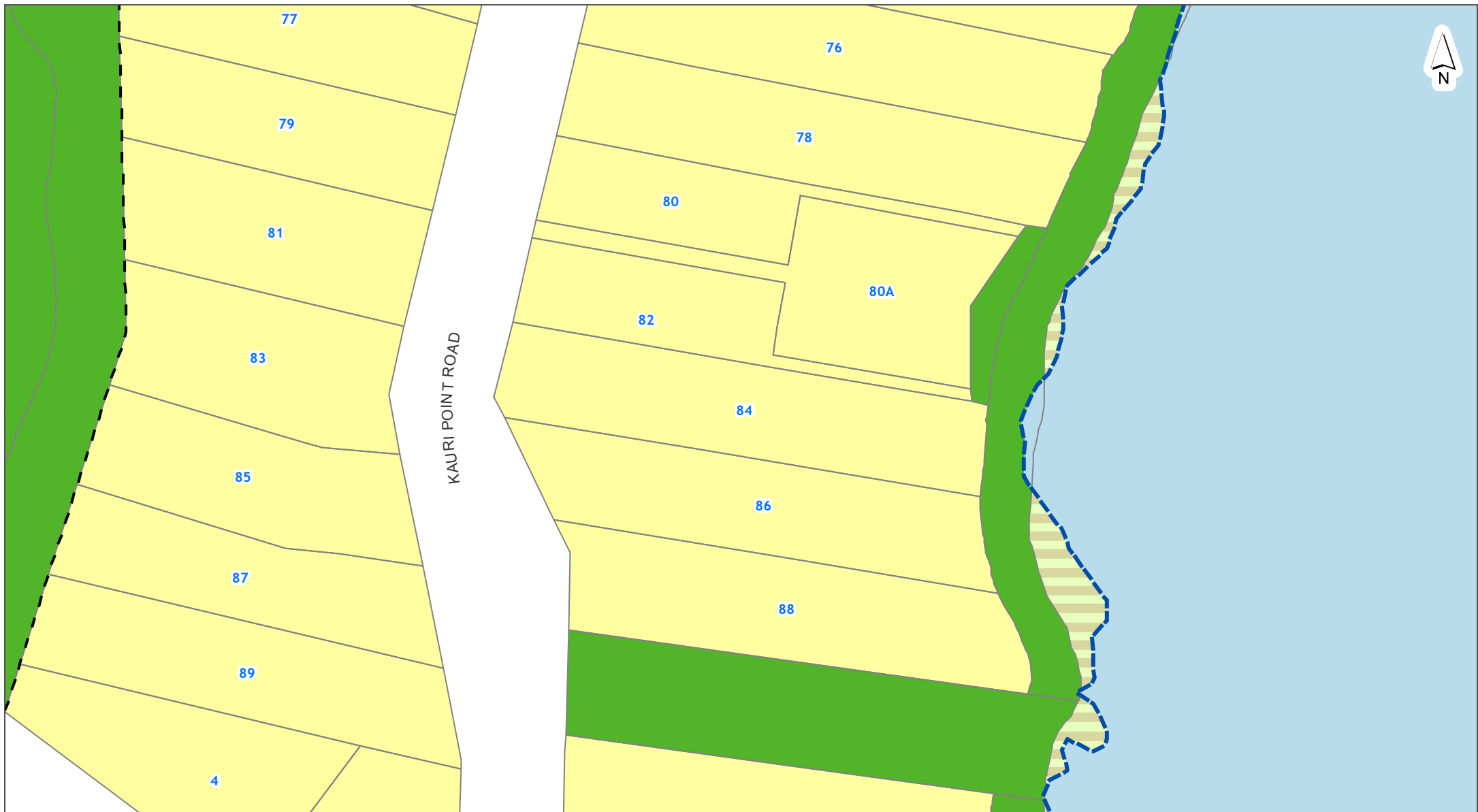

DISCLAIMER:
This map/plan is illustrative only and all information should be independently verified on site before taking any action. Copyright Auckland Council. Land Parcel Boundary information from LINZ (Crown Copyright Reserved). Whilst due care has been taken, Auckland Council gives no warranty as to the accuracy and plan completeness of any information on this map/plan and accepts no liability for any error, omission or use of the information. Height datum: Auckland 1946.

Zones and Rural Urban Boundary

84 Kauri Point Road Laingholm

LOT 384 DP 17523



Scale @ A4
= 1:1,000

Date Printed:
5/03/2019



Auckland Unitary Plan Operative in part 15th November 2016 - LEGEND

Appeals

- Properties affected by Appeals seeking change to zones or management layers
- Properties affected by Appeals seeking reinstatement of management layers

Plan Modifications

- Notice of Requirements
- Plan Changes

ZONES

- Residential - Large Lot Zone
- Residential - Rural and Coastal Settlement Zone
- Residential - Single House Zone
- Residential - Mixed Housing Suburban Zone
- Residential - Mixed Housing Urban Zone
- Residential - Terrace Housing and Apartment Buildings Zone
- Business - City Centre Zone
- Business - Metropolitan Centre Zone
- Business - Town Centre Zone
- Business - Local Centre Zone
- Business - Neighbourhood Centre Zone
- Business - Mixed Use Zone
- Business - General Business Zone
- Business - Business Park Zone
- Business - Heavy Industry Zone
- Business - Light Industry Zone
- Open Space - Conservation Zone
- Open Space - Informal Recreation Zone
- Open Space - Sport and Active Recreation Zone
- Open Space - Civic Spaces Zone
- Open Space - Community Zone

ZONES

- Rural - Rural Production Zone
- Rural - Mixed Rural Zone
- Rural - Rural Coastal Zone
- Rural - Rural Conservation Zone
- Rural - Countryside Living Zone
- Rural - Waitakere Foothills Zone
- Rural - Waitakere Ranges Zone
- Future Urban Zone
- Green Infrastructure Corridor (Operative in some Special Housing Areas)
- Coastal - General Coastal Marine Zone [rcp]
- Coastal - Marina Zone [rcp/dp]
- Coastal - Mooring Zone [rcp]
- Coastal - Minor Port Zone [rcp/dp]
- Coastal - Ferry Terminal Zone [rcp/dp]
- Coastal - Defence Zone [rcp]
- Coastal - Coastal Transition Zone
- Special Purpose Zone- Airports & Airfields, Cemetery, Quarry, Healthcare Facility & Hospital, Tertiary Education, Maori Purpose, Major Recreation Facility, School
- Strategic Transport Corridor Zone
- Water [i]

Tagging of Provisions:

- [i] = Information only
- [rp] = Regional Plan
- [rcp] = Regional Coastal Plan
- [rps] = Regional Policy Statement
- [dp] = District Plan (only noted when dual provisions apply)

DESIGNATIONS

- Designations
- Airspace Restriction Designations

OVERLAYS

- Terrestrial [rp/dp]
- Marine 1 [rcp]
- Marine 2 [rcp]
- Natural
- Urban
- Water Supply Management Areas Overlay [rp]
- Natural Stream Management Areas Overlay [rp]
- High-Use Stream Management Areas Overlay [rp]
- High-Use Aquifer Management Areas Overlay [rp]
- Quality-Sensitive Aquifer Management Areas Overlay [rp]
- Wetland Management Areas Overlay [rp]
- Airport Approach Surface Overlay
- Aircraft Noise Overlay
- City Centre Port Noise Overlay [rcp / dp]
- Quarry Buffer Area Overlay
- National Grid Subdivision Corridor
- National Grid Yard Compromised
- National Grid Yard Uncompromised
- National Grid Substation Corridor
- National Grid Corridor Overlay
- Sites & Places of Significance to Mana Whenua Overlay [rcp/dp]

Natural Resources

- Significant Ecological Areas Overlay
- Lake Management Areas Overlay (Natural Lake and Urban Lake)

Infrastructure

Mana Whenua

CONTROLS

- Key Retail Frontage
- General Commercial Frontage
- Adjacent to Level Crossings
- General
- Motorway Interchange Control
- Coastal Inundation 1 per cent AEP Plus 1m Control
- Business Park Zone Office Control
- Cable Protection Areas Control [rcp]
- Centre Fringe Office Control
- Height Variation Control
- Arterial Roads

Building Frontage Control

Vehicle Access Restriction Control

OVERLAYS

- Precincts
- Indicative Coastline [i]
- Rural Urban Boundary
- Notable Trees Overlay
- Outstanding Natural Features Overlay [rcp/dp]
- Outstanding Natural Landscapes Overlay [rcp/dp]
- Outstanding Natural Character Overlay [rcp/dp]
- High Natural Character Overlay [rcp/dp]
- Local Public Views Overlay [rcp/dp]
- Viewshafts
- Height Sensitive Areas
- Regionally Significant Volcanic Viewshafts & Height Sensitive Areas Overlay [rcp/dp]
- Regionally Significant Volcanic Viewshafts Overlay Contours [i]
- Locally Significant Volcanic Viewshafts Overlay [rcp/dp]
- Locally Significant Volcanic Viewshafts Overlay Contours [i]
- Extent of Overlay
- Subdivision Schedule
- Waitakere Ranges Heritage Area Overlay
- Modified
- Natural
- Ridgeline Protection Overlay
- Historic Heritage Overlay Place [rcp/dp]
- Historic Heritage Overlay Extent of Place [rcp/dp]
- Special Character Areas Overlay Residential and Business
- Auckland War Memorial Museum Viewshaft Overlay [rcp/dp]
- Auckland War Memorial Museum Viewshaft Overlay Contours [rcp/dp]

Natural Heritage

Historic Heritage & Special Character

CONTROLS

- Hazardous Facilities
- Infrastructure
- Flow 1 [rp]
- Flow 2 [rp]
- Level Crossings With Sightlines Control
- Macroinvertebrate Community Index
- Parking Variation Control
- Subdivision Variation Control
- Surf Breaks [rcp]
- Identified Growth Corridor Overlay
- Emergency Management Area Control
- Stormwater Management Area Control

Built Environment

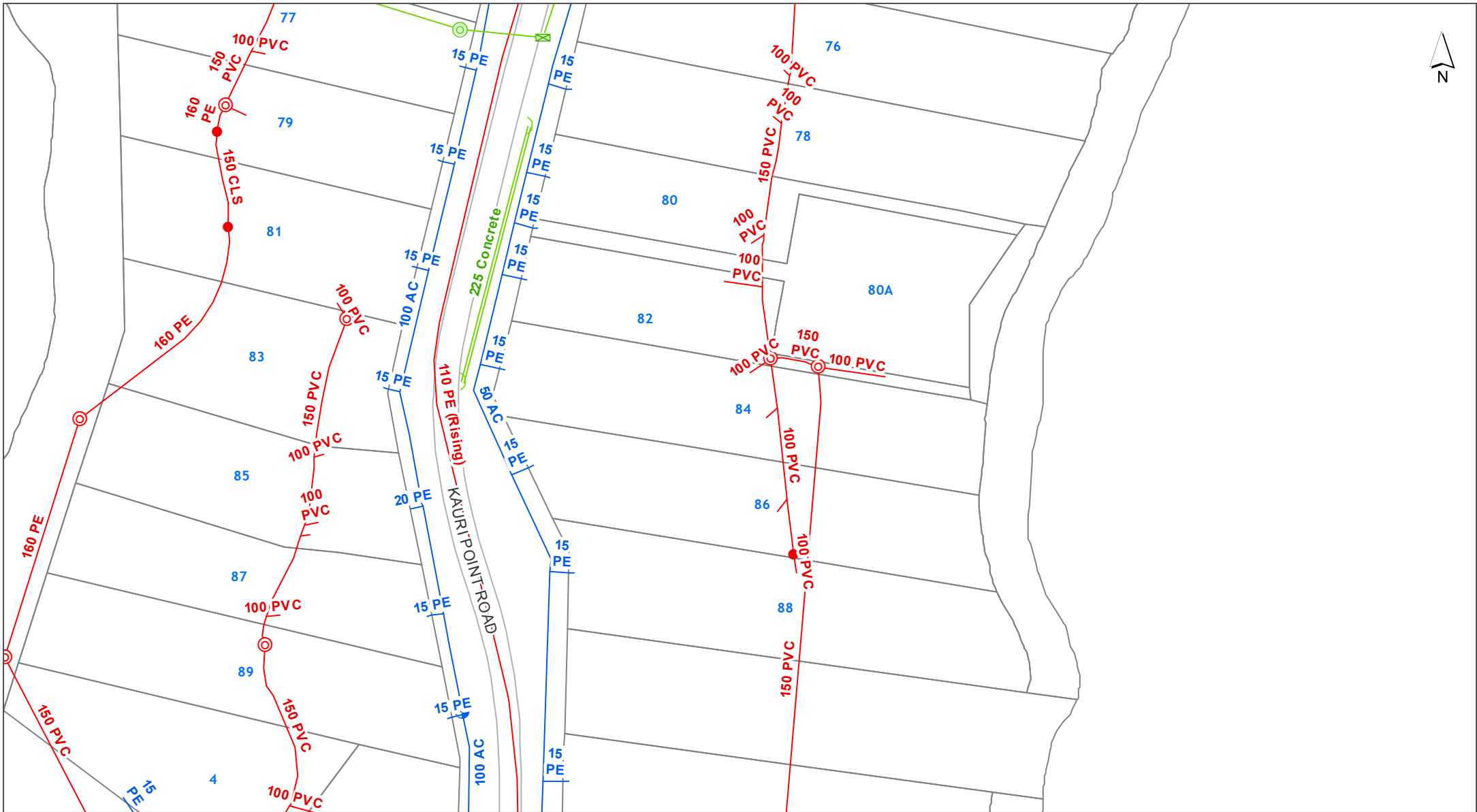

DISCLAIMER:
 This map/plan is illustrative only and all information should be independently verified on site before taking any action.
 Copyright Auckland Council. Land Parcel Boundary information from LINZ (Crown Copyright Reserved). Whilst due care has been taken, Auckland Council gives no warranty as to the accuracy and plan completeness of any information on this map/plan and accepts no liability for any error, omission or use of the information. Height datum: Auckland 1946.

Underground Services
84 Kauri Point Road Laingholm
LOT 384 DP 17523



Scale @ A4
 = 1:1,000

Date Printed:
 5/03/2019



Stormwater

Note: Unless otherwise specified in the text below, the *colour* of a Stormwater symbol is determined by the ownership or usage status, using the following colour scheme:

Public, **Private** or **Abandoned**

- | | | | |
|--|-------------------------------|--|---|
| | Treatment Device | | Overland Flowpath (Public) |
| | Septic Tank | | Overland Flowpath (Private) |
| | Septic Tank (Hi-Tech) | | Forebay (Public) |
| | Soakage System | | Forebay (Private) |
| | Inspection Chamber | | Treatment Facility (Public) |
| | Manhole (Standard / Custom) | | Treatment Facility (Private) |
| | Inlet & Outlet Structure | | Pump Station |
| | Inlet & Outlet (No Structure) | | Planting |
| | Catchpit | | Embankment |
| | Spillway | | Viewing Platform |
| | Safety Benching | | Bridge |
| | Culvert / Tunnel | | Erosion & Flood Control (Other Structure) |
| | Subsoil Drain | | Erosion & Flood Control (Wall Structure) |
| | Gravity Main | | |
| | Rising Main | | |
| | Connection | | |
| | Fence | | |
| | Lined Channel | | |
| | Watercourse | | |

Water

- | | |
|--|--------------------------------------|
| | Valve |
| | Hydrant |
| | Fitting |
| | Other Watercare Point Asset |
| | Other Watercare Linear Asset |
| | Local Pipe (Bulk) |
| | Local Pipe (In Service) |
| | Local Pipe (Abandoned) |
| | Transmission Pipe (In Service) |
| | Transmission Pipe (Out of Service) |
| | Transmission Pipe (Proposed) |
| | Pump Station |
| | Reservoir |
| | Other Structure (Local) |
| | Chamber (Transmission) |
| | Water Source (Transmission) |
| | Other Watercare Structures and Areas |

Wastewater

- | | |
|--|------------------------------------|
| | Fitting |
| | Fitting (Non Watercare) |
| | Manhole |
| | Pipe (Non Watercare) |
| | Local Pipe (Main / Service Line) |
| | Local Pipe (Abandoned) |
| | Local Pipe (Future) |
| | Transmission Pipe (In Service) |
| | Transmission Pipe (Out Of Service) |
| | Transmission Pipe (Proposed) |
| | Chamber |
| | Structure (Non Watercare) |
| | Pump Station |
| | Wastewater Catchment |

Utilities

- | | |
|--|---|
| | Transpower Site |
| | Pylon (Transpower) |
| | 220kv Line (Transpower) |
| | 110kv Line (Transpower) |
| | 33kv Line (Transpower) & Underground Line (Mercury) |
| | Transmission Line (Vector) |
| | Oil Services Pipeline [Wiri] |
| | Liquid Fuels Pipeline [Wiri to Marsden] |
| | High-Pressure Gas Pipeline (Vector & Orion) |
| | Medium-Pressure Gas Pipeline (Vector & Orion) |
| | Indicative Steel Mill Slurry Pipeline |
| | Indicative Steel Mill Water Pipeline |
| | Fibre Optic Cable (ARTA) |
| | Contour Interval |

Legend updated: 9/05/2018



DISCLAIMER:
This map/plan is illustrative only and all information should be independently verified on site before taking any action. Copyright Auckland Council. Land Parcel Boundary information from LINZ (Crown Copyright Reserved). Whilst due care has been taken, Auckland Council gives no warranty as to the accuracy and plan completeness of any information on this map/plan and accepts no liability for any error, omission or use of the information. Height datum: Auckland 1946.

Hazards
84 Kauri Point Road Laingholm
LOT 384 DP 17523

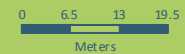

Scale @ A4
= 1:1,000

Date Printed:
5/03/2019

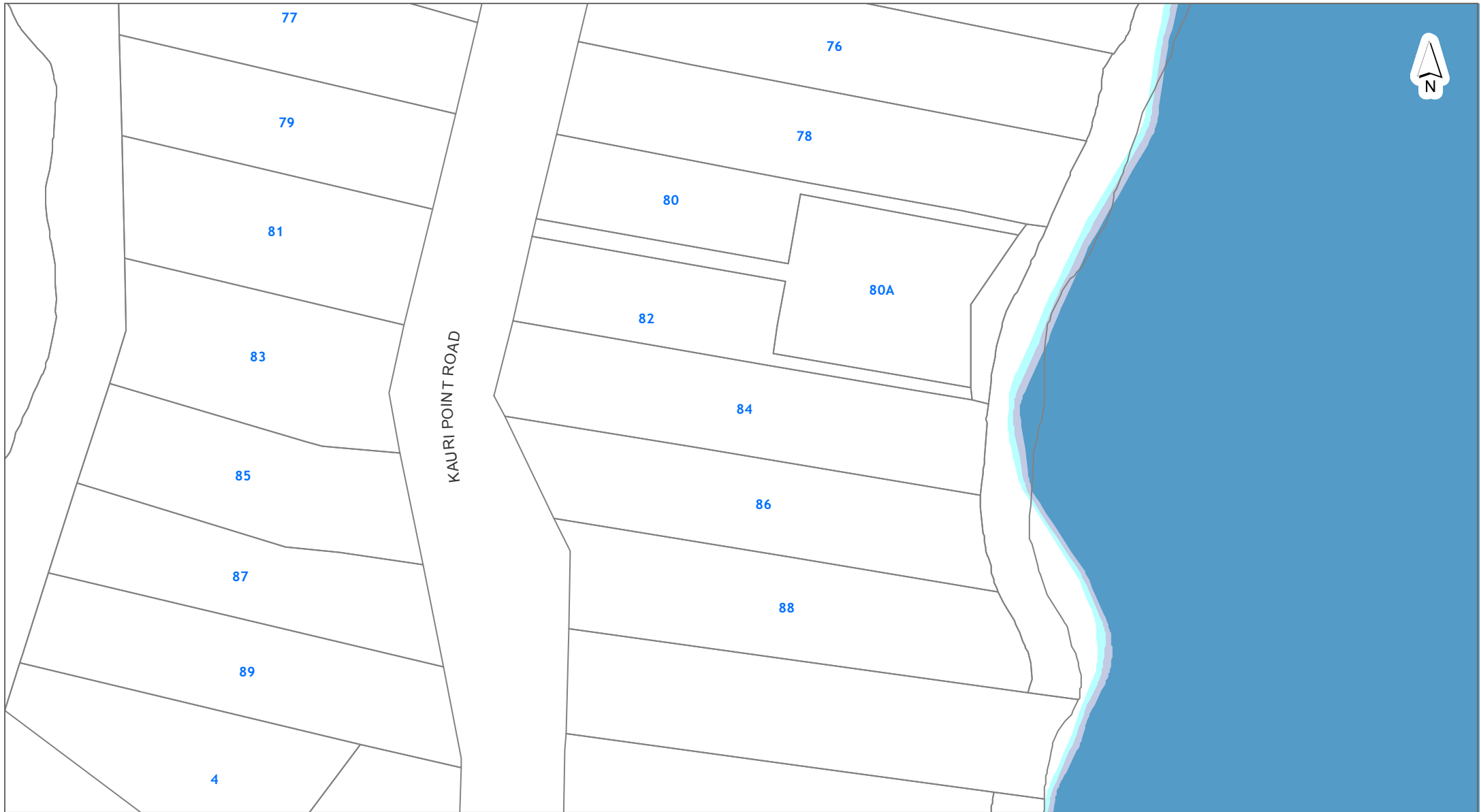

DISCLAIMER:
This map/plan is illustrative only and all information should be independently verified on site before taking any action. Copyright Auckland Council. Land Parcel Boundary information from LINZ (Crown Copyright Reserved). Whilst due care has been taken, Auckland Council gives no warranty as to the accuracy and plan completeness of any information on this map/plan and accepts no liability for any error, omission or use of the information. Height datum: Auckland 1946.

Natural Hazards - Coastal Inundation

84 Kauri Point Road Laingholm

LOT 384 DP 17523

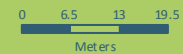

Scale @ A4
= 1:1,000

Date Printed:
5/03/2019



DISCLAIMER:
This map/plan is illustrative only and all information should be independently verified on site before taking any action.
Copyright Auckland Council. Land Parcel Boundary information from LINZ (Crown Copyright Reserved). Whilst due care has been taken, Auckland Council gives no warranty as to the accuracy and plan completeness of any information on this map/plan and accepts no liability for any error, omission or use of the information. Height datum: Auckland 1946.

Natural Hazards - Flooding
84 Kauri Point Road Laingholm
LOT 384 DP 17523

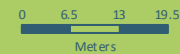

Scale @ A4
= 1:1,000

Date Printed:
5/03/2019

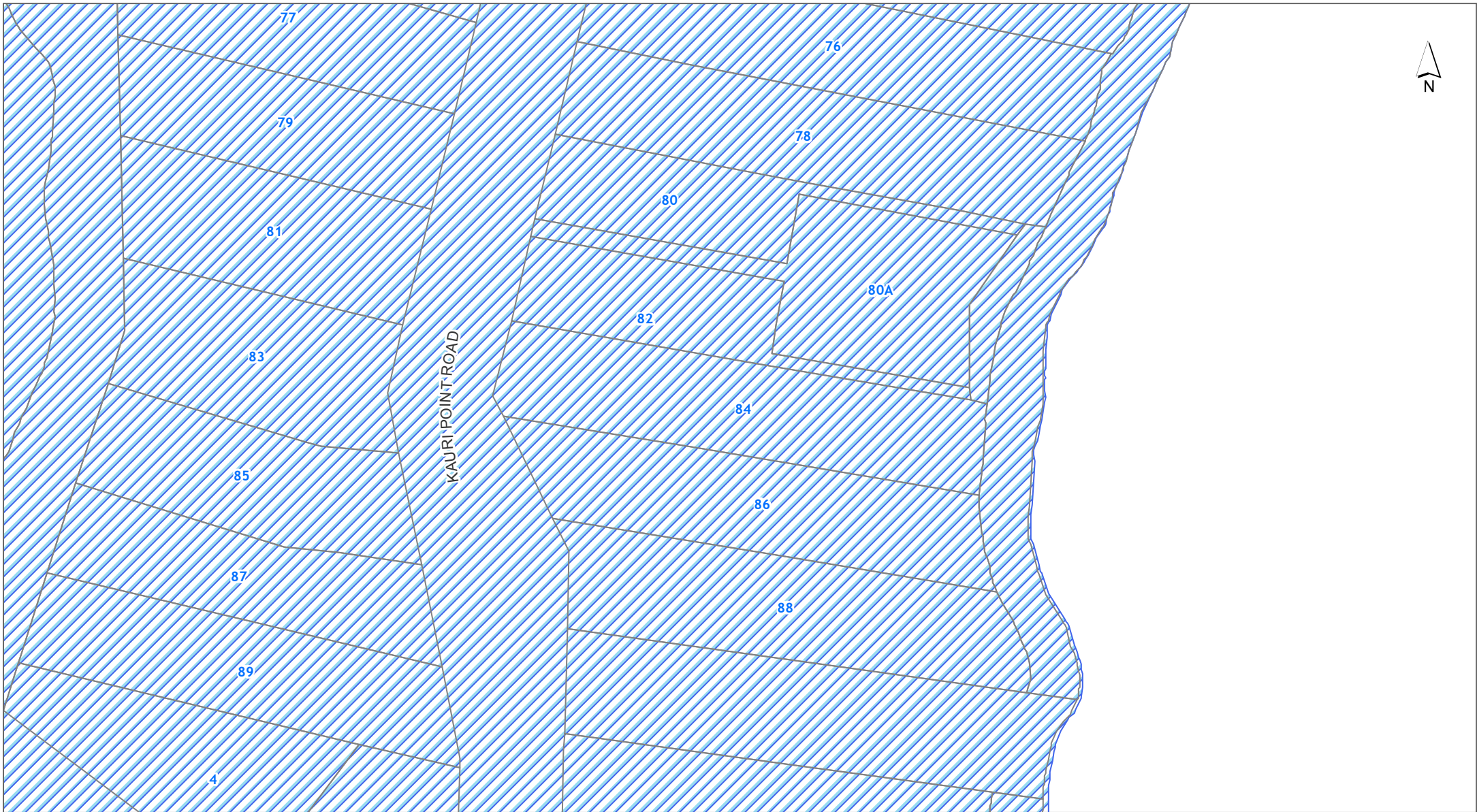

DISCLAIMER:
This map/plan is illustrative only and all information should be independently verified on site before taking any action. Copyright Auckland Council. Land Parcel Boundary information from LINZ (Crown Copyright Reserved). Whilst due care has been taken, Auckland Council gives no warranty as to the accuracy and plan completeness of any information on this map/plan and accepts no liability for any error, omission or use of the information. Height datum: Auckland 1946.

Natural Hazards - Sea Spray

84 Kauri Point Road Laingholm

LOT 384 DP 17523

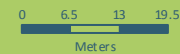

Scale @ A4
= 1:1,000

Date Printed:
5/03/2019



DISCLAIMER:
This map/plan is illustrative only and all information should be independently verified on site before taking any action. Copyright Auckland Council. Land Parcel Boundary information from LINZ (Crown Copyright Reserved). Whilst due care has been taken, Auckland Council gives no warranty as to the accuracy and plan completeness of any information on this map/plan and accepts no liability for any error, omission or use of the information. Height datum: Auckland 1946.

Natural Hazards - Volcanic Cones

84 Kauri Point Road Laingholm

LOT 384 DP 17523

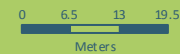

Scale @ A4
= 1:1,000

Date Printed:
5/03/2019



DISCLAIMER:
This map/plan is illustrative only and all information should be independently verified on site before taking any action. Copyright Auckland Council. Land Parcel Boundary information from LINZ (Crown Copyright Reserved). Whilst due care has been taken, Auckland Council gives no warranty as to the accuracy and plan completeness of any information on this map/plan and accepts no liability for any error, omission or use of the information. Height datum: Auckland 1946.

Other
84 Kauri Point Road Laingholm
LOT 384 DP 17523

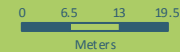

Scale @ A4
= 1:1,000

Date Printed:
5/03/2019















Hazards

Soil Warning Area

-  Fill (Franklin District only)
-  Advisory (Franklin District only)
-  Contamination (Franklin District only)
-  Erosion (Franklin District only)
-  Hazardous Activities & Industries List (HAIL) (Franklin District only)
-  Inundation (Franklin District only)
-  Rainfall Event (Franklin District only)
-  Slippage (Franklin District only)
-  Subsidence (Franklin District only)
-  Slippage / Subsidence / Erosion etc (Auckland City and Papakura District only)
-  Uncertified Fill (Auckland City and Papakura District only)
-  Organic Soil (Auckland City and Papakura District only)
-  Filled / Weak Ground (Auckland City and Papakura District only)
-  Refuse Tips Site / Weak Area (Auckland City and Papakura District only)
-  Unstable / Suspected Ground (Auckland City and Papakura District only)
-  Allochthon Waitemata (Rodney District only)
-  Motatau Complex (Rodney District only)
-  Puriri Mudstone (Rodney District only)
-  Mahurangi Limestone (Rodney District only)
-  Mangakahia Complex (Rodney District only)
-  Hukerenui Mudstone (Rodney District only)
-  Whangai Formation (Rodney District only)
-  Tangihua Complex (Rodney District only)
-  within 150m of Northland Allochthon (Rodney District only)



Hazards

Soil Warning Area continued



-  Soil D (Rodney District only)
-  within 150m of Soil D (Rodney District only)
-  Soil C (Rodney District only)
-  within 150m of Soil C (Rodney District only)
-  Soil B (Rodney District only)
-  within 150m of Soil B (Rodney District only)
-  Soil A (Rodney District only)
-  Gas Main Pipeline
-  Petroleum Pipeline
-  Closed Landfill (Auckland Council owned)
-  Closed Landfill (Privately owned)
-  Air Discharge (Franklin District only)
-  No Soakage (Franklin District only)
-  Indicative Steel Mill Slurry Line 20m Buffer (Franklin District only)
-  Indicative Steel Mill Water Line 20m Buffer (Franklin District only)





Natural Hazards

Overland Flow Path

-  Catchment area 2000m² to 3999 m²
-  Catchment area 4000 m² to 3 Ha
-  Catchment area 3 Ha and above







Coastal Inundation

-  1% AEP
-  1% AEP plus 1m sea level rise
-  1% AEP plus 2m sea level rise

-  1% AEP Flood Plain
-  Flood Prone Areas
-  Flood Sensitive Areas
-  Sea Spray
-  Volcanic Cones

Other

Cultural Heritage Index

-  Archaeological Site
-  Hayward and Diamond
-  Historic Botanical Site
-  Historic Structure
-  Maori Heritage Area
-  Maritime Site
-  Reported Historic Site

The information Council holds in relation to Special Land Features differs based on the area a property is located in. Those areas where information is held on a Special Land Feature is denoted in the legend above.

Legend updated: 12/06/2018

22 JAN 2001

18.1.01

As built drainage Plan

Consent No ABA 200010017

Owner: Wayne Cantwell, Drainlayer: Tony Farrell

Address 84 Kauri Pt Rd, Langhorne

Lot: 384 DP: 17523

Road

Inspected 15/1/01

John Nicholls

Prop. 51002

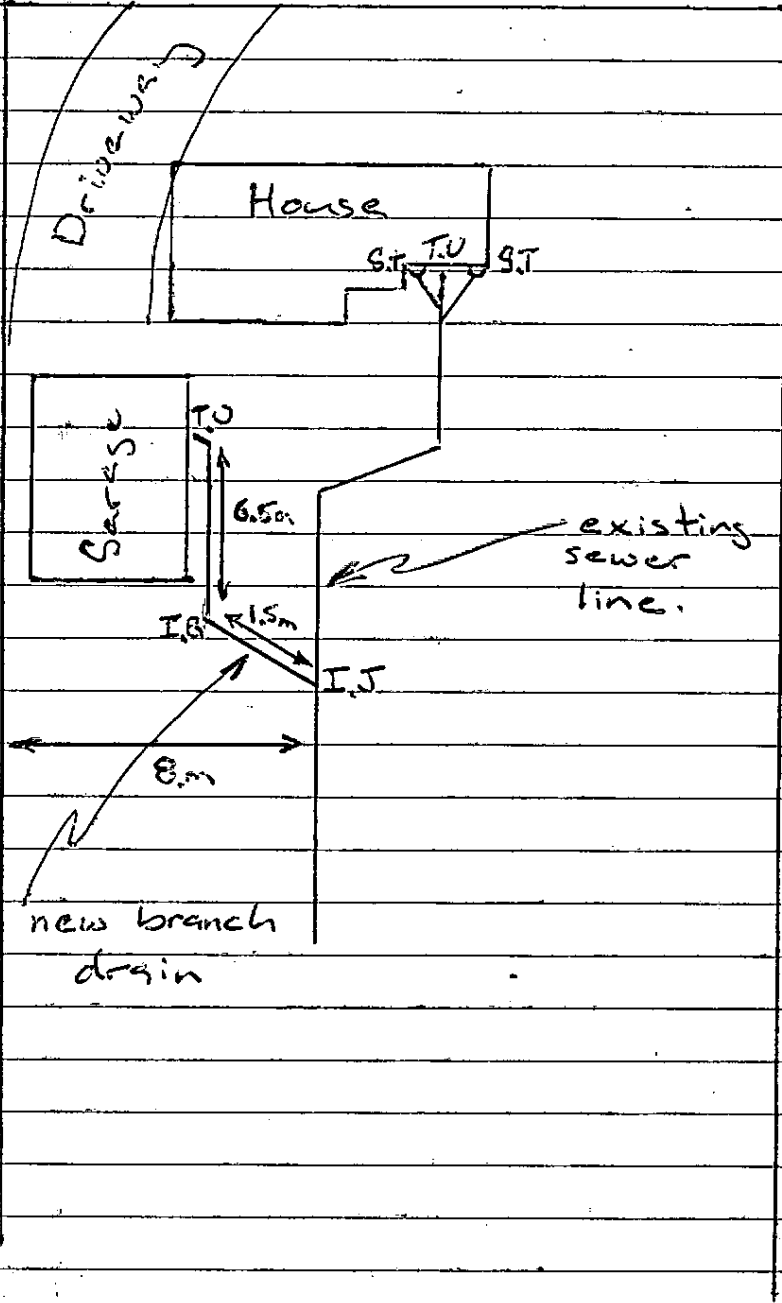

84 Kauri Pt Rd

Attention: John Nicholls

Resources
City Infrastructure
Maori Issues
Consent Sew

GRAPH FOR PLAN—

Where drainage plans are necessary (see page 2) the graph below is to be completed accurately to scale in ink, and must show clearly street boundary, property boundaries, outline of buildings as well as layout of ALL drains & inspection fittings.

Owner's Name: M. MITKIN
Address of Property: 84 Keweenaw Point Road
Lot _____
Drainlayer's Name: D.P. Hopkins

Scale:
Where possible use 1/4" = 1 foot
Otherwise use 1/16" = 1 foot
Please Indicate Scale Used.

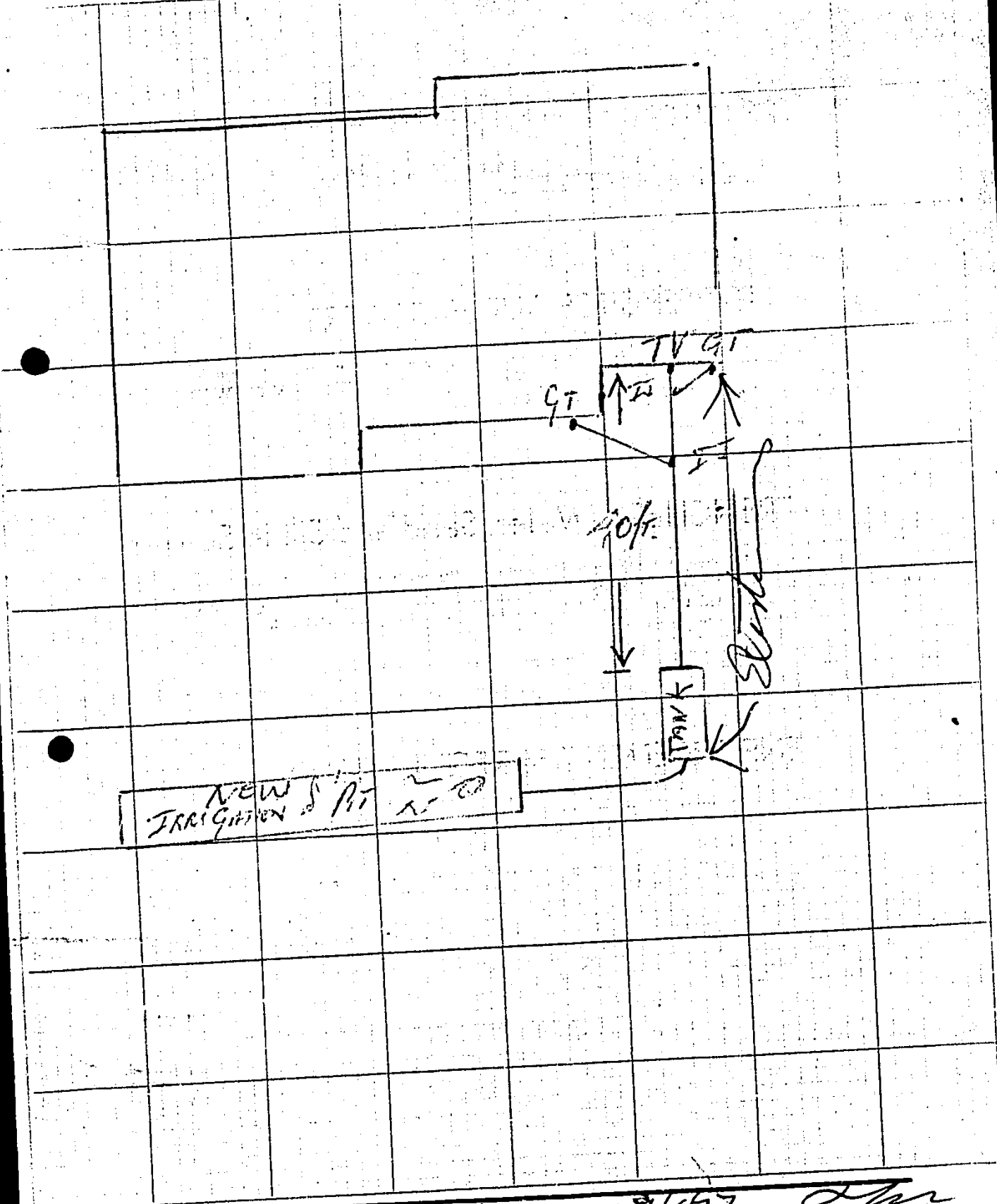

For Office Use Only:—
Drainage Permit No. 46763
Building Permit No. N/A
Remarks: _____

Date inspected 7/6/73 Inspector [Signature]

7(a) *The extent to which the scale of buildings detracts from the natural landscape and neighbourhood character.*

The proposed development would result in a potential infringement of building coverage due to the allowance required for a covered carparking space. However, the applicant has indicated that there is no intention to construct a covered parking space and there would be no changes to the existing buildings on site.

7(b) *The extent to which building coverage creates pressure on existing infrastructure or the receiving ability of the surrounding natural environment from the buildings or the activities to be conducted within them - in particular on water supply, wastewater and stormwater drainage, water tables, proximity to water courses, soils, and road access.*

The potential covered parking space would not have an adverse effect on existing infrastructure. If it were constructed, it would be located in an area that is currently paved. Therefore, there would be no increase in impermeable area on the site.

7(c) *The extent to which more than minor adverse effects can be adequately avoided, remedied, mitigated or offset through provision of works and services on or off the site and/or provision of a financial contribution*

No adverse effects are anticipated as a result of the proposal, therefore, no works and services or financial contribution is considered necessary.

7.0 MONITORING

The proposal will need to be monitored in accordance with the conditions specified in this report, and the requirements contained in the District Plan.

8.0 RECOMMENDED DECISION

Pursuant to Sections 94, 104, 105 and 108 of the Resource Management Act 1991, being satisfied that no body or person is adversely affected, it is recommended that **consent be granted** to the application by Robert Chisholm to convert an existing garage into a minor household unit. (as more accurately defined in Sections 3 and 4 of this report) at 84 Kauri Point Road, Laingholm being Lot 384 DP 17523 for the following reasons:

- (i) No persons are considered potentially affected by the proposal.
- (ii) The proposal has been considered in terms of the relevant assessment criteria, would be consistent with the objectives and policies of the Transitional and Proposed Plans and would create no more than minor adverse effects on the environment.
- (iii) The separation of the minor household unit from the dwelling would not adversely affect the amenity and landscape values of the site, as the structure is existing, no external changes are proposed and the scale of the activity is limited by the small size of the building.

Conditions imposed on the consent are as follows:

- 1. The development is to proceed in accordance with the plans prepared by Nikau Design Studio, being sheets 1-3, entitled "Wayne Cantwell MHU, RMC Application" dated 27/9/00 and all referenced by Council as RMA20002326 and information submitted with the application, subject to any minor alterations as may be approved by the Manager Resource Consents.
- 2. All infrastructure relating to stormwater treatment and disposal, wastewater disposal, and water supply shall be accepted by Eco-Water. Compliance with the Waitakere City Council Code of

Practice for City Infrastructure and Land Development is deemed to be in accordance with the above condition.

3. All reticulated services, including power and telephone, shall be provided underground.
4. A consent compliance monitoring fee of \$90.00 (inclusive of G.S.T.) shall be paid to the Council. This fee is to recover the actual and reasonable costs incurred ensuring compliance with the conditions of this consent. If, on inspection all conditions have not been satisfactorily met, a reinspection shall be required at a further cost of \$90.00 (inclusive of G.S.T).

The \$90.00 fee shall be paid as part of the resource consent and the resource consent holder shall be advised of any further monitoring fees if they are required.

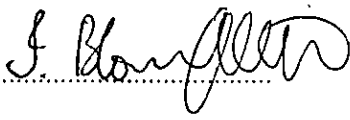
Reporting Planner: 
(Ingrid Blomfield)

Date: 12/12/00

9.0 CONSENT GRANTED AS RECOMMENDED

Lee Ogilvie/Carolyn McAlley
Team Leader Consents

Date: 12/12/2000

Please contact Ingrid Blomfield (Ph 836 8000 ext. 8352) if you have any queries about this resource consent and associated report.