



**RECORD OF TITLE
UNDER LAND TRANSFER ACT 2017
FREEHOLD
Search Copy**



R. W. Muir
R. W. Muir
Registrar-General
of Land

Identifier **186002**
Land Registration District **North Auckland**
Date Issued 02 March 2005

STATEMENT OF PASSING OVER INFORMATION:

This information has been supplied to us by a third party. Accordingly, the Vendor and Astar Realty Limited are merely passing over this information as supplied to us by others. While we have passed on this information supplied by a third party, we have not checked, audited, or reviewed the records or documents and therefore to the maximum extent permitted by law neither the Vendor nor Astar Realty Limited or any of its' salespersons or employees accept any responsibility for the accuracy of the materials. Intending purchasers are advised to conduct their own investigation.

Prior References
NA83C/145

Estate Fee Simple
Area 3177 square metres more or less
Legal Description Lot 2 Deposited Plan 345378

Registered Owners
Joanne Cain Davidson and Jonathan Bruce Davidson

Interests

C337756.6 Encumbrance to Waitakere City Council - 9.1.1992 at 9:09 am
Land Covenant in Transfer C365520.2 - 15.4.1992 at 1:32 pm
Appurtenant hereto is a right of way created by Transfer C403500.6
Appurtenant hereto are water, electric power and telecommunications rights created by Transfer C403500.7
11037083.3 Mortgage to ASB Bank Limited - 26.2.2018 at 3:46 pm

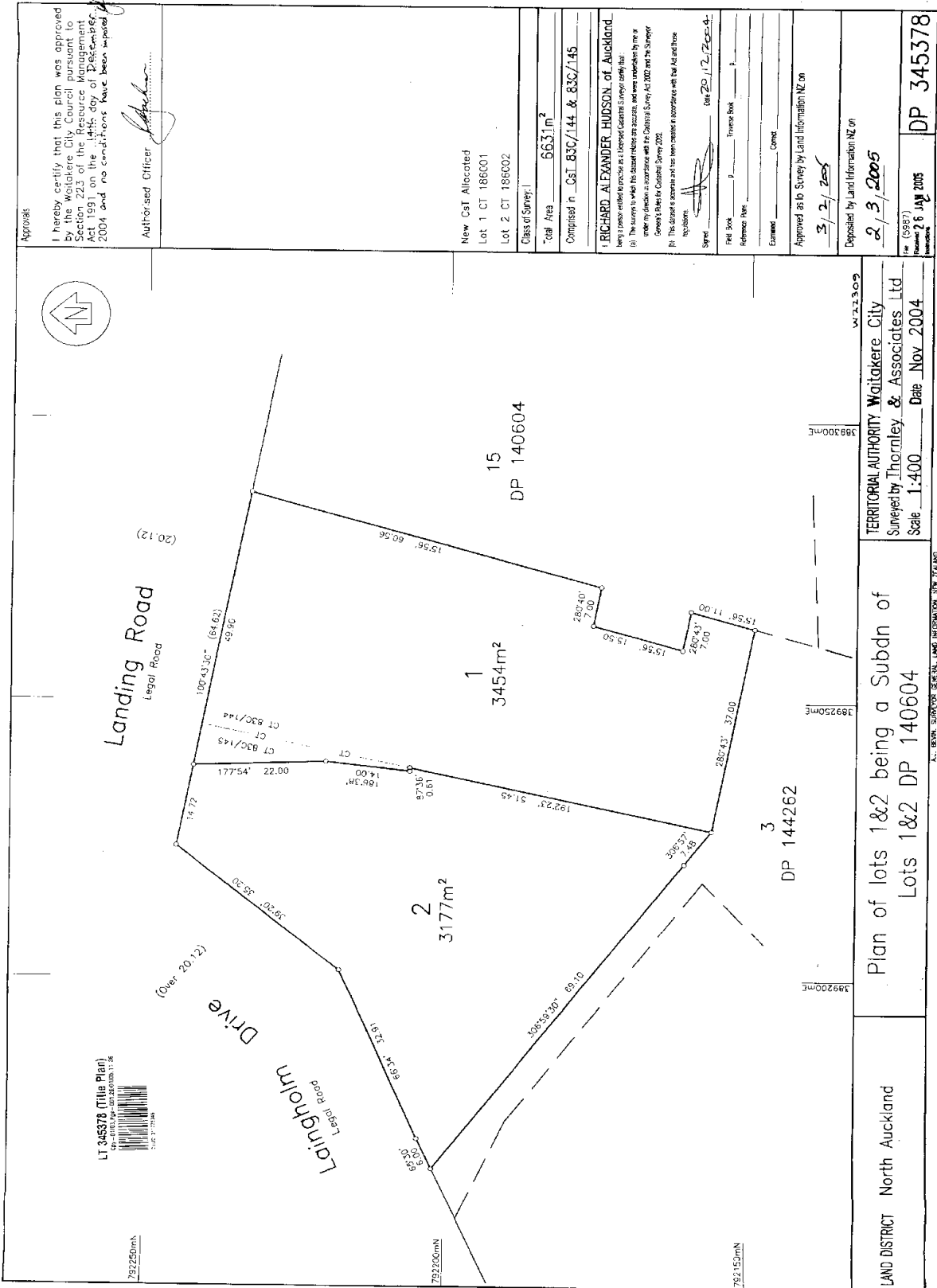

Approval:

I hereby certify that this plan was approved by the Waitakere City Council pursuant to Section 223 of the Resource Management Act 1991 on the 11th day of December 2004 and no conditions have been imposed.

Authorised Officer: *[Signature]*

New Cst Allocated
 Lot 1 CT 186001
 Lot 2 CT 186002
 Class of Survey: I
 Total Area 6631m²
 Comprised in Cst 830/144 & 830/145

RICHARD ALEXANDER HUDSON, of Auckland.
 Being a Licensed Surveyor and Licensed Customs Surveyor.
 (a) The Survey is made in accordance with the provisions of the Survey Act 1908 and the Survey Regulations.
 (b) The Survey is made in accordance with the provisions of the Survey Act 1908 and the Survey Regulations.
 (c) The Survey is made in accordance with the provisions of the Survey Act 1908 and the Survey Regulations.

Scale: 1:400
 Date: 20/11/2004
 Reference: None
 Examined: _____
 Approved as to Survey by Land Information NZ on 3/2/2005
 Deposited by Land Information NZ on 2/3/2005

LAND DISTRICT North Auckland
 Plan of lots 1&2 being a Subdn of Lots 1&2 DP 140604
 TERRITORIAL AUTHORITY Waitakere City
 Surveyed by Thornley & Associates Ltd
 Scale 1:400 Date Nov 2004
 DP 345378
 26 JAN 2005
 (5987)
 REGISTERED PLAN 345378