

**NOTE: THIS IS A LIVE DOCUMENT THAT CHANGES, PLEASE ENSURE YOU DOWNLOAD THE MOST UP TO DATE VERSION PRIOR TO MAKE AN OFFER OR ATTENDING AN AUCTION.**

**INTEREST: DURING MARKETING CAMPAIGNS DATES AND TIMEFRAMES SOMETIMES CHANGE. IF YOU HAVE NOT MADE US AWARE THAT YOU ARE INTERESTED IN PURSUING THE PROPERTY, WE WILL NOT BE ABLE TO INFORM YOU OF ANY CHANGES AND YOU MAY LOOSE OUT.**

25 June 2021

**Re: 27 Danube Lane, Glen Eden**

Thank you for your interest in the above property currently listed with us for sale by [method].

We have made available to you the following:

- Certificate of Title
- LIM
- Rates information from Auckland Council
- School Zones
- Safe and Sanitary - deck
- Property File from Auckland Council
- REA Code of Conduct
- REA Guide to Selling and Buying
- Conditions of sale

27 Danube Lane, Glen Eden is 407m<sup>2</sup> more or less fee simple estate NA81B/272 Lot 3 Deposited Plan 137124 and 1/3 share 117m<sup>2</sup> more or less fee simple estate Lot 21 Deposited Plan 137124.  
Zoning: Residential: Single House Zone

**THINGS WE WANT TO DRAW YOUR ATTENTION TO:**

**Land Information Memorandum (LIM)**

<b>Site Contamination</b>	A study undertaken by the Auckland District Health Board and legacy Auckland Regional Council in 2001 identified that this site may have previously been used for horticultural purposes. Auckland Council does not currently have information confirming whether this site is contaminated as a result of any previous horticultural use. However, due to the potential for contamination, the Council may require a preliminary site investigation and/or detailed site investigation be carried out by a suitably qualified and experienced
---------------------------	--

	practitioner, and provided to the council for review. Resource consent from Auckland Council may also be required prior to any soil disturbance (including sampling soil), redevelopment, subdivision, or change of use of the site.
<b>Wind Zones</b> for this property	Medium wind speed of 37 m/s
<b>Planning</b>	LUC-1997-70021 Land Use Consent Erect a Deck - Granted 18/09/1996 LUC-1998-900 Land Use Consent Boundaries - Granted 28/04/1998
<b>Building</b>	BPM-1990-7374 Dwelling – Issued 31/12/1990 ABA-1996-3113 Site Building and Erect Deck - CCC Not Issued 17/09/1996 <i>(Consent approved but a final Code Compliance Certificate (CCC) for this consent has not been issued. To obtain a CCC an inspection to confirm compliance with the approved plans and standards may be sought.)</i>

**Settlement Date on Offer:** 30 July 2021

#### Disclosures

- The current owners were advised of possible ground rain water issues after they bought in 2018. They investigated and discovered the gutters were blocked from surrounding trees. Neighbouring trees were trimmed and Gutter Guard was installed around back of the house. They have had no issues in their time of ownership. There is no evidence of any previous issues.
- A building consent was issued for a deck in 1996 off the living area but once complete a final inspection and code compliance was not obtained. A Safe and Sanitary has been provided dated June 2021.

We recommend that when purchasing a property, you seek legal advice.

This information has been supplied to us by a third party. Accordingly, the Vendor and Austar Realty Limited are merely passing over this information as supplied to us by others. While we have passed on this information supplied by a third party, we have not checked, audited, or reviewed records or documents and therefore to the maximum extent permitted by law neither the Vendor nor Austar Realty Limited or any of its' salespersons or employees accept any responsibility for the accuracy of the materials. Intending purchasers are advised to conduct their own investigation

Regards

Gaston Coma & Bronwyn Scott-Woods



The ProAgent Team

**P R E M I E R**  
MEMBER 19 - 20

Gaston Coma  
021 234 3788 | [gaston.coma@raywhite.com](mailto:gaston.coma@raywhite.com)

Bronwyn Scott-Woods  
021 613 632 | [bronwyn.scott-woods@raywhite.com](mailto:bronwyn.scott-woods@raywhite.com)

Austar Realty Ltd Licensed (REAA 2008) | 423 Titirangi Road, Titirangi 0604

The PRO AGENT.CO.NZ Team

STATEMENT OF PASSING OVER INFORMATION:

This information has been supplied to us by a third party. Accordingly, the Vendor and Austar Realty Limited are merely passing over this information as supplied to us by others. While we have passed on this information supplied by a third party, we have not checked, audited, or reviewed the records or documents and therefore to the maximum extent permitted by law neither the Vendor nor Austar Realty Limited or any of its' salespersons or employees accept any responsibility for the accuracy of the materials. Intending purchasers are advised to conduct their own investigation.

Austar Realty Ltd  
PO Box 69139  
Glendene  
AUCKLAND 0645



---

<b>Applicant</b>	Austar Realty Ltd
<b>LIM address</b>	27 Danube Lane Glen Eden
<b>Application number</b>	8270320796
<b>Customer Reference</b>	
<b>Date issued</b>	10-Jun-2021
<b>Legal Description</b>	LOT 21 DP 137124, LOT 3 DP 137124
<b>Certificates of title</b>	NA81B/272

---

### Disclaimer

This Land Information Memorandum (LIM) has been prepared for the applicant for the purpose of section 44A of the Local Government Official Information and Meetings Act 1987.

The LIM includes information which:

- Must be included pursuant to section 44A of the Local Government Official Information and Meetings Act 1987
- Council at its discretion considers should be included because it relates to land
- Is considered to be relevant and reliable

This LIM does not include other information:

- Held by council that is not required to be included
- Relating to the land which is unknown to the council
- Held by other organisations which also hold land information

Council has not carried out an inspection of the land and/or buildings for the purpose of preparing this LIM. Council records may not show illegal or unauthorised building or works on the land.

The applicant is solely responsible for ensuring that the land or any building on the land is suitable for a particular purpose and for sourcing other information held by the council or other bodies. In addition, the applicant should check the Certificate of Title as it might also contain obligations relating to the land.

The text and attachments of this document should be considered together.

This Land Information Memorandum is valid as at the date of issue only.

## s44A(2)(a) Information identifying any special feature or characteristics of the land

This information should not be regarded as a full analysis of the site features of this land, as there may be features that the Council is unaware of. The applicant is solely responsible for ensuring that the land is suitable for a particular purpose including development.

### Site Contamination

A study undertaken by the Auckland District Health Board and legacy Auckland Regional Council in 2001 identified that this site may have previously been used for horticultural purposes. Auckland Council does not currently have information confirming whether this site is contaminated as a result of any previous horticultural use. However, due to the potential for contamination, the Council may require a preliminary site investigation and/or detailed site investigation be carried out by a suitably qualified and experienced practitioner, and provided to the council for review. Resource consent from Auckland Council may also be required prior to any soil disturbance (including sampling soil), redevelopment, subdivision, or change of use of the site.

### Wind Zones

Wind Zone(s) for this property: Medium wind speed of 37 m/s

The wind zones are based on wind speed data specific to all building sites as outlined in NZS 3604:2011. Other factors such as topographic classes, site exposure and ground roughness determine the actual wind bracing demands and bracing elements required for the building.

For further information refer to NZS 3604:2011 Section 5 — Bracing Design

### Soil Issues

The Auckland Council is not aware of any soil issues in relation to this land. If any soil information/reports have been prepared in relation to this property, they will be available for viewing at an Auckland Council Service Centre or via the property file product services.

### Flooding

This statement entitled "Flooding" appears on all LIMs.

Known flooding information is displayed on the map attached to this LIM entitled "Special Land Features – Natural Hazards - Flooding".

The information shown in the "Special Land Features - Natural Hazards - Flooding" map is also shown on the Auckland Council online map viewer (Geomaps), at [www.aucklandcouncil.govt.nz](http://www.aucklandcouncil.govt.nz), which is updated from time to time.

Any proposed development may require a flooding assessment to be provided by the applicant.

The absence of flooding on the "Special Land Features - Natural Hazards - Flooding" map does not exclude the possibility of the site flooding, particularly from Overland Flow Paths which may be on other properties.

### Exposure Zones

New Zealand Standard 3604:2011E classifies all properties in New Zealand into zones based on

environmental features including wind, earthquake, snow load and exposure. These zones are relevant to building requirements, such as strength of buildings, materials that should be used and maintenance. All building sites are classified as being in Exposure Zones Extreme Sea Spray, B, C, or D, depending on the severity of exposure to wind driven salt.

This property is classified as: Unknown or Unassessed Corrosion Zone

Unknown or unassessed - No known information is available relating to these sites. Recommended that specific sites and/or product designed and to consult suppliers information for specific durability requirements.

**s44A(2)(b) Information on private and public stormwater and sewerage drains**

Information on private and public stormwater and sewerage drains is shown on the **underground services map** attached.

Note: Private drainage is the responsibility of the land owner up to and including the point of connection to the public sewer or drain.

**s44(2)(ba) Information notified to Council by a drinking water supplier under Section 69ZH of the Health Act 1956**

Prospective purchasers should be aware of other drinking water systems connected to this property. There may also be private drinking water supply systems such as rainwater tanks or private water bores. You are advised to clarify the drinking water supply with the current landowner.

No Information has been notified to Council.

**s44A(2)(bb) Information Council holds regarding drinking water supply to the land**

For metered water information, please contact **Watercare (09) 442 2222** for services provided to this property.

**s44A(2)(c) Information relating to any rates owing in relation to the land**

<b>Billing Number/ Rate Account:</b>	12341504617
<b>Rates levied for the Year 2020/2021 :</b>	\$1,794.58
<b>Total rates to clear for the current year (including any arrears and postponed rates):</b>	\$150.82

The rates figures are provided as at 8 a.m. 10/06/2021. It is strongly advised these are not used for settlement purposes.

---

**Retrofit Your Home Programme**

---

The Retrofit Your Home programme provides financial assistance, advice and information to householders wanting to create an improved home environment. The scheme contributes to the achievement of the Air Quality National Environmental Standards encouraging the installation of clean heat and insulation in homes as well as supporting access to central

government grants and subsidies. The programme offers homeowners a retrofit plan for their homes and financial assistance up to \$5000 repaid through a targeted rate.

 Auckland Council (09) 890 7898 if you require further information

 retrofit@aucklandcouncil.govt.nz

**s44A(2)(d) Consents, Certificates, Notices, Orders or Requisitions affecting the land or any buildings on the land(da) the information required to be provided to a territorial authority under section 362T(2) of the Building Act 2004:s44A and (2)(e) Information concerning any Certificate issued by a Building Certifier pursuant to the Building Act 1991 or the Building Act 2004**

Note: if the land is part of a cross lease title or unit title, consents and permits for the other flats or units may be included in this LIM. If the land has been subdivided there may be consents and permits included that relate to the original property.

It is recommended that the full property file is viewed and compared with the actual building and activities on the land to identify any illegal or unauthorised building works or activities.

### **Financial / development contributions**

---

Financial and development contributions are relevant for recently subdivided land, vacant lots, new residential unit(s) or where there is further development of a site. If any financial or development contribution has not been paid, Council can recover outstanding amount(s) from a subsequent owner of the land.

Please note that financial contributions and development contributions may be paid in land, cash or a combination of these. The form of payment of contributions may be subject to negotiation but final discretion remains with the Council.

### **Resource Management**

---

#### **Planning**

27 Danube Lane Glen Eden

<b>Application No.</b>	<b>Description</b>	<b>Decision</b>	<b>Decision Date</b>
LUC-1997-70021	Land Use Consent Erect a Deck	Granted	18/09/1996
LUC-1998-900	Land Use Consent Boundaries	Granted	28/04/1998

#### **Subdivisions**

There are **NO** Subdivision resource consents recorded.

#### **Engineering Approvals**

There are **NO** Engineering approvals recorded.

If there are any conditions, then only that portion of the consent will be included in the attachments section. The applicant should satisfy themselves as to whether all conditions of resource consents for this property have been met.

## Further Information

The Council may hold additional information for this property, for example concerning resource consents for discharges to air, land or water issued by the former Auckland Regional Council prior to 1 November 2010. If you would like Auckland Council to search for this type of information, please contact us.

## Building

27 Danube Lane Glen Eden

Application No.	Description	Issue Date	Status
BPM-1990-7374	Dwelling	31/12/1990	Issued (See Note 1)
ABA-1996-3113	Site Building and Erect Deck	17/09/1996	CCC Not Issued (See Note 3)

Note	Description
1	Permit issued prior to the Building Act 1991 taking effect. Code Compliance Certificates (CCC) were not required.
3	Consent approved but a final Code Compliance Certificate (CCC) for this consent has not been issued. To obtain a CCC an inspection to confirm compliance with the approved plans and standards may be sought.

Please note that prior to the Building Act 1991; Councils were not required to maintain full records of building consents [etc] issued under the Building Act. While Auckland Council has always endeavoured to maintain full records of pre-Building Act 1991 matters, not all records for this period have survived and in other cases where building work is documented, information may be incomplete. Council does not accept responsibility for any omission.

It is recommended that the Council property file is viewed and compared with the actual building and activities on site to identify any illegal or unauthorised building works or activities.

## Compliance Schedules (Building Warrant of Fitness)

The Council has no record of a Compliance Schedule for this property/building.

If it is evident that any specified systems such as lifts or commercial fire alarms are present in the building, the owner must ensure there is a current compliance schedule or building warrant of fitness.

## Swimming/Spa Pool Barriers

The Council has no record of a swimming pool or spa pool being registered on this property. Swimming pools and spa pools must have a barrier that complies with the Building Act 2004.

Pool barrier information is available for viewing at <http://www.aucklandcouncil.govt.nz>

## Licences

---

There are NO current licences recorded

### s44A(2)(ea) Information notified under Section 124 of the Weathertight Homes Resolution Services Act 2006

The Council has not been notified of any information under Section 124 of the Weathertight Homes Resolution Services Act 2006 relating to this property.

### s44A (2)(f) Information relating to the use to which the land may be put and any conditions attached to that use

Purchasers or those intending to develop the land should satisfy themselves that the land is suitable for any intended use or future development proposal. In addition to any site specific limitations recorded below, general restrictions that apply across the region may be relevant to any development proposals on this property.

#### **Auckland Unitary Plan - Operative in Part (AUP:OP)**

The **Auckland Unitary Plan - Operative in part(AUP:OP)** applies to this property and should be carefully reviewed and considered, as it may have implications for how this property can be developed and/or used. Those parts of the Auckland Unitary Plan that are operative replace the corresponding parts of legacy regional and district plans. However, certain parts of the AUP:OP are the subject of appeals and have not become operative. If a property is subject to an appeal this will be identified on the attached Unitary Plan Property Summary Report. Where this is the case, both the Auckland Unitary Plan Decisions version and the legacy regional and district plans will need to be considered.

The AUP:OP zones, controls, overlays, precincts, and designations that apply to this property are set out in the Property Summary Report, which is attached to this memorandum.

The AUP:OP can be viewed here:

<https://www.aucklandcouncil.govt.nz/unitaryplan>

The legacy regional and district plans can be viewed here:

<https://www.aucklandcouncil.govt.nz/districtplans>

<https://www.aucklandcouncil.govt.nz/regionalplans>

The appeals to the AUP:OP can be viewed here:

<https://www.aucklandcouncil.govt.nz/unitaryplanappeals>

#### **Auckland Council District Plan - Hauraki Gulf Islands Section (Operative 2013) (DP:HGI)**

While the regional provisions in the AUP:OP apply to the Hauraki Gulf Islands, and are set out in the Property Summary Report attached to this memorandum, the AUP:OP does not contain any district provisions for the Hauraki Gulf Islands. If the Property Summary Report attached to this memorandum lists its zone as "Hauraki Gulf Islands", the district provisions that apply are in the Auckland Council District Plan Hauraki Gulf Islands Section (Operative 2013) (**DP:HGI**).

The relevant maps of the DP:HGI are attached to this memorandum, if applicable. The text of the DP:HGI can be found here:

<https://www.aucklandcouncil.govt.nz/haurakigulfislands>



---

## **Plan Changes and Notices of Requirement**

Changes to the AUP:OP and DP:HGI may be proposed from time to time. These proposed plan changes may relate to either the maps or the text of those plans. Any proposed changes to the AUP:OP relevant to this property will be listed as a modification in the Property Summary Report attached to this memorandum. However, proposed changes to the DP:HGI will not appear on the Property Summary report. That information can be found on the Auckland Council website.

Please refer to the AUP:OP for information on any proposed Plan Changes or see the Auckland Council modifications website at:

<https://www.aucklandcouncil.govt.nz/unitaryplanmodifications>

Information relating to any proposed Plan Changes to DP:HGI can be found here:

<https://www.aucklandcouncil.govt.nz/aurakigulfislands>

From time to time a requiring authority, such as a Ministry of the Crown or a council controlled organisation, may notify Auckland Council that they require certain land to be designated for a certain purpose. If this property is the subject of such a notice of requirement, that notice may have implications for how this property can be developed or used from the date it is received by Council.

If this property is not on the Hauraki Gulf Islands, any notices of requirement applicable will be listed as a modification in the Property Summary Report attached to this memorandum.

If this property is on the Hauraki Gulf Islands, any notice of requirement will be available on the Auckland Council Website.

Information on all current notices of requirement can be found on the modifications page here:

<https://www.aucklandcouncil.govt.nz/unitaryplanmodifications>

Copies of the appeals to the Auckland Unitary Plan can be viewed online at:

<https://www.aucklandcouncil.govt.nz/unitaryplanappeals>

## **Auckland Unitary Plan**

Please note that the Auckland Unitary Plan (Operative in part) applies to this property. The Unitary Plan should be carefully reviewed and considered, as it may have implications for how this property can be developed or used. Parts of the Unitary Plan that are relevant to this property relating to zones, overlays, controls, designations and other restrictions are identified in the Property Summary Report attached to this LIM.

The Unitary Plan can be accessed at Council service centres and libraries and can be found on the following internet page:

<http://www.aucklandcouncil.govt.nz/EN/planspoliciesprojects/plansstrategies/unitaryplan/Pages/home.aspx>

## **Information concerning Caveat, Bond, Encumbrance, Consent Notice and Covenant**

---

For any information concerning Caveats, Bonds, Encumbrances, Consent Notices or Covenants, please refer to the Certificate of Title for this property.

**s44A(2)(g) Information regarding the land which has been notified to Council by another statutory organisation**

No information has been notified to Council.

**s44A(2)(h) Information regarding the land which has been notified to Council by any network utility operator pursuant to the Building Act 1991 or Building Act 2004**

Underground Services and District Plan maps are attached.

Please note: Height restrictions apply where overhead power lines cross the site. Works near water services utilities may require approval. Works near high-pressure Gas, Oil or LPG pipelines create risk of damage and must first be approved. Please contact the relevant Utility provider in your area for further information.

Any escape of gas or liquid from the pipelines is potentially dangerous and requires immediate action as soon as discovered (Dial 111 and ask for the Fire Service).

**s44A(3) Other information relevant to the land**

**Coastal Erosion**

Council has information on coastal erosion, which identifies areas of the Auckland coastline potentially susceptible to coastal instability and erosion within the next century. Coastal erosion is the wearing away of land due to coastal processes such as waves and currents.

Digital maps showing the areas of coastline that may be affected by coastal erosion over the next 100 years are available on the council's mapping platform GeoMaps from 31 May 2021. Geomaps can be accessed online. These digital maps will be included in Land Information Memorandums applied for from later in 2021.

The digital maps are based on the data in Technical Report 2020/21: Predicting Auckland's Exposure to Coastal Instability and Erosion, available by searching the Council website.

## Attachments

As the placement of the building/s on the attached maps is based on aerial photography we cannot guarantee the accuracy. A formal survey will indicate the exact location of the boundaries.

---

- Auckland Unitary Plan Property Summary Report
- Auckland Unitary Plan - Operative in part Maps and Map Legend
- Auckland Council District Plan - Hauraki Gulf Islands Section (if applicable)
- Underground Services & Utilities Map and Map Legend
- Special Land Features Map and Map Legend

Please note Map Legends have been created for use across the region and may contain features which were not captured by the previous legacy Councils; therefore the information may not be available for these maps. Please contact the Resource Management Planning Team in your area for further information on any features which may or may not appear on your map.

- Consent Conditions : LUC-1997-70021

## Auckland Unitary Plan Operative in part (15th November 2016) Property Summary Report

### Address

27 Danube Lane Glen Eden

### Legal Description

LOT 3 DP 137124

### Appeals

### Modifications

### Zones

Residential - Single House Zone

### Precinct

### Controls

Controls: Macroinvertebrate Community Index - Urban

### Overlays

### Designations

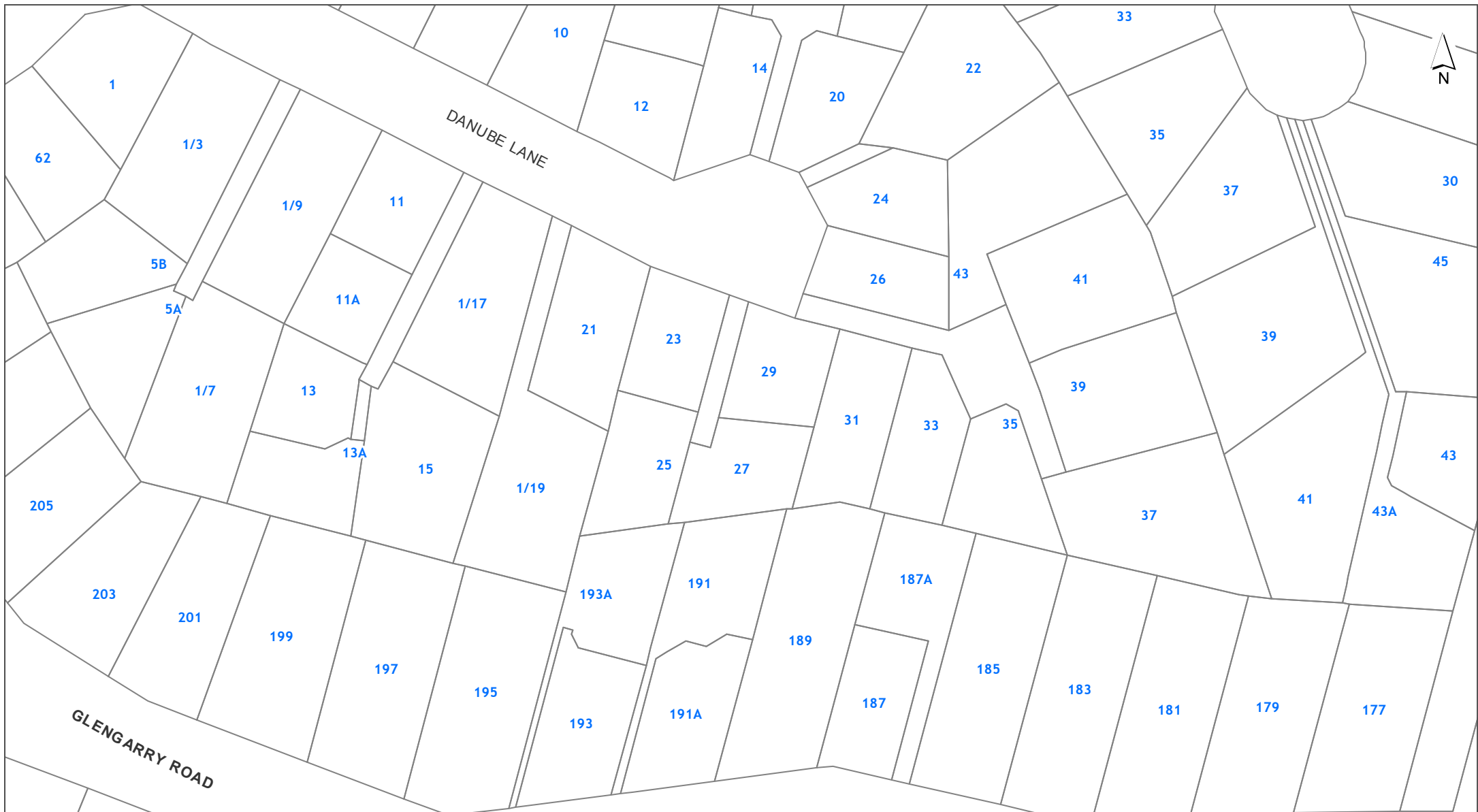

**DISCLAIMER:**  
 This map/plan is illustrative only and all information should be independently verified on site before taking any action. Copyright Auckland Council. Land Parcel Boundary information from LINZ (Crown Copyright Reserved). Whilst due care has been taken, Auckland Council gives no warranty as to the accuracy and plan completeness of any information on this map/plan and accepts no liability for any error, omission or use of the information. Height datum: Auckland 1946.

**Built Environment**  
**27 Danube Lane Glen Eden**  
**LOT 3 DP 137124**

0 7 14 21  
 Meters  
 Scale @ A4  
 = 1:1,000  
 Date Printed:  
 10/06/2021





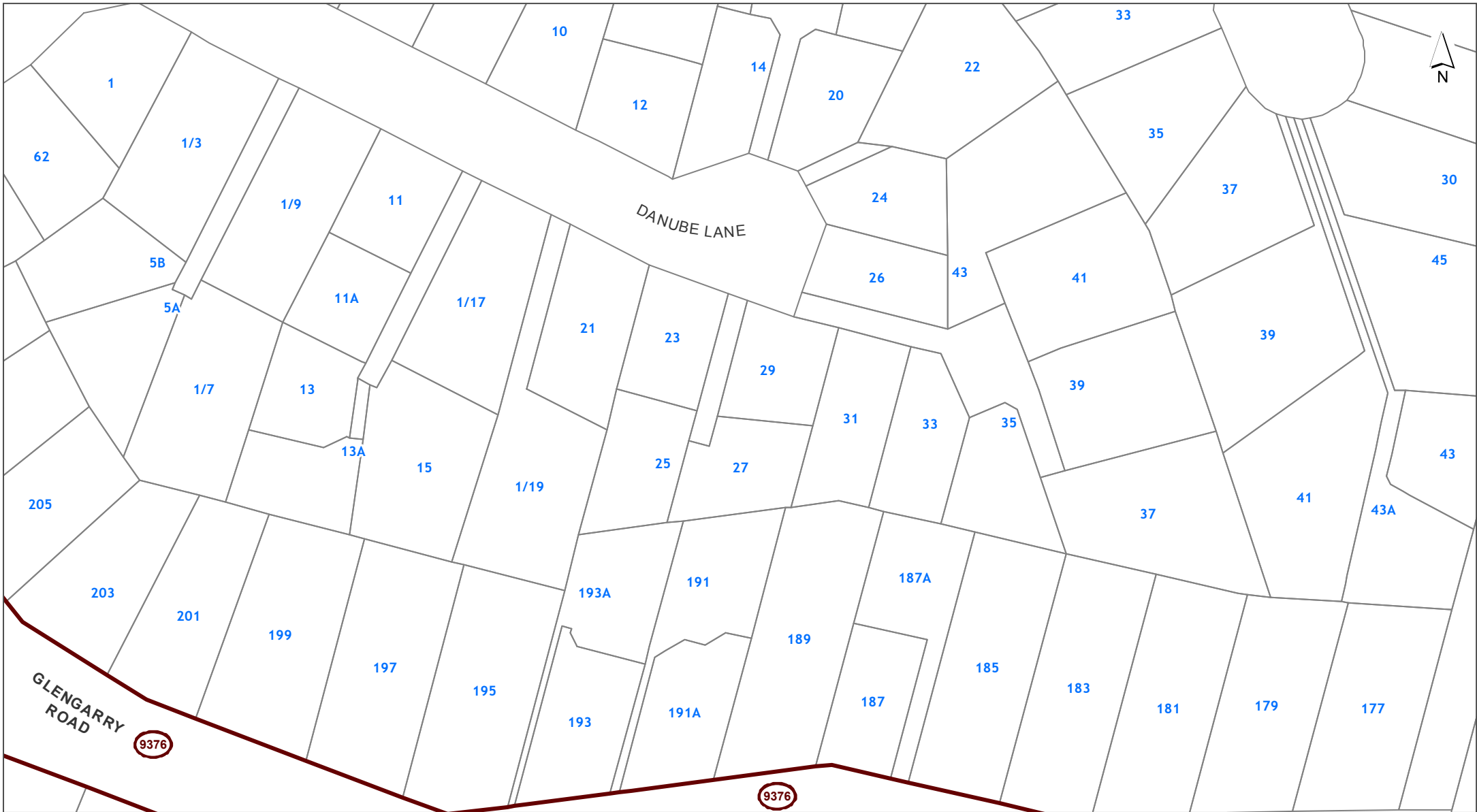

DISCLAIMER:  
This map/plan is illustrative only and all information should be independently verified on site before taking any action.  
Copyright Auckland Council. Land Parcel Boundary information from LINZ (Crown Copyright Reserved). Whilst due care has been taken, Auckland Council gives no warranty as to the accuracy and plan completeness of any information on this map/plan and accepts no liability for any error, omission or use of the information. Height datum: Auckland 1946.

**Designations**  
**27 Danube Lane Glen Eden**  
**LOT 3 DP 137124**

0 7 14 21  
Meters  
Scale @ A4  
= 1:1,000  
Date Printed:  
10/06/2021



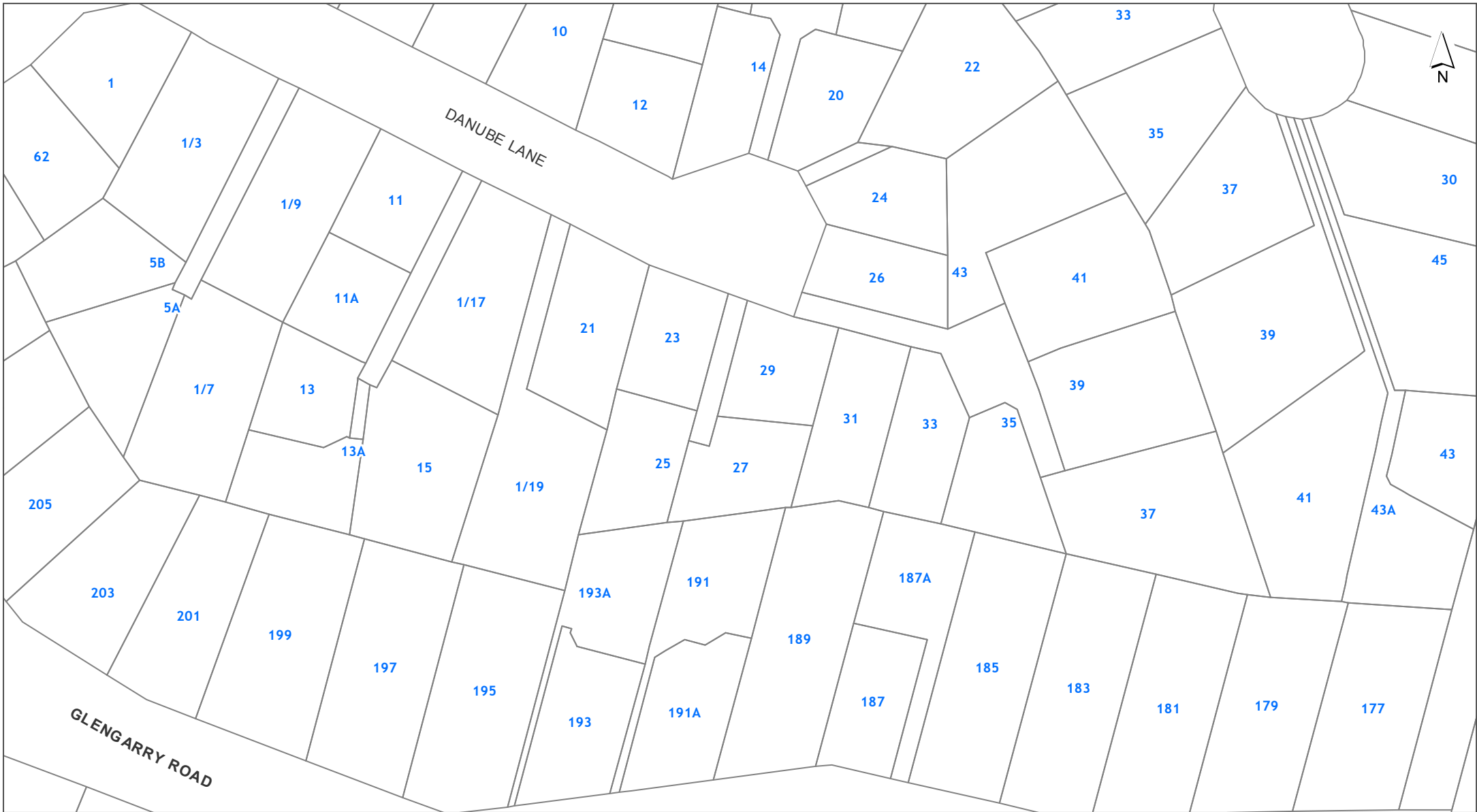

DISCLAIMER:  
This map/plan is illustrative only and all information should be independently verified on site before taking any action.  
Copyright Auckland Council. Land Parcel Boundary information from LINZ (Crown Copyright Reserved). Whilst due care has been taken, Auckland Council gives no warranty as to the accuracy and plan completeness of any information on this map/plan and accepts no liability for any error, omission or use of the information. Height datum: Auckland 1946.

Historic Heritage and Special Character

27 Danube Lane Glen Eden

LOT 3 DP 137124



Scale @ A4  
= 1:1,000

Date Printed:  
10/06/2021







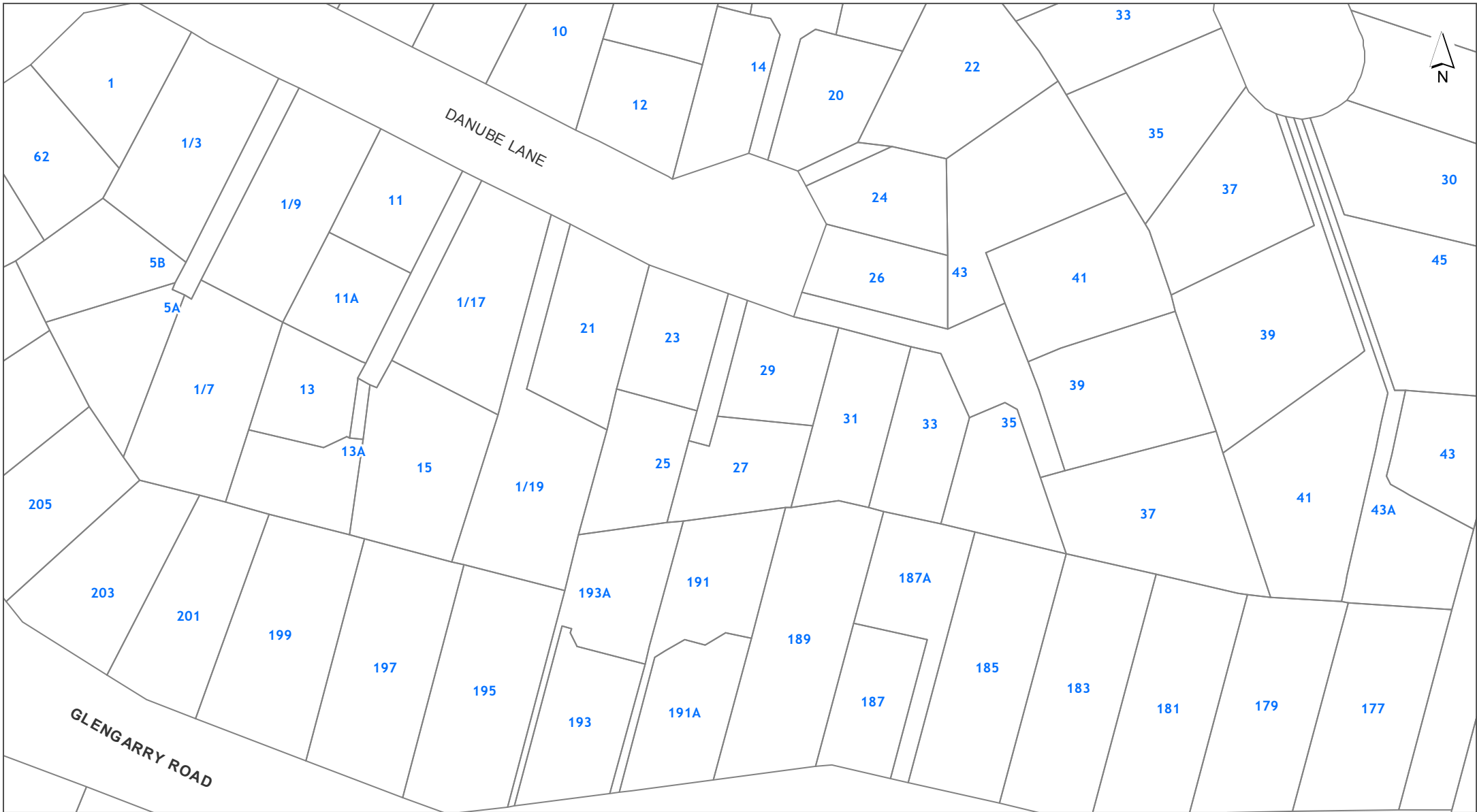

DISCLAIMER:  
This map/plan is illustrative only and all information should be independently verified on site before taking any action.  
Copyright Auckland Council. Land Parcel Boundary information from LINZ (Crown Copyright Reserved). Whilst due care has been taken, Auckland Council gives no warranty as to the accuracy and plan completeness of any information on this map/plan and accepts no liability for any error, omission or use of the information. Height datum: Auckland 1946.

Mana Whenua  
27 Danube Lane Glen Eden  
LOT 3 DP 137124

0 7 14 21  
Meters  
Scale @ A4  
= 1:1,000  
Date Printed:  
10/06/2021



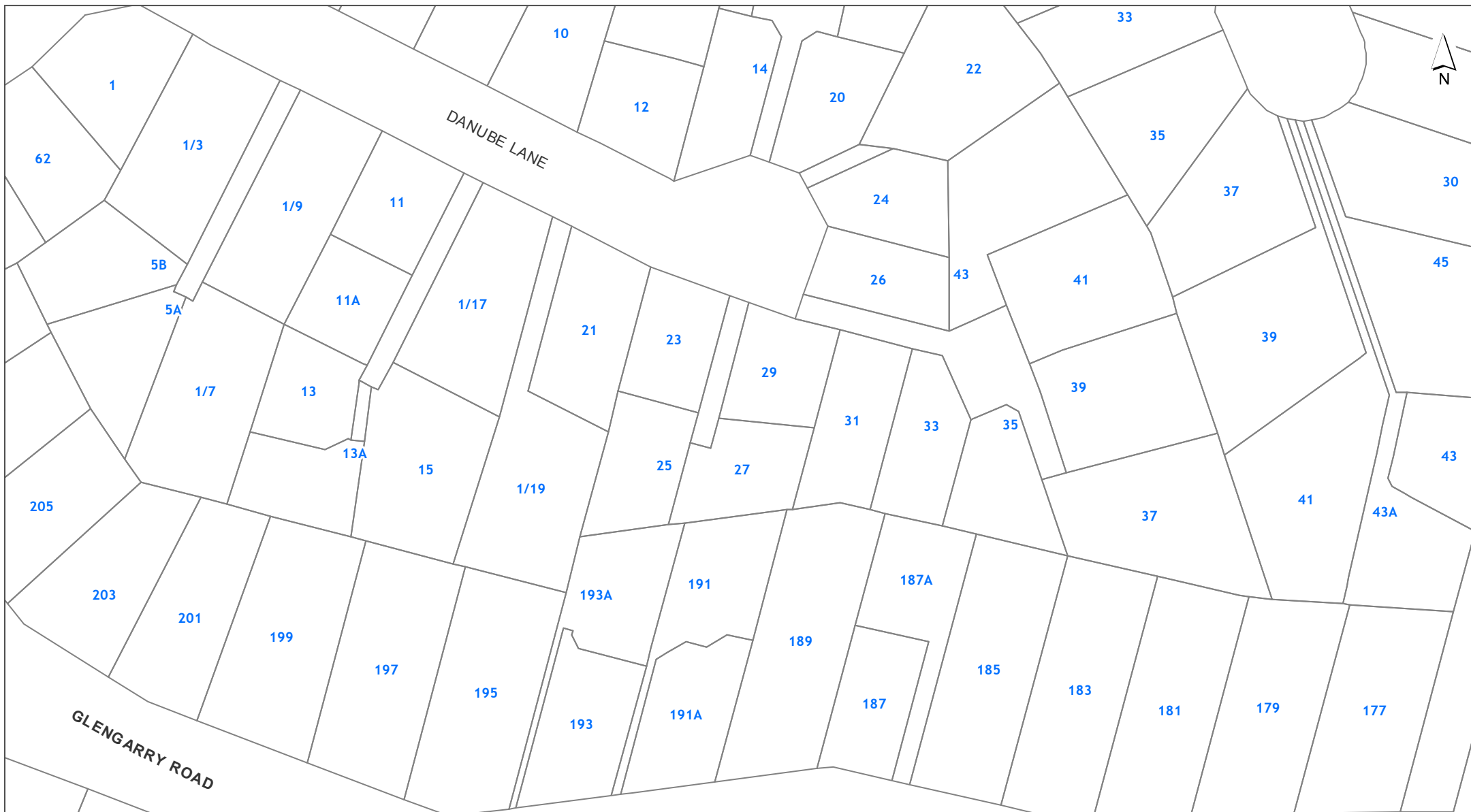

**DISCLAIMER:**  
 This map/plan is illustrative only and all information should be independently verified on site before taking any action.  
 Copyright Auckland Council. Land Parcel Boundary information from LINZ (Crown Copyright Reserved). Whilst due care has been taken, Auckland Council gives no warranty as to the accuracy and plan completeness of any information on this map/plan and accepts no liability for any error, omission or use of the information. Height datum: Auckland 1946.

**Natural Heritage**  
**27 Danube Lane Glen Eden**  
**LOT 3 DP 137124**

0 7 14 21  
 Meters  
 Scale @ A4  
 = 1:1,000  
 Date Printed:  
 10/06/2021



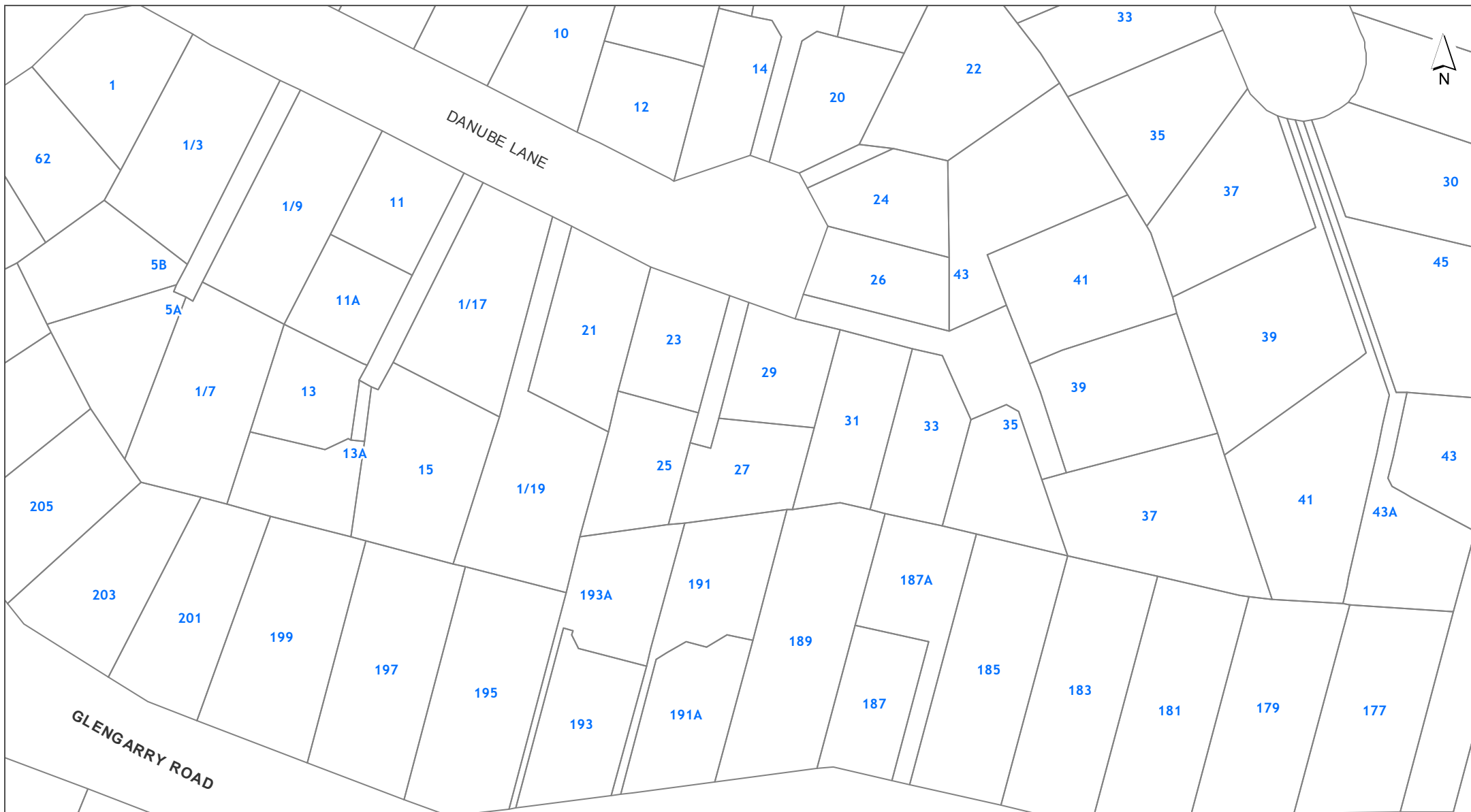

**DISCLAIMER:**  
 This map/plan is illustrative only and all information should be independently verified on site before taking any action. Copyright Auckland Council. Land Parcel Boundary information from LINZ (Crown Copyright Reserved). Whilst due care has been taken, Auckland Council gives no warranty as to the accuracy and plan completeness of any information on this map/plan and accepts no liability for any error, omission or use of the information. Height datum: Auckland 1946.

**Natural Resources**  
**27 Danube Lane Glen Eden**  
**LOT 3 DP 137124**

0 7 14 21  
 Meters  
 Scale @ A4  
 = 1:1,000  
 Date Printed:  
 10/06/2021



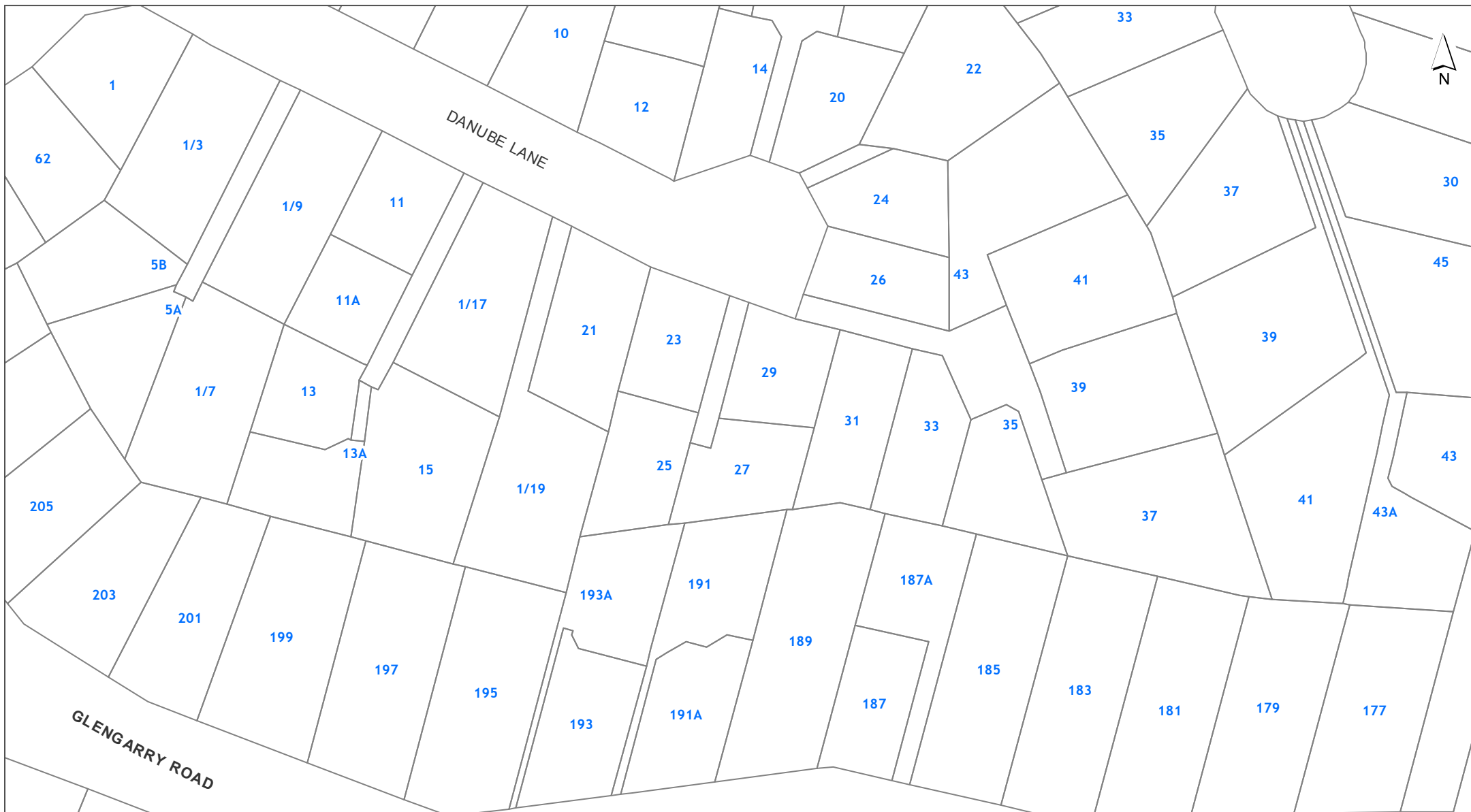

**DISCLAIMER:**  
 This map/plan is illustrative only and all information should be independently verified on site before taking any action. Copyright Auckland Council. Land Parcel Boundary information from LINZ (Crown Copyright Reserved). Whilst due care has been taken, Auckland Council gives no warranty as to the accuracy and plan completeness of any information on this map/plan and accepts no liability for any error, omission or use of the information. Height datum: Auckland 1946.

**Precincts**  
**27 Danube Lane Glen Eden**  
**LOT 3 DP 137124**



0 7 14 21  
 Meters  
 Scale @ A4  
 = 1:1,000  
 Date Printed:  
 10/06/2021







## NOTATIONS

### Appeals

-  Properties affected by Appeals seeking change to zones or management layers
-  Properties affected by Appeals seeking reinstatement of management layers

### Proposed Plan Modifications







-  Notice of Requirements
-  Plan Changes

### Tagging of Provisions:

- [ i ] = Information only
- [ rp ] = Regional Plan
- [ rcp ] = Regional Coastal Plan
- [ rps ] = Regional Policy Statement
- [ dp ] = District Plan (only noted when dual provisions apply)

## ZONING

### Residential

-  Residential - Large Lot Zone
-  Residential - Rural and Coastal Settlement Zone
-  Residential - Single House Zone
-  Residential - Mixed Housing Suburban Zone
-  Residential - Mixed Housing Urban Zone
-  Residential - Terrace Housing and Apartment Buildings Zone







### Business

-  Business - City Centre Zone
-  Business - Metropolitan Centre Zone
-  Business - Town Centre Zone
-  Business - Local Centre Zone
-  Business - Neighbourhood Centre Zone
-  Business - Mixed Use Zone
-  Business - General Business Zone
-  Business - Business Park Zone
-  Business - Heavy Industry Zone
-  Business - Light Industry Zone

### Open space

-  Open Space - Conservation Zone
-  Open Space - Informal Recreation Zone
-  Open Space - Sport and Active Recreation Zone
-  Open Space - Civic Spaces Zone
-  Open Space - Community Zone
-  Water [i]



### Rural

-  Rural - Rural Production Zone
-  Rural - Mixed Rural Zone
-  Rural - Rural Coastal Zone
-  Rural - Rural Conservation Zone
-  Rural - Countryside Living Zone
-  Rural - Waitakere Foothills Zone
-  Rural - Waitakere Ranges Zone

### Future Urban

-  Future Urban Zone
-  Green Infrastructure Corridor (Operative in some Special Housing Areas)

### Infrastructure

-  Special Purpose Zone - Airports & Airfields  
Cemetery  
Quarry  
Healthcare Facility & Hospital  
Tertiary Education  
Māori Purpose  
Major Recreation Facility  
School
-  Strategic Transport Corridor Zone

### Coastal

-  Coastal - General Coastal Marine Zone [rcp]
-  Coastal - Marina Zone [rcp/dp]
-  Coastal - Mooring Zone [rcp]
-  Coastal - Minor Port Zone [rcp/dp]
-  Coastal - Ferry Terminal Zone [rcp/dp]
-  Coastal - Defence Zone [rcp]
-  Coastal - Coastal Transition Zone



Precincts

--- Rural Urban Boundary

--- Indicative Coastline [i]

# Overlays

## Natural Resources

- Terrestrial [rp/dp]
- Marine 1 [rcp]
- Marine 2 [rcp]
- Water Supply Management Areas Overlay [rp]
- Natural Stream Management Areas Overlay [rp]
- High-Use Stream Management Areas Overlay [rp]
- Natural } Lake Management Areas Overlay (Natural Lake and Urban Lake)
- Urban }
- High-Use Aquifer Management Areas Overlay [rp]
- Quality-Sensitive Aquifer Management Areas Overlay [rp]
- Wetland Management Areas Overlay [rp]

## Infrastructure

- Airport Approach Surface Overlay
  - Aircraft Noise Overlay
  - City Centre Port Noise Overlay [rcp / dp]
  - Quarry Buffer Area Overlay
  - National Grid Subdivision Corridor
  - National Grid Substation Corridor
  - National Grid Yard Compromised
  - National Grid Yard Uncompromised
- } National Grid Corridor Overlay

## Mana Whenua

- Sites & Places of Significance to Mana Whenua Overlay [rcp/dp]

## Built Environment

- Identified Growth Corridor Overlay

## Natural Heritage

- Notable Trees Overlay
- Outstanding Natural Features Overlay [rcp/dp]
- Outstanding Natural Landscapes Overlay [rcp/dp]
- Outstanding Natural Character Overlay [rcp/dp]
- High Natural Character Overlay [rcp/dp]
- Viewshafts
- Height Sensitive Areas
- Regionally Significant Volcanic Viewshafts & Height Sensitive Areas Overlay [rcp/dp]
- Regionally Significant Volcanic Viewshafts Overlay Contours [i]
- Locally Significant Volcanic Viewshafts Overlay [rcp/dp]
- Locally Significant Volcanic Viewshafts Overlay Contours [i]
- Modified
- Natural
- Local Public Views Overlay [rcp/dp]
- Extent of Overlay
- Subdivision Schedule
- Waitakere Ranges Heritage Area Overlay

## Historic Heritage & Special Character

- Historic Heritage Overlay Place [rcp/dp]
- Historic Heritage Overlay Extent of Place [rcp/dp]
- Special Character Areas Overlay Residential and Business
- Auckland War Memorial Museum Viewshaft Overlay [rcp/dp]
- Auckland War Memorial Museum Viewshaft Overlay Contours [i]
- Stockade Hill Viewshaft Overlay – 8m height area
- Stockade Hill Viewshaft [i]

# Controls

- Key Retail Frontage
  - General Commercial Frontage
  - Adjacent to Level Crossings
  - General
  - Motorway Interchange Control
  - Centre Fringe Office Control
  - Height Variation Control
  - Parking Variation Control
  - Level Crossings With Sightlines Control
  - Arterial Roads
- } Building Frontage Control
- } Vehicle Access Restriction Control

- Business Park Zone Office Control
  - Hazardous Facilities
  - Infrastructure
  - Macroinvertebrate Community Index
  - Flow 1 [rp]
  - Flow 2 [rp]
  - Subdivision Variation Control
  - Surf Breaks [rcp]
  - Cable Protection Areas Control [rcp]
  - Coastal Inundation 1 per cent AEP Plus 1m Control
- } Emergency Management Area Control
- } Stormwater Management Area Control

# Designations

- Designations

- Airspace Restriction Designations





Stormwater

Note: Unless otherwise specified in the text below, the *colour* of a Stormwater symbol is determined by the ownership or usage status, using the following colour scheme:

**Public**, **Private** or **Abandoned**

- |  |                               |  |   |
|--|-------------------------------|--|---|
|  | Treatment Device              |  | Overland Flowpath (Public)                |
|  | Septic Tank                   |  | Overland Flowpath (Private)               |
|  | Septic Tank (Hi-Tech)         |  | Forebay (Public)                          |
|  | Soakage System                |  | Forebay (Private)                         |
|  | Inspection Chamber            |  | Treatment Facility (Public)               |
|  | Manhole (Standard / Custom)   |  | Treatment Facility (Private)              |
|  | Inlet & Outlet Structure      |  | Pump Station                              |
|  | Inlet & Outlet (No Structure) |  | Planting                                  |
|  | Catchpit                      |  | Embankment                                |
|  | Spillway                      |  | Viewing Platform                          |
|  | Safety Benching               |  | Bridge                                    |
|  | Culvert / Tunnel              |  | Erosion & Flood Control (Other Structure) |
|  | Subsoil Drain                 |  | Erosion & Flood Control (Wall Structure)  |
|  | Gravity Main                  |  |   |
|  | Rising Main                   |  |   |
|  | Connection                    |  |   |
|  | Fence                         |  |   |
|  | Lined Channel                 |  |   |
|  | Watercourse                   |  |   |

Water

- |  |  |
|--|--|
|  | Valve                                      |
|  | Hydrant                                    |
|  | Fitting                                    |
|  | Other Watercare Point Asset                |
|  | Other Watercare Linear Asset               |
|  | Local Pipe (Operational-NonPotable)        |
|  | Local Pipe (Operational-Potable)           |
|  | Local Pipe (Operational Not Vested)        |
|  | Local Pipe (Abandoned / Not Operational)   |
|  | Transmission Pipe (Operational-NonPotable) |
|  | Transmission Pipe (Operational-Potable)    |
|  | Transmission Pipe (Not Operational)        |
|  | Transmission Pipe (Proposed)               |
|  | Pump Station                               |
|  | Reservoir                                  |
|  | Other Structure (Local)                    |
|  | Chamber (Transmission)                     |
|  | Water Source (Transmission)                |
|  | Other Watercare Structures and Areas       |

Wastewater

- |  |  |
|--|--|
|  | Fitting                                  |
|  | Fitting (Non Watercare)                  |
|  | Manhole                                  |
|  | Pipe (Non Watercare)                     |
|  | Local Pipe (Operational)                 |
|  | Local Pipe (Operational Not Vested)      |
|  | Local Pipe (Abandoned / Not Operational) |
|  | Transmission Pipe (Operational)          |
|  | Transmission Pipe (Not Operational)      |
|  | Transmission Pipe (Proposed)             |
|  | Chamber                                  |
|  | Structure (Non Watercare)                |
|  | Pump Station                             |
|  | Wastewater Catchment                     |

Utilities

- |  |   |
|--|---|
|  | Transpower Site                         |
|  | Pylon (Transpower)                      |
|  | 110 kv - Electricity Transmission       |
|  | 220 kv - Electricity Transmission       |
|  | 400 kv - Electricity Transmission       |
|  | Aviation Jet A1 Fuel Pipeline           |
|  | Liquid Fuels Pipeline [Marsden to Wiri] |
|  | Gas Transmission Pipeline               |
|  | High-Pressure Gas Pipeline              |
|  | Medium-Pressure Gas Pipeline            |
|  | Indicative Steel Mill Slurry Pipeline   |
|  | Indicative Steel Mill Water Pipeline    |
|  | Fibre Optic Cable (ARTA)                |
|  | Contour Interval                        |

Legend updated: 21/09/2020

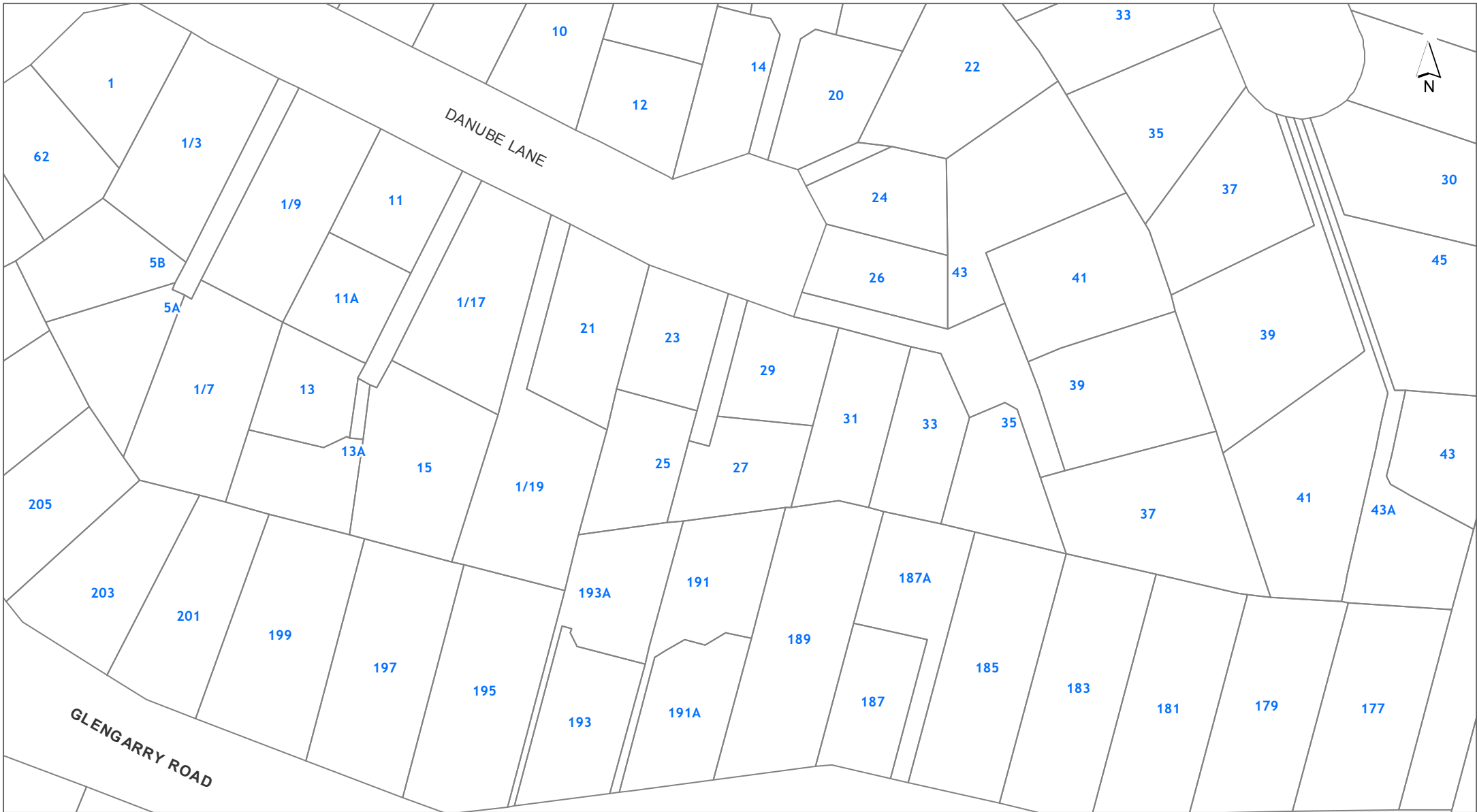

**DISCLAIMER:**  
This map/plan is illustrative only and all information should be independently verified on site before taking any action. Copyright Auckland Council. Land Parcel Boundary information from LINZ (Crown Copyright Reserved). Whilst due care has been taken, Auckland Council gives no warranty as to the accuracy and plan completeness of any information on this map/plan and accepts no liability for any error, omission or use of the information. Height datum: Auckland 1946.

**Hazards**  
**27 Danube Lane Glen Eden**  
**LOT 3 DP 137124**

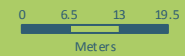

**Scale @ A4**  
**= 1:1,000**  
**Date Printed:**  
**10/06/2021**



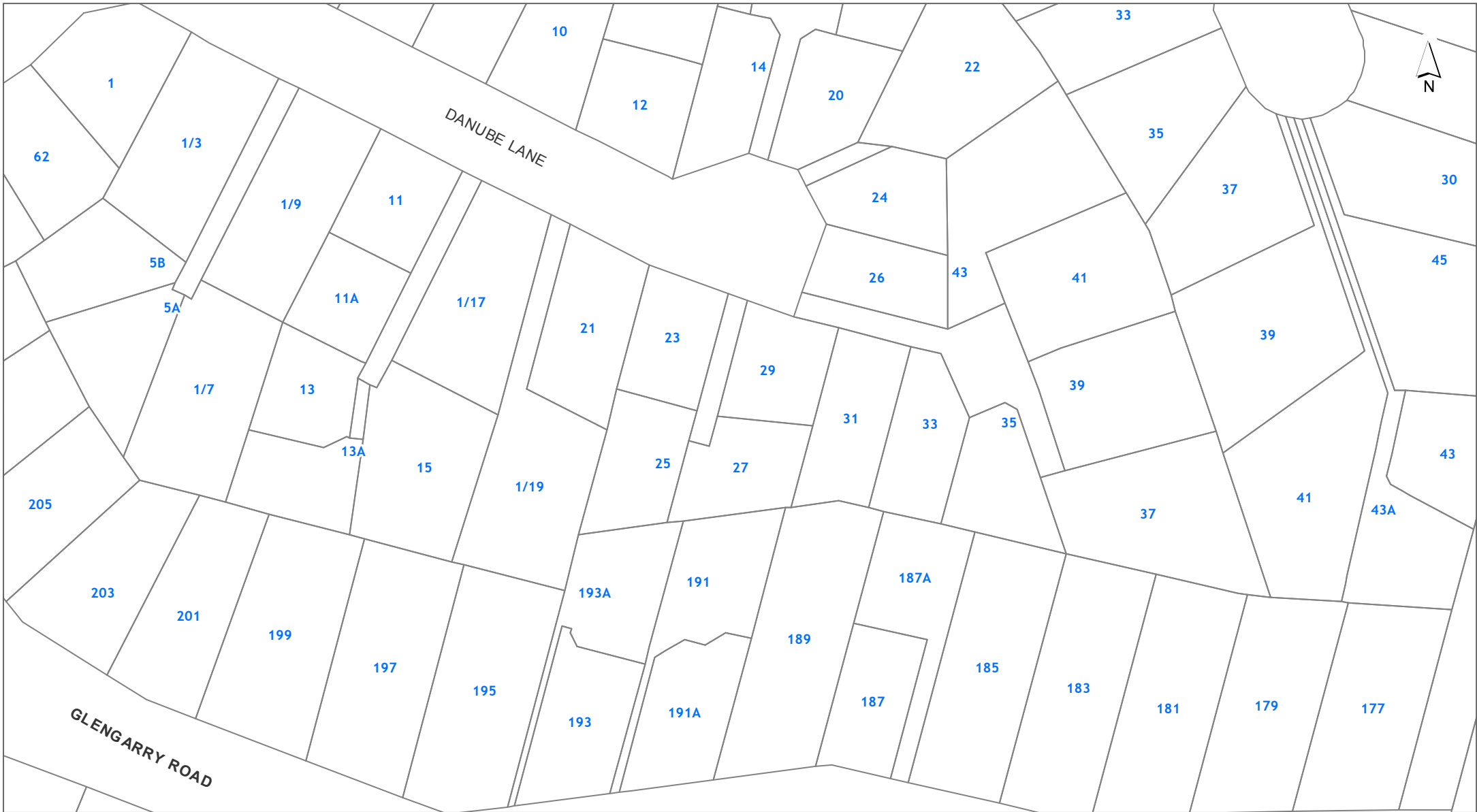

**DISCLAIMER:**  
This map/plan is illustrative only and all information should be independently verified on site before taking any action. Copyright Auckland Council. Land Parcel Boundary information from LINZ (Crown Copyright Reserved). Whilst due care has been taken, Auckland Council gives no warranty as to the accuracy and plan completeness of any information on this map/plan and accepts no liability for any error, omission or use of the information. Height datum: Auckland 1946.

**Natural Hazards - Coastal Inundation**

**27 Danube Lane Glen Eden**

**LOT 3 DP 137124**

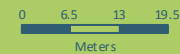

**Scale @ A4**  
**= 1:1,000**

**Date Printed:**  
**10/06/2021**



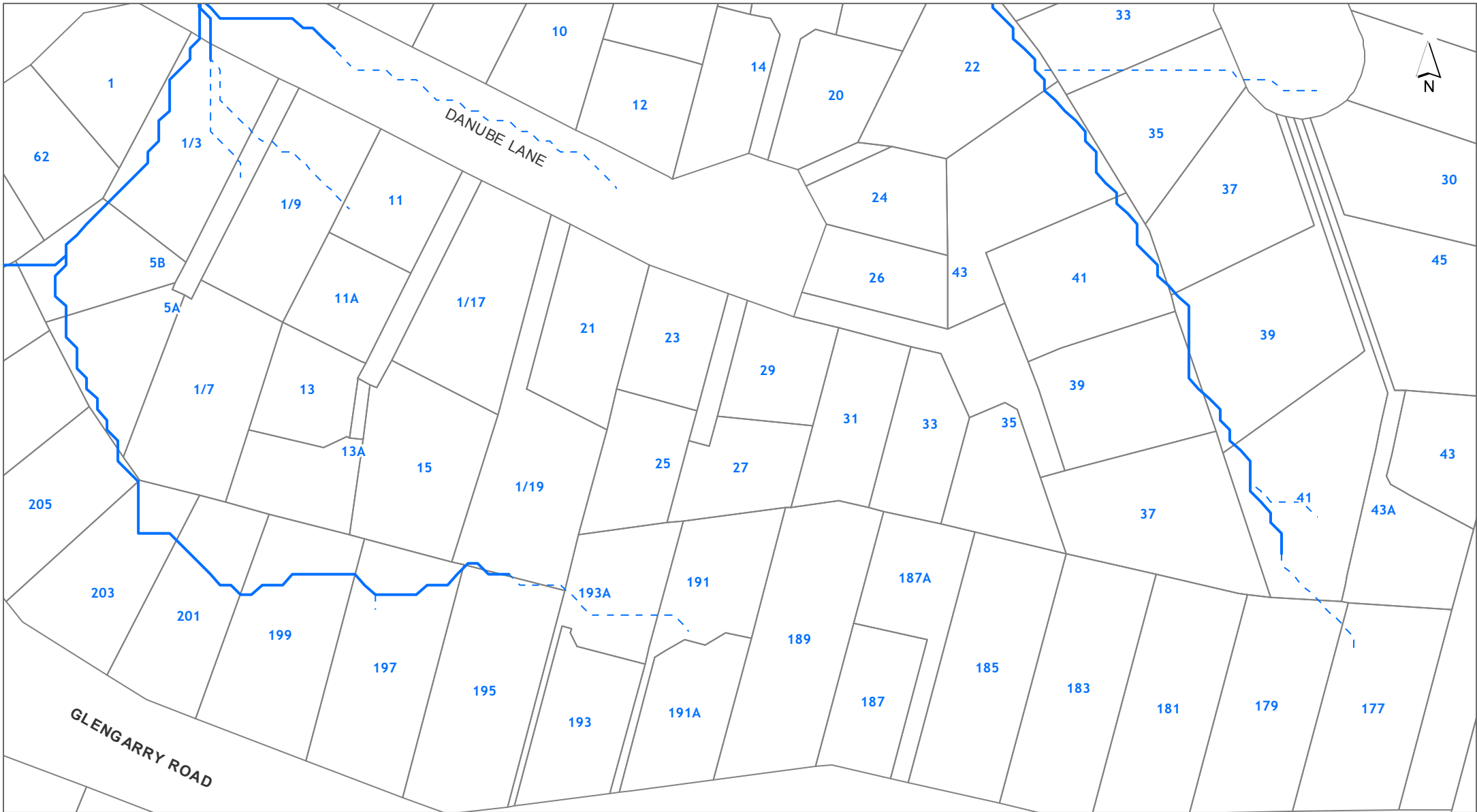

**DISCLAIMER:**  
This map/plan is illustrative only and all information should be independently verified on site before taking any action. Copyright Auckland Council. Land Parcel Boundary information from LINZ (Crown Copyright Reserved). Whilst due care has been taken, Auckland Council gives no warranty as to the accuracy and plan completeness of any information on this map/plan and accepts no liability for any error, omission or use of the information. Height datum: Auckland 1946.

**Natural Hazards - Flooding**

**27 Danube Lane Glen Eden**

**LOT 3 DP 137124**

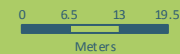

**Scale @ A4**  
**= 1:1,000**

**Date Printed:**  
**10/06/2021**



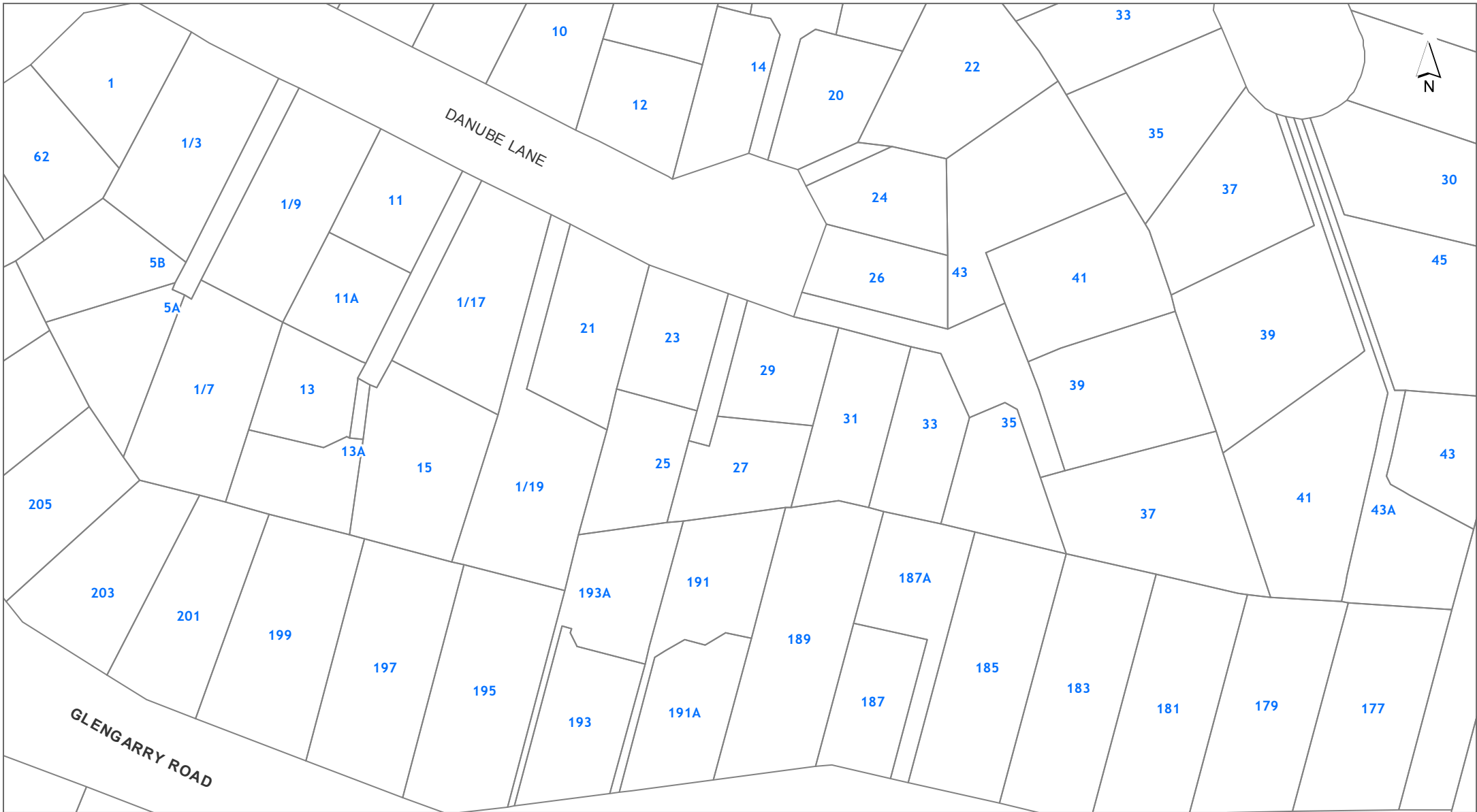

**DISCLAIMER:**  
 This map/plan is illustrative only and all information should be independently verified on site before taking any action.  
 Copyright Auckland Council. Land Parcel Boundary information from LINZ (Crown Copyright Reserved). Whilst due care has been taken, Auckland Council gives no warranty as to the accuracy and plan completeness of any information on this map/plan and accepts no liability for any error, omission or use of the information. Height datum: Auckland 1946.

**Natural Hazards - Sea Spray**

**27 Danube Lane Glen Eden**

**LOT 3 DP 137124**

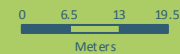

Scale @ A4  
 = 1:1,000

Date Printed:  
 10/06/2021



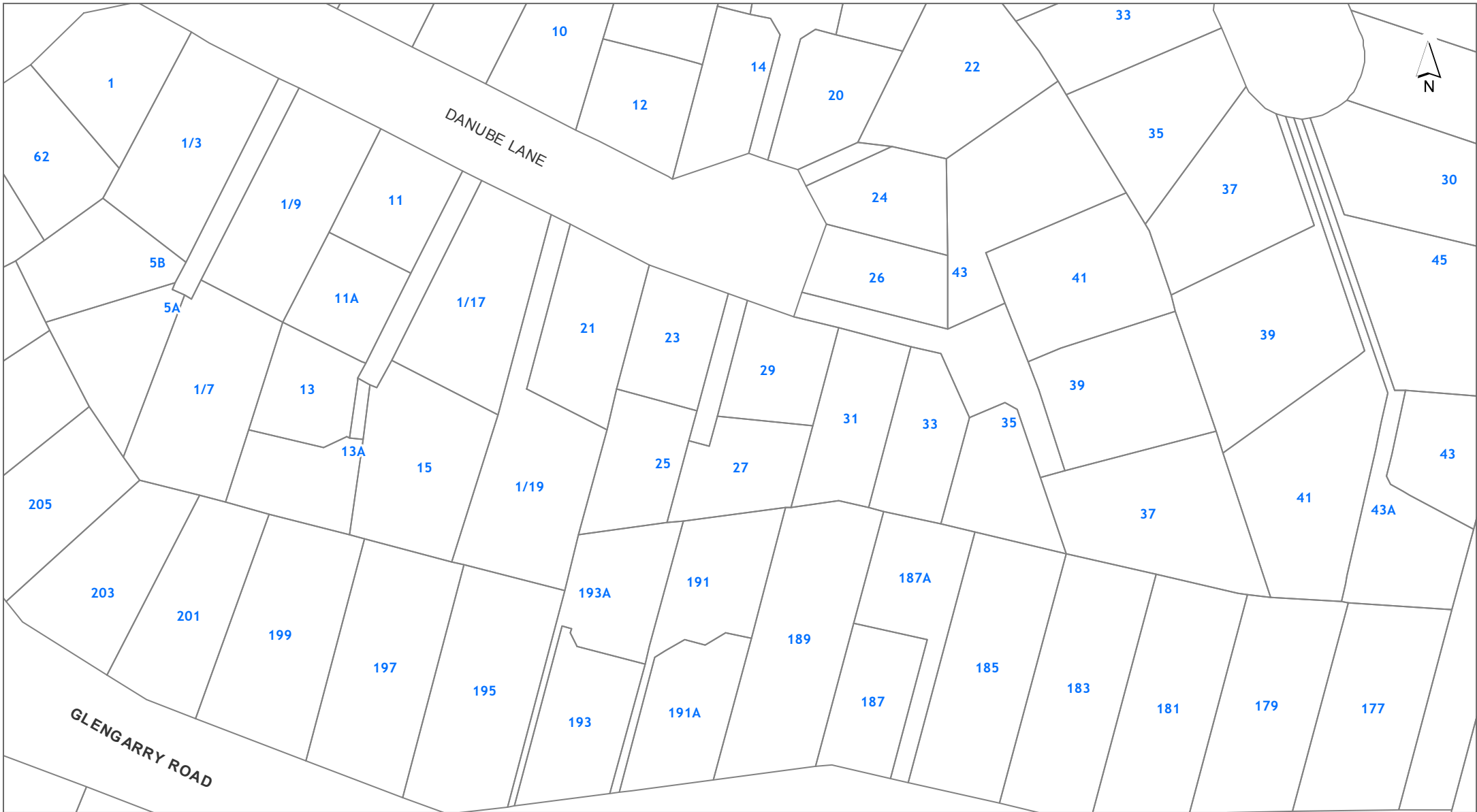

**DISCLAIMER:**  
This map/plan is illustrative only and all information should be independently verified on site before taking any action. Copyright Auckland Council. Land Parcel Boundary information from LINZ (Crown Copyright Reserved). Whilst due care has been taken, Auckland Council gives no warranty as to the accuracy and plan completeness of any information on this map/plan and accepts no liability for any error, omission or use of the information. Height datum: Auckland 1946.

**Natural Hazards - Volcanic Cones**

**27 Danube Lane Glen Eden**

**LOT 3 DP 137124**

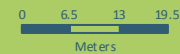

**Scale @ A4**  
**= 1:1,000**

**Date Printed:**  
**10/06/2021**





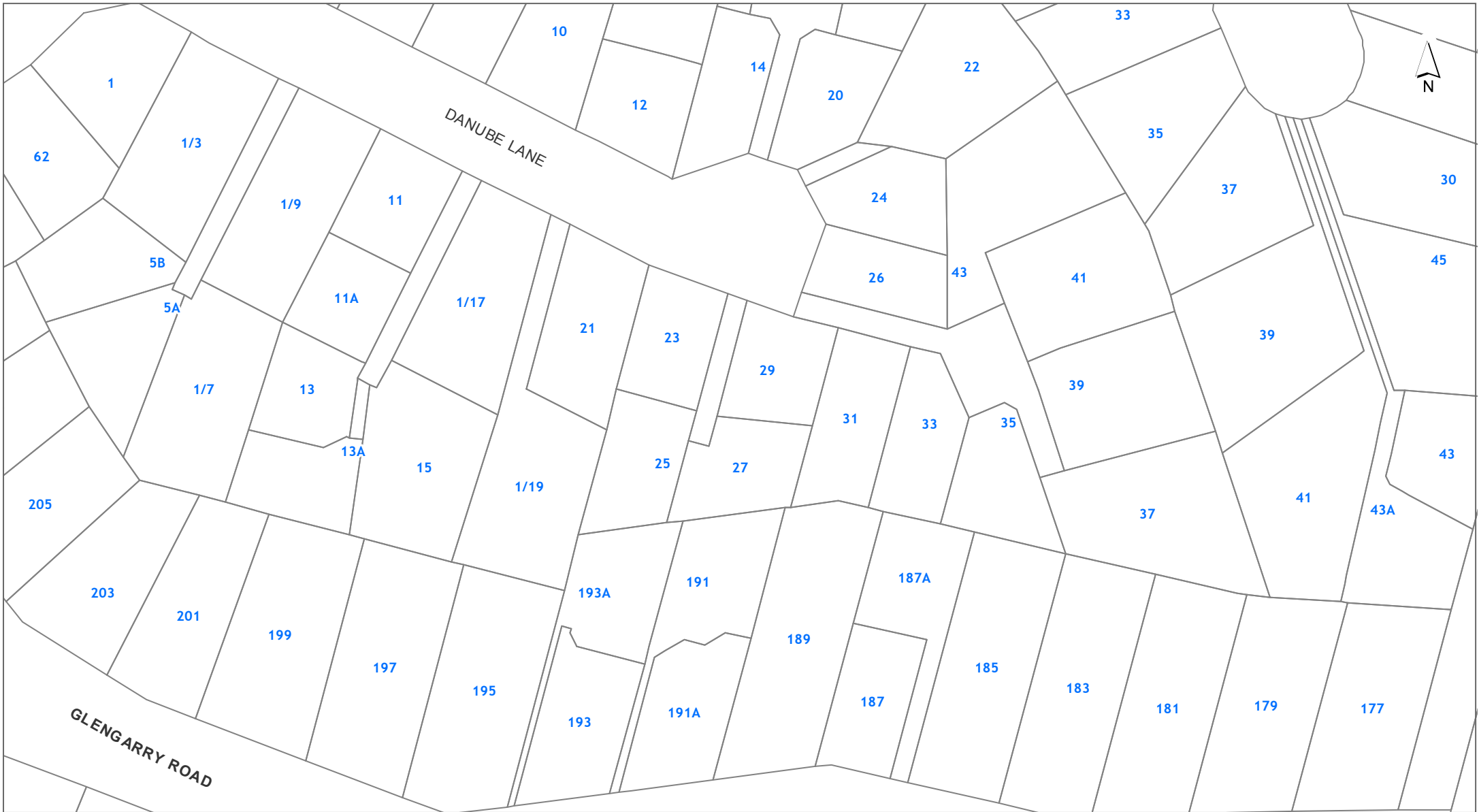

**DISCLAIMER:**  
 This map/plan is illustrative only and all information should be independently verified on site before taking any action. Copyright Auckland Council. Land Parcel Boundary information from LINZ (Crown Copyright Reserved). Whilst due care has been taken, Auckland Council gives no warranty as to the accuracy and plan completeness of any information on this map/plan and accepts no liability for any error, omission or use of the information. Height datum: Auckland 1946.

**Other**  
 27 Danube Lane Glen Eden  
 LOT 3 DP 137124



0 6.5 13 19.5  
 Meters  
 Scale @ A4  
 = 1:1,000  
 Date Printed:  
 10/06/2021



















Hazards

Soil Warning Area

-  Fill (Franklin District only)
-  Advisory (Franklin District only)
-  Contamination (Franklin District only)
-  Erosion (Franklin District only)
-  Hazardous Activities & Industries List (HAIL) (Franklin District only)
-  Inundation (Franklin District only)
-  Rainfall Event (Franklin District only)
-  Slippage (Franklin District only)
-  Subsidence (Franklin District only)
-  Slippage / Subsidence / Erosion etc (Auckland City and Papakura District only)
-  Uncertified Fill (Auckland City and Papakura District only)
-  Organic Soil (Auckland City and Papakura District only)
-  Filled / Weak Ground (Auckland City and Papakura District only)
-  Refuse Tips Site / Weak Area (Auckland City and Papakura District only)
-  Unstable / Suspected Ground (Auckland City and Papakura District only)
-  Allochthon Waitemata (Rodney District only)
-  Motatau Complex (Rodney District only)
-  Puriri Mudstone (Rodney District only)
-  Mahurangi Limestone (Rodney District only)
-  Mangakahia Complex (Rodney District only)
-  Hukerenui Mudstone (Rodney District only)
-  Whangai Formation (Rodney District only)
-  Tangihua Complex (Rodney District only)
-  within 150m of Northland Allochthon (Rodney District only)



Hazards

Soil Warning Area continued



-  Soil D (Rodney District only)
-  within 150m of Soil D (Rodney District only)
-  Soil C (Rodney District only)
-  within 150m of Soil C (Rodney District only)
-  Soil B (Rodney District only)
-  within 150m of Soil B (Rodney District only)
-  Soil A (Rodney District only)
-  Gas Main Pipeline
-  Petroleum Pipeline
-  Closed Landfill (Auckland Council owned)
-  Closed Landfill (Privately owned)
-  Air Discharge (Franklin District only)
-  No Soakage (Franklin District only)
-  Indicative Steel Mill Slurry Line 20m Buffer (Franklin District only)
-  Indicative Steel Mill Water Line 20m Buffer (Franklin District only)





Natural Hazards

Overland Flow Path

-  Catchment area 2000m<sup>2</sup> to 3999 m<sup>2</sup>
-  Catchment area 4000 m<sup>2</sup> to 3 Ha
-  Catchment area 3 Ha and above







Coastal Inundation

-  1% AEP
-  1% AEP plus 1m sea level rise
-  1% AEP plus 2m sea level rise

-  1% AEP Flood Plain
-  Flood Prone Areas
-  Flood Sensitive Areas
-  Sea Spray
-  Volcanic Cones

Other

Cultural Heritage Index

-  Archaeological Site
-  Hayward and Diamond
-  Historic Botanical Site
-  Historic Structure
-  Maori Heritage Area
-  Maritime Site
-  Reported Historic Site

The information Council holds in relation to Special Land Features differs based on the area a property is located in. Those areas where information is held on a Special Land Feature is denoted in the legend above.

Legend updated: 12/06/2018

Refer: David Makani :Colleen Shaw Ext. 8353 Civic Centre

25 September, 1996

S Faapaia  
3218 Great North Road  
AUCKLAND

Dear Sir

RE: ERECT A DECK

I would advise that your application has been considered and the following decision reached:

Pursuant to Sections 104, 105 and 108 of the Resource Management Act 1991, being satisfied that no body or person is adversely affected, consent is granted to the application by S Faapaia to erect a deck in the 6.0m privacy/amenity yard control at 27 Danube Lane, Glen Eden being Lot 3 DP 137124 for the following reasons:-

- (i) The written consent has been obtained from all persons considered to be potentially affected by the proposal pursuant to S94(2)(b) of the Resource Management Act 1991.
- (ii) The proposal has been considered in terms of the relevant assessment criteria, meets the relevant policies and objectives of the District Plan, and will not create any significant adverse effects on the environment. (Relevant assessment criteria are attached).

Conditions imposed on the consent are as follows:

Nil

A copy of the decision and the supporting report is enclosed for your information. If consent has been granted, this lapses in two years unless it has been given effect to within that period (refer Section 125 of the Resource Management Act). Please also note that the development must be carried out in accordance with the plans and information submitted with the application any conditions of consent. Any time period specified within the conditions of consent must be complied with. A site inspection will be carried out by a Council Officer to check for compliance at an appropriate later date.

Please note that additional requirements may apply if you require a building consent.

If you are dissatisfied with this decision it is suggested you contact Mr Peter Reaburn, Planning Manager, to discuss the provisions relating to the objection procedures under

Section 357 of the Resource Management Act 1991. Any objection to a decision (including a condition of consent) must be made in writing within 15 working s days of the receipt of this letter.

Should you have any further queries, please do not hesitate to contact David Makani of the Planning Department.

Yours faithfully

PETER D REABURN  
PLANNING MANAGER