

NORTH AUCKLAND LAND DISTRICT

SUBJECT TO SEC 16 LAND ACT 1924

WAITEMATA COUNTY

19098

TRaverse SHEETS 68
1882-1917
EXAMINED 1917
REFERENCE PLANS - DP102,
1705, 1725, 1725, 1745

For definition of lots
of lots 287-289 see FB 365 p 10
For survey at road frontage
of Lot 446 see FB 475 p 10
D.P. 17105
For subdiv lots 200-201
222 see S.P. 925

For subdivision of lots 458-463
see S.P. 832
S.I. supra see K6082

For redefinition of lots
454-455 see S.P. 389 p 25

For page misprint of lot
228 see S.P. 468 p 29

VJ Scheme Plans Nos 1214, 1218 cancelled
224 to 225, 273 & 278 See Scheme Plan
No 3151 Town of Tairāngi E.M. No 12
V.A. 2036
L.T. Draughtman

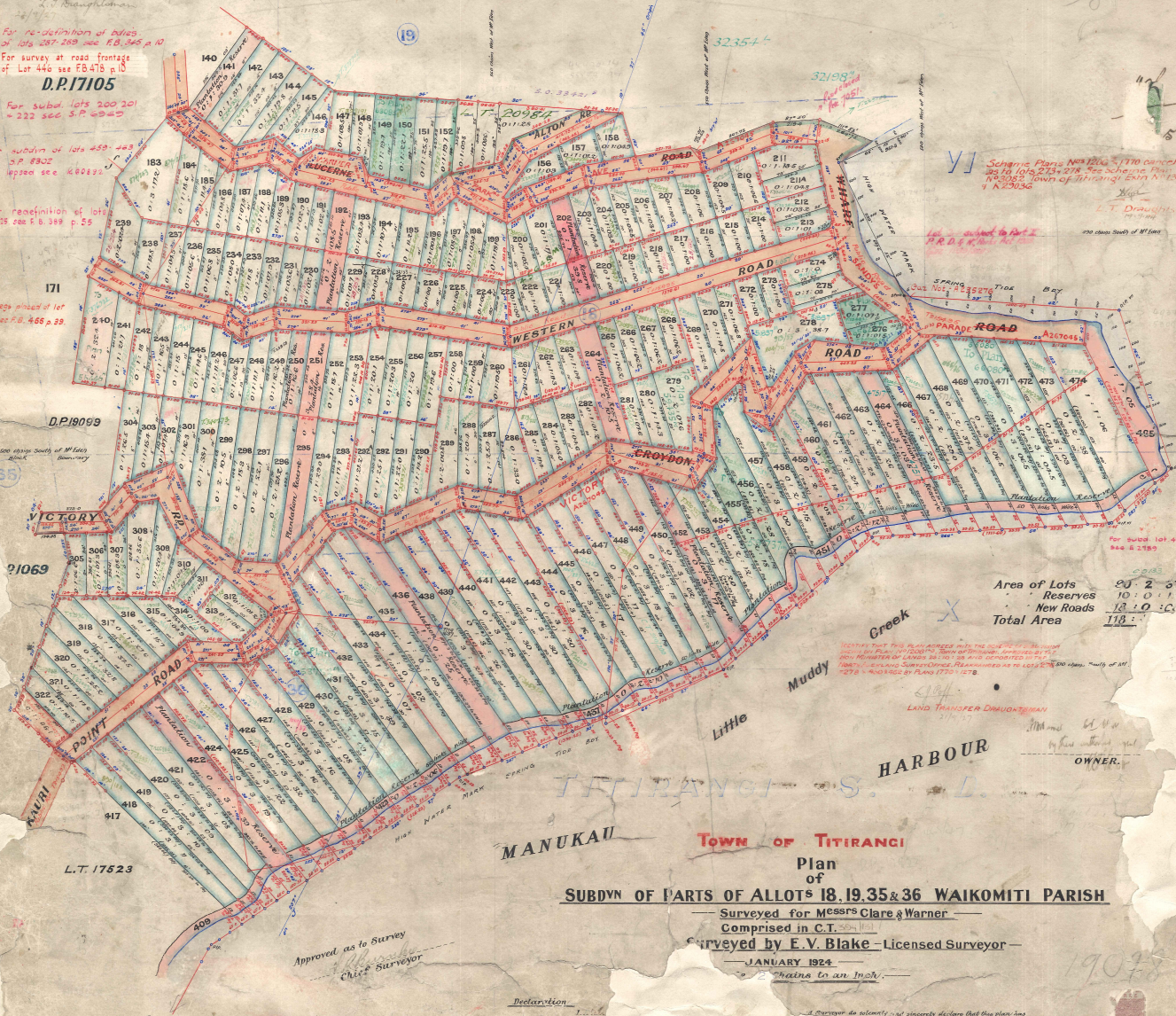

Area of Lots	50 2 0 2
Reserves	10 0 1
New Roads	13 0 0
Total Area	113 2 1

TOWN OF TITIRANGI
Plan of
SUBDIVISION OF PARTS OF ALLOTS 18, 19, 35 & 36 WAIKOMITI PARISH

Surveyed for Messrs Clare & Warner
Comprised in C.T. 668/19
Surveyed by E.V. Blake - Licensed Surveyor -
JANUARY 1924

Approved as to Survey
Chief Surveyor

Declaration

I, the Surveyor do solemnly and sincerely declare that this plan has been prepared and filed in accordance with the provisions of the Survey Act, 1908, and that the same is a true and correct copy of the original filed in the office of the Surveyor-General at Auckland, New Zealand, on the 10th day of March 1924.

All hanging traverses chained & observed twice.

19098