

NOTE: THIS IS A LIVE DOCUMENT THAT CHANGES, PLEASE ENSURE YOU DOWNLOAD THE MOST UP TO DATE VERSION PRIOR TO MAKE AN OFFER OR ATTENDING AN AUCTION.

INTEREST: DURING MARKETING CAMPAIGNS DATES AND TIMEFRAMES SOMETIMES CHANGE. IF YOU HAVE NOT MADE US AWARE THAT YOU ARE INTERESTED IN PURSUING THE PROPERTY, WE WILL NOT BE ABLE TO INFORM YOU OF ANY CHANGES AND YOU MAY LOSE OUT.

28 March 2022

Re: 49 Tane Road, Laingholm

Thank you for your interest in the above property currently listed with us and for sale by **DEADLINE SALE**.

We have made available to you the following:

- Certificate of Title
- LIM
- Rates information from Auckland Council
- School Zones
- REA Code of Conduct
- REA Guide to Selling and Buying
- Conditions of sale

49 Tane Road is 1012m² more or less fee simple estate NA855/176 Lot 522 Deposited Plan 22223.
Zoning: Residential – Large Lot Zone

THINGS WE WANT TO DRAW YOUR ATTENTION TO:

Land Information Memorandum (LIM)

Wind Zones for this property	Very high wind speed of 50 m/s
Soil Issues	30/06/2000 Stability Sensitive: Please note this property was previously shown under the Transitional District Plan as being located in a Stability sensitive area. <i>Stability sensitive - Titirangi and Laingholm is stability sensitive. This means that should you develop the property, you will require an engineer's report.</i>

Planning	LUC-1977-425 To erect a carport Granted 01/06/1977 LUC-1984-474 Addition of two bedrooms to dwelling Granted 22/02/1984 LUC-1984-4707 Erect addition to dwelling Granted 10/10/1984
Building	BPM-1976-4141 Dwelling 14/04/1976 Issued BPM-1984-26705 Addition to dwelling 12/10/1984 Issued
Waitakere Ranges Heritage Area	This property is located within the Waitākere Ranges Heritage Area as defined in the Waitākere Ranges Heritage Area Act 2008.

Settlement Date on Offer: As soon as possible

We recommend that when purchasing a property, you seek legal advice, complete due diligence including getting a building report and arrange your finance.

This information has been supplied to us by a third party. Accordingly, the Vendor and Austar Realty Limited are merely passing over this information as supplied to us by others. While we have passed on this information supplied by a third party, we have not checked, audited, or reviewed records or documents and therefore to the maximum extent permitted by law neither the Vendor nor Austar Realty Limited or any of its' salespersons or employees accept any responsibility for the accuracy of the materials. Intending purchasers are advised to conduct their own investigation

Regards

Bronwyn Scott-Woods & Adrian Gomez



The ProAgent Team

ALAN WHITE
ELITE
PERFORMER 21-22

Bronwyn Scott-Woods 021 613 632 | bronwyn.scott-woods@raywhite.com

Adrian Gomez 021 839 499 | adrian.gomez@raywhite.com

Austar Realty Ltd Licensed (REAA 2008) | 423 Titirangi Road, Titirangi 0604

STATEMENT OF PASSING OVER INFORMATION:

This information has been supplied to us by a third party. Accordingly, the Vendor and Austar Realty Limited are merely passing over this information as supplied to us by others. While we have passed on this information supplied by a third party, we have not checked, audited, or reviewed the records or documents and therefore to the maximum extent permitted by law neither the Vendor nor Austar Realty Limited or any of its' salespersons or employees accept any responsibility for the accuracy of the materials. Intending purchasers are advised to conduct their own investigation.

Austar Realty Ltd
PO Box 69139
Glendene
AUCKLAND 0645



Applicant	Austar Realty Ltd
LIM address	49 Tane Road Laingholm
Application number	8270382537
Customer Reference	
Date issued	28-Mar-2022
Legal Description	LOT 522 DP 22223
Certificates of title	NA855/176

Disclaimer

This Land Information Memorandum (LIM) has been prepared for the applicant for the purpose of section 44A of the Local Government Official Information and Meetings Act 1987.

The LIM includes information which:

- Must be included pursuant to section 44A of the Local Government Official Information and Meetings Act 1987
- Council at its discretion considers should be included because it relates to land
- Is considered to be relevant and reliable

This LIM does not include other information:

- Held by council that is not required to be included
- Relating to the land which is unknown to the council
- Held by other organisations which also hold land information

Council has not carried out an inspection of the land and/or buildings for the purpose of preparing this LIM. Council records may not show illegal or unauthorised building or works on the land.

The applicant is solely responsible for ensuring that the land or any building on the land is suitable for a particular purpose and for sourcing other information held by the council or other bodies. In addition, the applicant should check the Certificate of Title as it might also contain obligations relating to the land.

The text and attachments of this document should be considered together.

This Land Information Memorandum is valid as at the date of issue only.

s44A(2)(a) Information identifying any special feature or characteristics of the land

This information should not be regarded as a full analysis of the site features of this land, as there may be features that the Council is unaware of. The applicant is solely responsible for ensuring that the land is suitable for a particular purpose including development.

Site Contamination

No land contamination data are available in Council's regulatory records.

Wind Zones

Wind Zone(s) for this property: Very high wind speed of 50 m/s

The wind zones are based on wind speed data specific to all building sites as outlined in NZS 3604:2011. Other factors such as topographic classes, site exposure and ground roughness determine the actual wind bracing demands and bracing elements required for the building.

For further information refer to NZS 3604:2011 Section 5 — Bracing Design

Soil Issues

Soil issues recorded. The land may not be suitable for particular development or land use purposes. A soil report may be required to/must be submitted with any building and/or resource consent application.

Effective Date	Description	Details
30/06/2000	Stability Sensitive	Please note this property was previously shown under the Transitional District Plan as being located in a Stability sensitive area.

If any soil information/reports have been prepared in relation to this property, they will be available for viewing at an Auckland Council Service Centre.

Flooding

This statement entitled "Flooding" appears on all LIMs.

Known flooding information is displayed on the map attached to this LIM entitled "Special Land Features – Natural Hazards - Flooding".

The information shown in the "Special Land Features - Natural Hazards - Flooding" map is also shown on the Auckland Council online map viewer (Geomaps), at www.aucklandcouncil.govt.nz, which is updated from time to time.

Any proposed development may require a flooding assessment to be provided by the applicant.

The absence of flooding on the "Special Land Features - Natural Hazards - Flooding" map does not exclude the possibility of the site flooding, particularly from Overland Flow Paths which may be on other properties.

Exposure Zones

New Zealand Standard 3604:2011E classifies all properties in New Zealand into zones based on environmental features including wind, earthquake, snow load and exposure. These zones are relevant to building requirements, such as strength of buildings, materials that should be used and maintenance. All building sites are classified as being in Exposure Zones Extreme Sea Spray, B, C, or D, depending on the severity of exposure to wind driven salt.

This property is classified as: Unknown or Unassessed Corrosion Zone

Unknown or unassessed - No known information is available relating to these sites. Recommended that specific sites and/or product designed and to consult suppliers information for specific durability requirements.

Coastal Erosion

This explanation appears on all LIMs, not just sites that may be susceptible to coastal erosion.

The map entitled "Natural Hazards - Coastal Erosion" shows information on potential coastal erosion and resulting land instability, if any, in relation to this site.

Coastal erosion is the wearing away of land due to coastal processes such as waves and currents. Coastal instability is the movement of land (typically as a landslide) resulting from the loss of support caused by coastal erosion.

Where applicable, the map shows lines that indicate areas susceptible to coastal instability and erosion (ASCIE) within the next 100 years. The lines do not show the future position of the coast. Rather, they show the landward edge of the area that might become unstable as a result of coastal erosion. The area between this line and the sea is considered to be potentially susceptible to erosion, or instability caused by erosion.

The lines represent three timescales, and take into account projected sea level rise based on carbon emission scenarios known as representative concentration pathways (RCP):

- 2050 (0.28 m of sea level rise; RCP 8.5)
- 2080 (0.55 m of sea level rise; RCP 8.5)
- 2130 (1.18 m of sea level rise; RCP 8.5)
- 2130 (1.52 m of sea level rise; RCP 8.5+)

The RCP projections are from the Intergovernmental Panel on Climate Change fifth assessment report (2015), and the related sea level rise values align with Ministry for the Environment Coastal Hazards and Climate Change Guidance for Local Government (2017).

The lines are based on data from a regional study ("Predicting Auckland's Exposure to Coastal Instability and Erosion", available on the Council website). The lines may not take into account local variability, and are not intended for site-specific use.

Development on sites affected by potential coastal erosion may be subject to Auckland Unitary Plan activity controls and may require a detailed coastal hazard assessment report to be completed by a qualified expert.

s44A(2)(b) Information on private and public stormwater and sewerage drains

Information on private and public stormwater and sewerage drains is shown on the **underground services map** attached.

Note: Private drainage is the responsibility of the land owner up to and including the point of connection to the public sewer or drain.

s44(2)(ba) Information notified to Council by a drinking water supplier under Section 69ZH of the Health Act 1956

Prospective purchasers should be aware of other drinking water systems connected to this property. There may also be private drinking water supply systems such as rainwater tanks or private water bores. You are advised to clarify the drinking water supply with the current landowner.

No Information has been notified to Council.

s44A(2)(bb) Information Council holds regarding drinking water supply to the land

For metered water information, please contact **Watercare (09) 442 2222** for services provided to this property.

s44A(2)(c) Information relating to any rates owing in relation to the land

Billing Number/ Rate Account:	12341814535
Rates levied for the Year 2021/2022 :	\$2,604.68
Total rates to clear for the current year (including any arrears and postponed rates):	\$707.49

The rates figures are provided as at 8 a.m. 28/03/2022. It is strongly advised these are not used for settlement purposes.

Retrofit Your Home Programme

The Retrofit Your Home programme provides financial assistance, advice and information to householders wanting to create an improved home environment. The scheme contributes to the achievement of the Air Quality National Environmental Standards encouraging the installation of clean heat and insulation in homes as well as supporting access to central government grants and subsidies. The programme offers homeowners a retrofit plan for their homes and financial assistance up to \$5000 repaid through a targeted rate.

 Auckland Council (09) 890 7898 if you require further information

 retrofit@aucklandcouncil.govt.nz

s44A(2)(d) Consents, Certificates, Notices, Orders or Requisitions affecting the land or any buildings on the land(da) the information required to be provided to a territorial authority under section 362T(2) of the Building Act 2004:s44A and (2)(e) Information concerning any Certificate issued by a Building Certifier pursuant to the Building Act 1991 or the Building Act 2004

Note: if the land is part of a cross lease title or unit title, consents and permits for the other flats or units may be included in this LIM. If the land has been subdivided there may be consents and permits included that relate to the original property.

It is recommended that the full property file is viewed and compared with the actual building and activities on the land to identify any illegal or unauthorised building works or activities.

Financial / development contributions

Financial and development contributions are relevant for recently subdivided land, vacant lots, new residential unit(s) or where there is further development of a site. If any financial or development contribution has not been paid, Council can recover outstanding amount(s) from a subsequent owner of the land.

Please note that financial contributions and development contributions may be paid in land, cash or a combination of these. The form of payment of contributions may be subject to negotiation but final discretion remains with the Council.

Resource Management

Planning

49 Tane Road Laingholm

Application No.	Description	Decision	Decision Date
LUC-1977-425	To erect a carport	Granted	01/06/1977
LUC-1984-474	Addition of two bedrooms to dwelling	Granted	22/02/1984
LUC-1984-4707	Erect addition to dwelling	Granted	10/10/1984

Subdivisions

There are **NO** Subdivision resource consents recorded.

Engineering Approvals

There are **NO** Engineering approvals recorded.

If there are any conditions, then only that portion of the consent will be included in the attachments section. The applicant should satisfy themselves as to whether all conditions of resource consents for this property have been met.

Further Information

The Council may hold additional information for this property, for example concerning resource consents for discharges to air, land or water issued by the former Auckland Regional Council prior to 1 November 2010. If

you would like Auckland Council to search for this type of information, please contact us.

Building

49 Tane Road Laingholm

Application No.	Description	Issue Date	Status
BPM-1976-4141	Dwelling	14/04/1976	Issued (See Note 1)
BPM-1984-26705	Addition to dwelling	12/10/1984	Issued (See Note 1)

Note	Description
1	Permit issued prior to the Building Act 1991 taking effect. Code Compliance Certificates (CCC) were not required.

Please note that prior to the Building Act 1991; Councils were not required to maintain full records of building consents [etc] issued under the Building Act. While Auckland Council has always endeavoured to maintain full records of pre-Building Act 1991 matters, not all records for this period have survived and in other cases where building work is documented, information may be incomplete. Council does not accept responsibility for any omission.

It is recommended that the Council property file is viewed and compared with the actual building and activities on site to identify any illegal or unauthorised building works or activities.

Compliance Schedules (Building Warrant of Fitness)

The Council has no record of a Compliance Schedule for this property/building.

If it is evident that any specified systems such as lifts or commercial fire alarms are present in the building, the owner must ensure there is a current compliance schedule or building warrant of fitness.

Swimming/Spa Pool Barriers

The Council has no record of a swimming pool or spa pool being registered on this property. Swimming pools and spa pools must have a barrier that complies with the Building Act 2004.

Pool barrier information is available for viewing at <http://www.aucklandcouncil.govt.nz>

Licences

There are NO current licences recorded

s44A(2)(ea) Information notified under Section 124 of the Weathertight Homes Resolution Services Act 2006

The Council has not been notified of any information under Section 124 of the Weathertight Homes Resolution Services Act 2006 relating to this property.

s44A (2)(f) Information relating to the use to which the land may be put and any conditions attached to that use

Purchasers or those intending to develop the land should satisfy themselves that the land is suitable for any intended use or future development proposal. In addition to any site specific limitations recorded below, general restrictions that apply across the region may be relevant to any development proposals on this property.

Auckland Unitary Plan - Operative in Part (AUP:OP)

The **Auckland Unitary Plan - Operative in part(AUP:OP)** applies to this property and should be carefully reviewed and considered, as it may have implications for how this property can be developed and/or used. Those parts of the Auckland Unitary Plan that are operative replace the corresponding parts of legacy regional and district plans. However, certain parts of the AUP:OP are the subject of appeals and have not become operative. If a property is subject to an appeal this will be identified on the attached Unitary Plan Property Summary Report. Where this is the case, both the Auckland Unitary Plan Decisions version and the legacy regional and district plans will need to be considered.

The AUP:OP zones, controls, overlays, precincts, and designations that apply to this property are set out in the Property Summary Report, which is attached to this memorandum.

The AUP:OP can be viewed here:

<https://www.aucklandcouncil.govt.nz/unitaryplan>

The legacy regional and district plans can be viewed here:

<https://www.aucklandcouncil.govt.nz/districtplans>

<https://www.aucklandcouncil.govt.nz/regionalplans>

The appeals to the AUP:OP can be viewed here:

<https://www.aucklandcouncil.govt.nz/unitaryplanappeals>

Auckland Council District Plan - Hauraki Gulf Islands Section (Operative 2013) (DP:HGI)

While the regional provisions in the AUP:OP apply to the Hauraki Gulf Islands, and are set out in the Property Summary Report attached to this memorandum, the AUP:OP does not contain any district provisions for the Hauraki Gulf Islands. If the Property Summary Report attached to this memorandum lists its zone as "Hauraki Gulf Islands", the district provisions that apply are in the Auckland Council District Plan Hauraki Gulf Islands Section (Operative 2013) (**DP:HGI**).

The relevant maps of the DP:HGI are attached to this memorandum, if applicable. The text of the DP:HGI can be found here:

<https://www.aucklandcouncil.govt.nz/aurakigulfislands>

Plan Changes and Notices of Requirement

Changes to the AUP:OP and DP:HGI may be proposed from time to time. These proposed plan changes may relate to either the maps or the text of those plans. Any proposed changes to the AUP:OP relevant to this property will be listed as a modification in the Property Summary Report attached to this memorandum. However, proposed changes to the DP:HGI will not appear on the Property Summary report. That information can be found on the Auckland Council website.

Please refer to the AUP:OP for information on any proposed Plan Changes or see the Auckland Council modifications website at:

<https://www.aucklandcouncil.govt.nz/unitaryplanmodifications>

Information relating to any proposed Plan Changes to DP:HGI can be found here:
<https://www.aucklandcouncil.govt.nz/aurakigulfislands>

From time to time a requiring authority, such as a Ministry of the Crown or a council controlled organisation, may notify Auckland Council that they require certain land to be designated for a certain purpose. If this property is the subject of such a notice of requirement, that notice may have implications for how this property can be developed or used from the date it is received by Council.

If this property is not on the Hauraki Gulf Islands, any notices of requirement applicable will be listed as a modification in the Property Summary Report attached to this memorandum.

If this property is on the Hauraki Gulf Islands, any notice of requirement will be available on the Auckland Council Website.

Information on all current notices of requirement can be found on the modifications page here:
<https://www.aucklandcouncil.govt.nz/unitaryplanmodifications>

Copies of the appeals to the Auckland Unitary Plan can be viewed online at:
<https://www.aucklandcouncil.govt.nz/unitaryplanappeals>

Auckland Unitary Plan

Please note that the Auckland Unitary Plan (Operative in part) applies to this property. The Unitary Plan should be carefully reviewed and considered, as it may have implications for how this property can be developed or used. Parts of the Unitary Plan that are relevant to this property relating to zones, overlays, controls, designations and other restrictions are identified in the Property Summary Report attached to this LIM.

The Unitary Plan can be accessed at Council service centres and libraries and can be found on the following internet page:

<http://www.aucklandcouncil.govt.nz/EN/planspoliciesprojects/plansstrategies/unitaryplan/Pages/home.aspx>

Information concerning Caveat, Bond, Encumbrance, Consent Notice and Covenant

For any information concerning Caveats, Bonds, Encumbrances, Consent Notices or Covenants, please refer to the Certificate of Title for this property.

s44A(2)(g) Information regarding the land which has been notified to Council by another statutory organisation

Waitākere Ranges Heritage Area

This property is located within the Waitākere Ranges Heritage Area as defined in the Waitākere Ranges Heritage Area Act 2008. A link to the Act and further information on the heritage area can be found on the council's website at:

<https://www.aucklandcouncil.govt.nz/arts-culture-heritage/heritage-walks-places/Pages/waitakere-ranges-heritage-area.aspx>

s44A(2)(h) Information regarding the land which has been notified to Council by any network utility operator pursuant to the Building Act 1991 or Building Act 2004

Underground Services and District Plan maps are attached.

Please note: Height restrictions apply where overhead power lines cross the site. Works near water services utilities may require approval. Works near high-pressure Gas, Oil or LPG pipelines create risk of damage and must first be approved. Please contact the relevant Utility provider in your area for further information.

Any escape of gas or liquid from the pipelines is potentially dangerous and requires immediate action as soon as discovered (Dial 111 and ask for the Fire Service).

Attachments

As the placement of the building/s on the attached maps is based on aerial photography we cannot guarantee the accuracy. A formal survey will indicate the exact location of the boundaries.

- Auckland Unitary Plan Property Summary Report
- Auckland Unitary Plan - Operative in part Maps and Map Legend
- Auckland Council District Plan - Hauraki Gulf Islands Section (if applicable)
- Underground Services & Utilities Map and Map Legend
- Special Land Features Map and Map Legend

Please note Map Legends have been created for use across the region and may contain features which were not captured by the previous legacy Councils; therefore the information may not be available for these maps. Please contact the Resource Management Planning Team in your area for further information on any features which may or may not appear on your map.

- Consent Conditions : LUC-1984-4707
- As Built Drainage Plan : 49 Tane Road

Auckland Unitary Plan Operative in part (15th November 2016) Property Summary Report

Address

49 Tane Road Laingholm

Legal Description

LOT 522 DP 22223

Appeals

Modifications

Zones

Residential - Large Lot Zone

Precinct

Controls

Controls: Macroinvertebrate Community Index - Native

Controls: Macroinvertebrate Community Index - Urban

Controls: Stormwater Management Area Control - TITIRANGI / LAINGHOLM 1 - Flow 1

Overlays

Natural Heritage: Ridgeline Protection Overlay - Natural

Natural Heritage: Waitakere Ranges Heritage Area Overlay - Extent of Overlay

Natural Heritage: Waitakere Ranges Heritage Area Overlay - WRHA_06 - Subdivision Schedule

Natural Resources: Significant Ecological Areas Overlay - SEA_T_5539 - Terrestrial

Designations

Designations: Airspace Restriction Designations - ID 1102 - Protection of aeronautical functions - obstacle limitation surfaces - Auckland International Airport Ltd - Confirmed



DISCLAIMER:
This map/plan is illustrative only and all information should be independently verified on site before taking any action.
Copyright Auckland Council. Land Parcel Boundary information from LINZ (Crown Copyright Reserved). Whilst due care has been taken, Auckland Council gives no warranty as to the accuracy and plan completeness of any information on this map/plan and accepts no liability for any error, omission or use of the information. Height datum: Auckland 1946.

Built Environment
49 Tane Road Laingholm
LOT 522 DP 22223

0 7 14 21
Meters
Scale @ A4
= 1:1,000
Date Printed:
28/03/2022



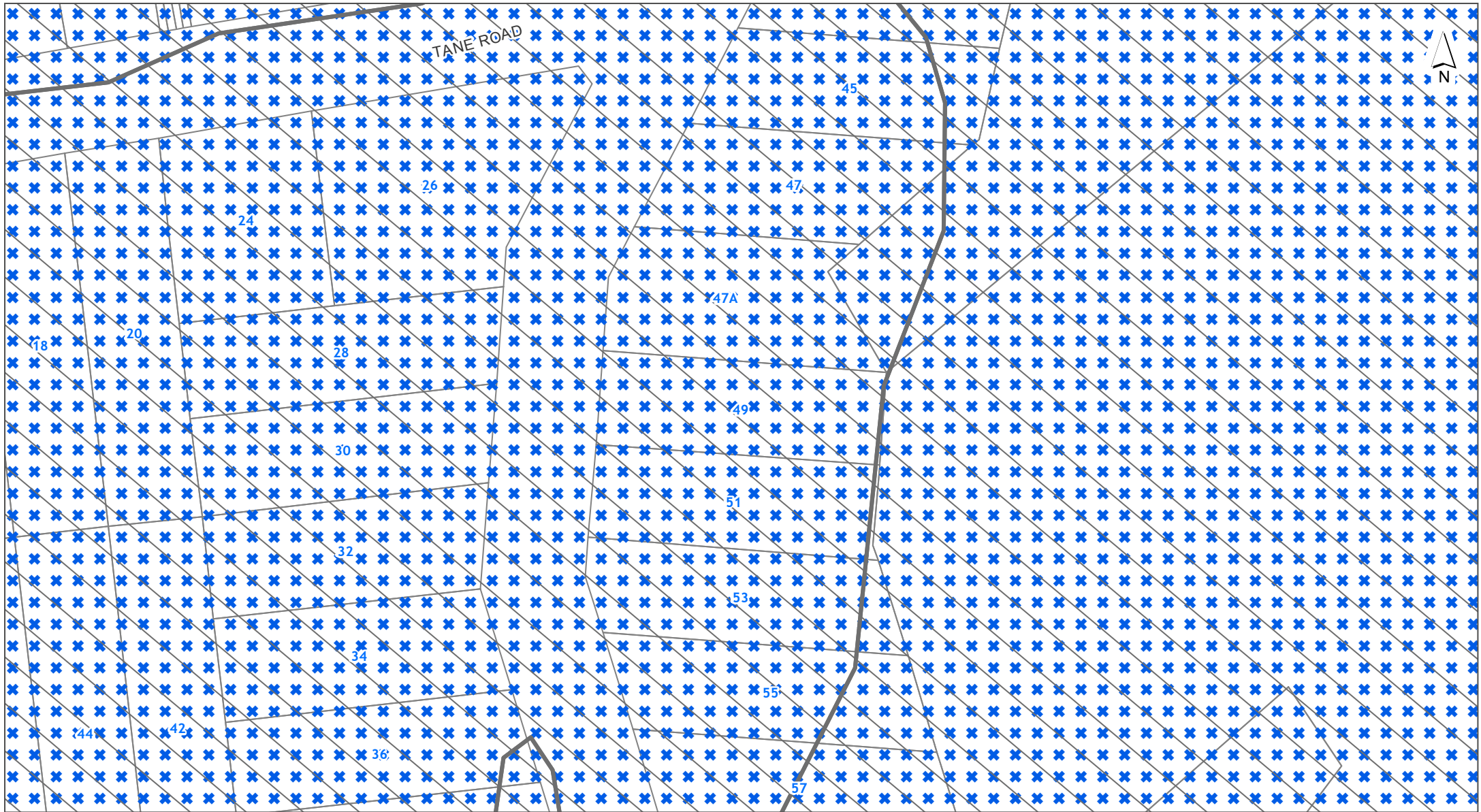

DISCLAIMER:
This map/plan is illustrative only and all information should be independently verified on site before taking any action.
Copyright Auckland Council. Land Parcel Boundary information from LINZ (Crown Copyright Reserved). Whilst due care has been taken, Auckland Council gives no warranty as to the accuracy and plan completeness of any information on this map/plan and accepts no liability for any error, omission or use of the information. Height datum: Auckland 1946.

Controls
49 Tane Road Laingholm
LOT 522 DP 22223



Scale @ A4
= 1:1,000

Date Printed:
28/03/2022



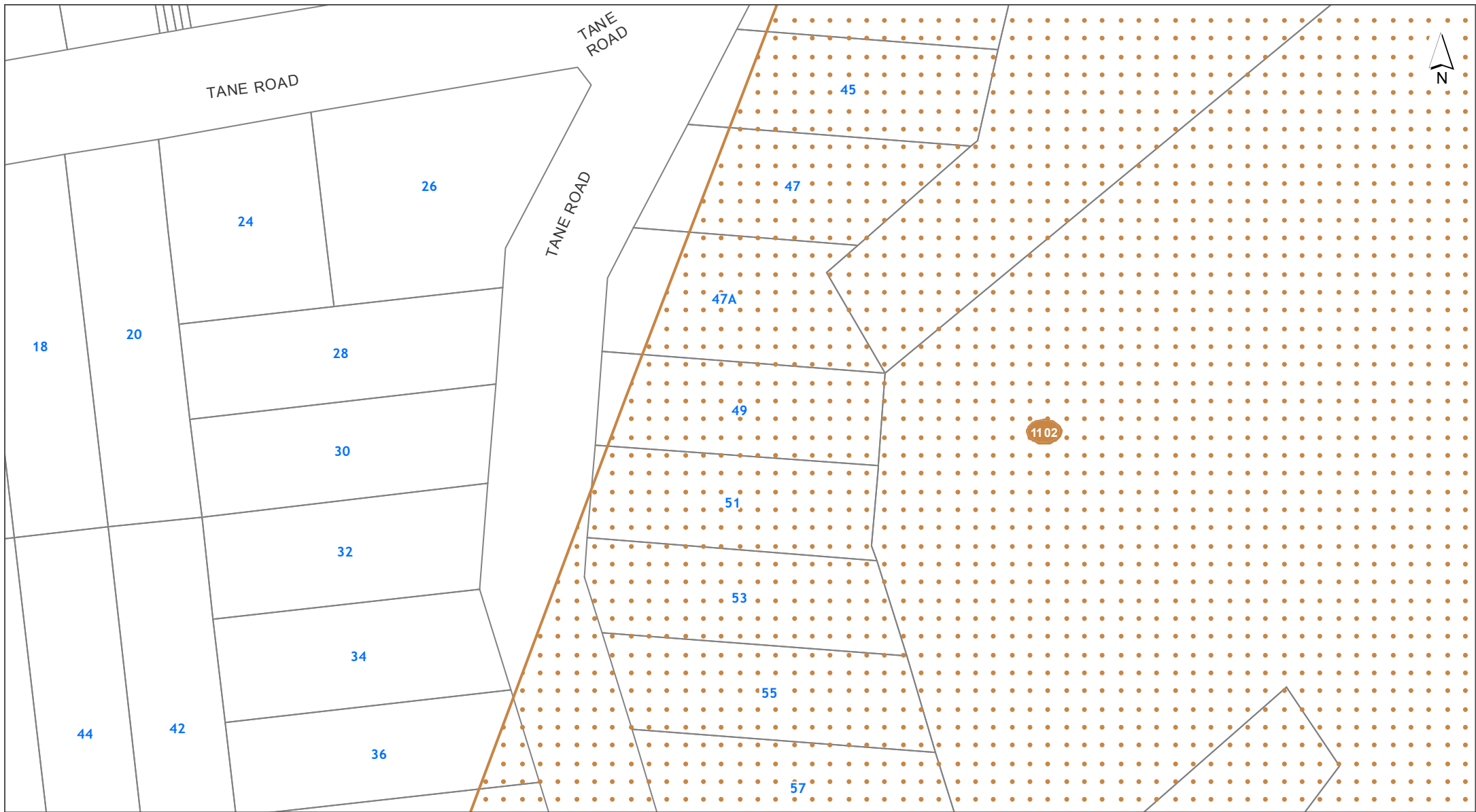

DISCLAIMER:
 This map/plan is illustrative only and all information should be independently verified on site before taking any action.
 Copyright Auckland Council. Land Parcel Boundary information from LINZ (Crown Copyright Reserved). Whilst due care has been taken, Auckland Council gives no warranty as to the accuracy and plan completeness of any information on this map/plan and accepts no liability for any error, omission or use of the information. Height datum: Auckland 1946.

Designations
49 Tane Road Laingholm
LOT 522 DP 22223

0 7 14 21
 Meters
 Scale @ A4
 = 1:1,000
 Date Printed:
 28/03/2022





DISCLAIMER:
This map/plan is illustrative only and all information should be independently verified on site before taking any action.
Copyright Auckland Council. Land Parcel Boundary information from LINZ (Crown Copyright Reserved). Whilst due care has been taken, Auckland Council gives no warranty as to the accuracy and plan completeness of any information on this map/plan and accepts no liability for any error, omission or use of the information. Height datum: Auckland 1946.

Historic Heritage and Special Character
49 Tane Road Laingholm
LOT 522 DP 22223

0 7 14 21
Meters
Scale @ A4
= 1:1,000
Date Printed:
28/03/2022





DISCLAIMER:
This map/plan is illustrative only and all information should be independently verified on site before taking any action.
Copyright Auckland Council. Land Parcel Boundary information from LINZ (Crown Copyright Reserved). Whilst due care has been taken, Auckland Council gives no warranty as to the accuracy and plan completeness of any information on this map/plan and accepts no liability for any error, omission or use of the information. Height datum: Auckland 1946.

Infrastructure
49 Tane Road Laingholm
LOT 522 DP 22223

0 7 14 21
Meters
Scale @ A4
= 1:1,000
Date Printed:
28/03/2022





DISCLAIMER:
This map/plan is illustrative only and all information should be independently verified on site before taking any action.
Copyright Auckland Council. Land Parcel Boundary information from LINZ (Crown Copyright Reserved). Whilst due care has been taken, Auckland Council gives no warranty as to the accuracy and plan completeness of any information on this map/plan and accepts no liability for any error, omission or use of the information. Height datum: Auckland 1946.

Mana Whenua
49 Tane Road Laingholm
LOT 522 DP 22223

0 7 14 21
Meters
Scale @ A4
= 1:1,000
Date Printed:
28/03/2022



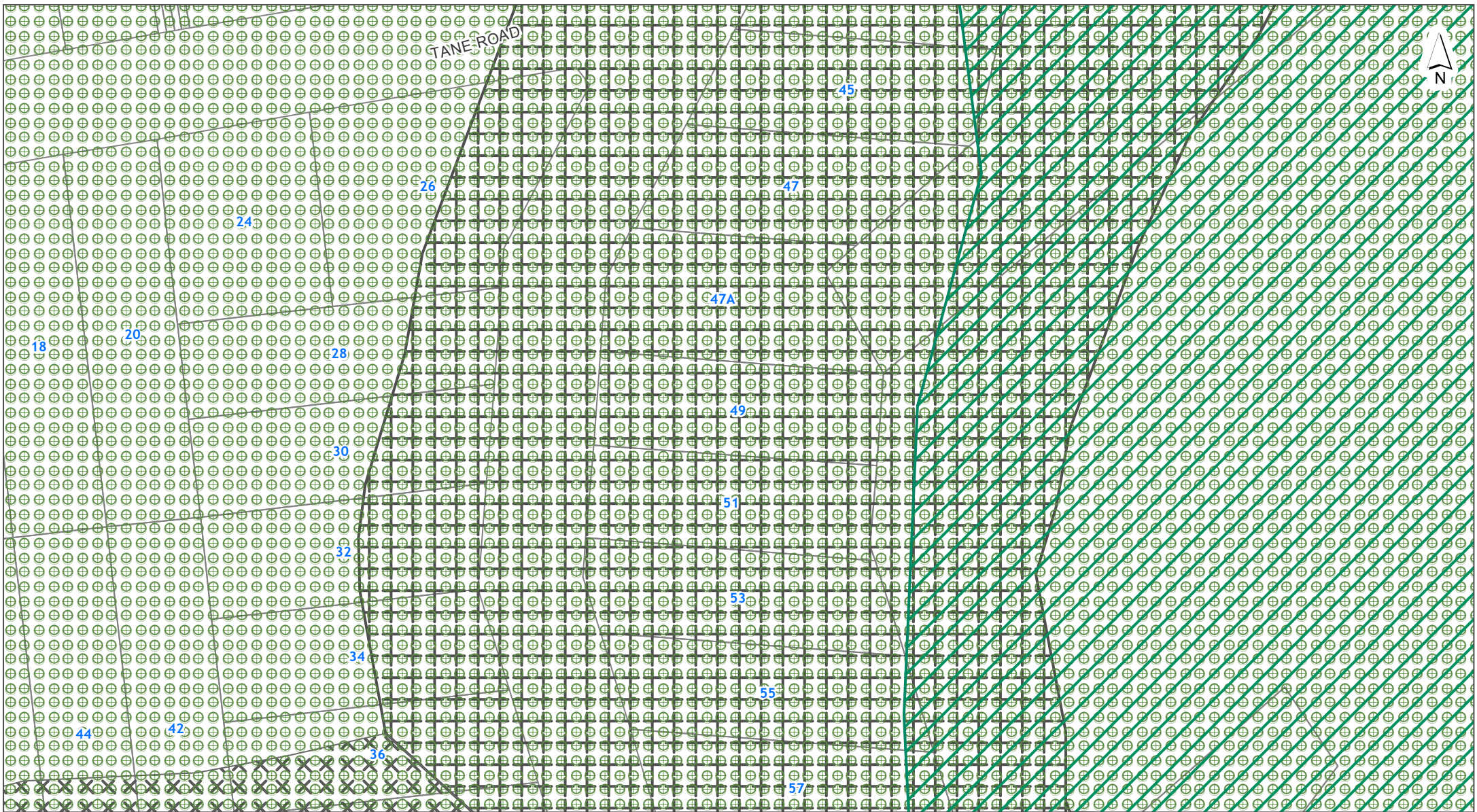

DISCLAIMER:
This map/plan is illustrative only and all information should be independently verified on site before taking any action.
Copyright Auckland Council. Land Parcel Boundary information from LINZ (Crown Copyright Reserved). Whilst due care has been taken, Auckland Council gives no warranty as to the accuracy and plan completeness of any information on this map/plan and accepts no liability for any error, omission or use of the information. Height datum: Auckland 1946.

Natural Heritage
49 Tane Road Laingholm
LOT 522 DP 22223

0 7 14 21
Meters
Scale @ A4
= 1:1,000
Date Printed:
28/03/2022



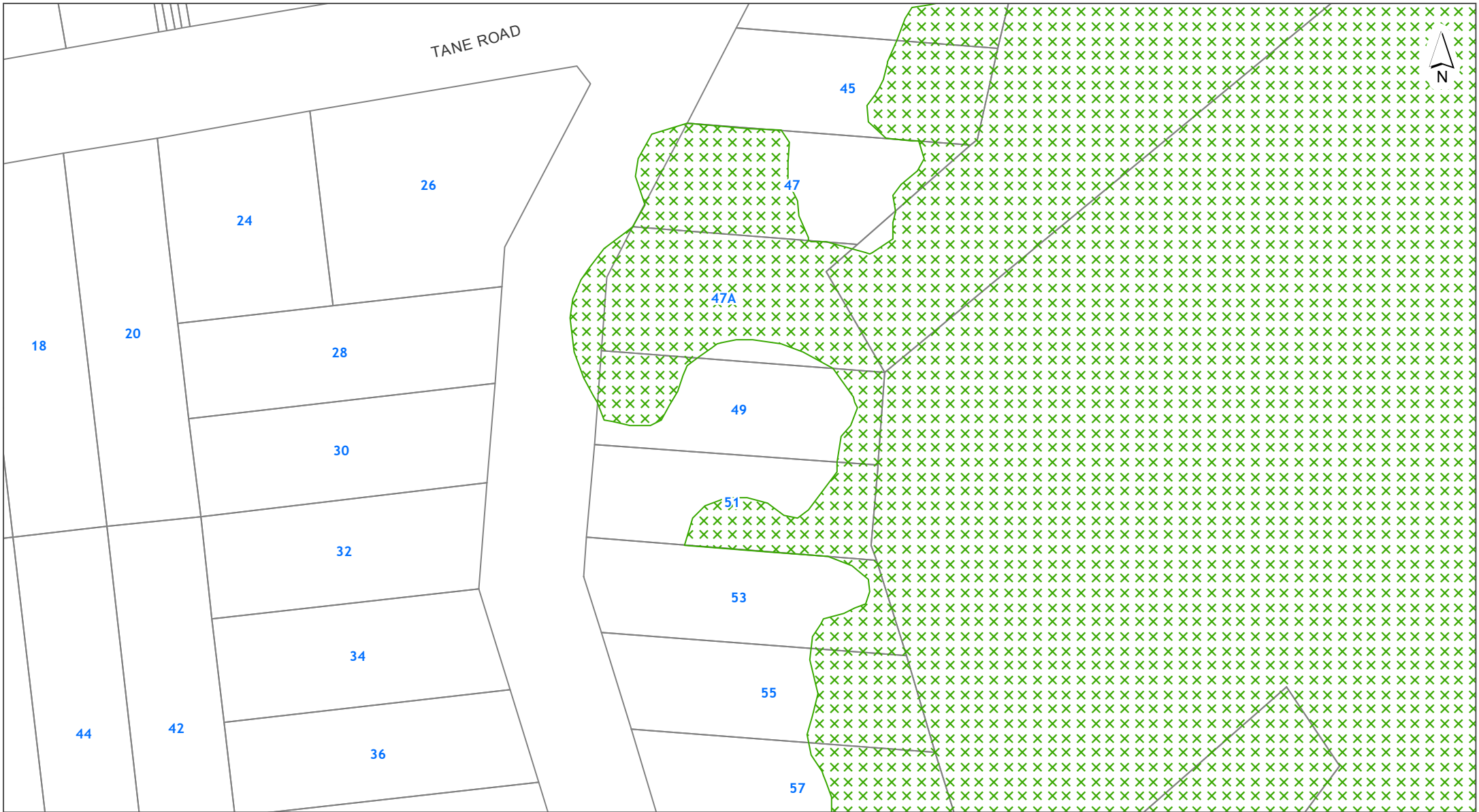

DISCLAIMER:
This map/plan is illustrative only and all information should be independently verified on site before taking any action.
Copyright Auckland Council. Land Parcel Boundary information from LINZ (Crown Copyright Reserved). Whilst due care has been taken, Auckland Council gives no warranty as to the accuracy and plan completeness of any information on this map/plan and accepts no liability for any error, omission or use of the information. Height datum: Auckland 1946.

Natural Resources
49 Tane Road Laingholm
LOT 522 DP 22223

0 7 14 21
Meters
Scale @ A4
= 1:1,000
Date Printed:
28/03/2022





DISCLAIMER:
This map/plan is illustrative only and all information should be independently verified on site before taking any action.
Copyright Auckland Council. Land Parcel Boundary information from LINZ (Crown Copyright Reserved). Whilst due care has been taken, Auckland Council gives no warranty as to the accuracy and plan completeness of any information on this map/plan and accepts no liability for any error, omission or use of the information. Height datum: Auckland 1946.

Precincts
49 Tane Road Laingholm
LOT 522 DP 22223

0 7 14 21
Meters
Scale @ A4
= 1:1,000
Date Printed:
28/03/2022



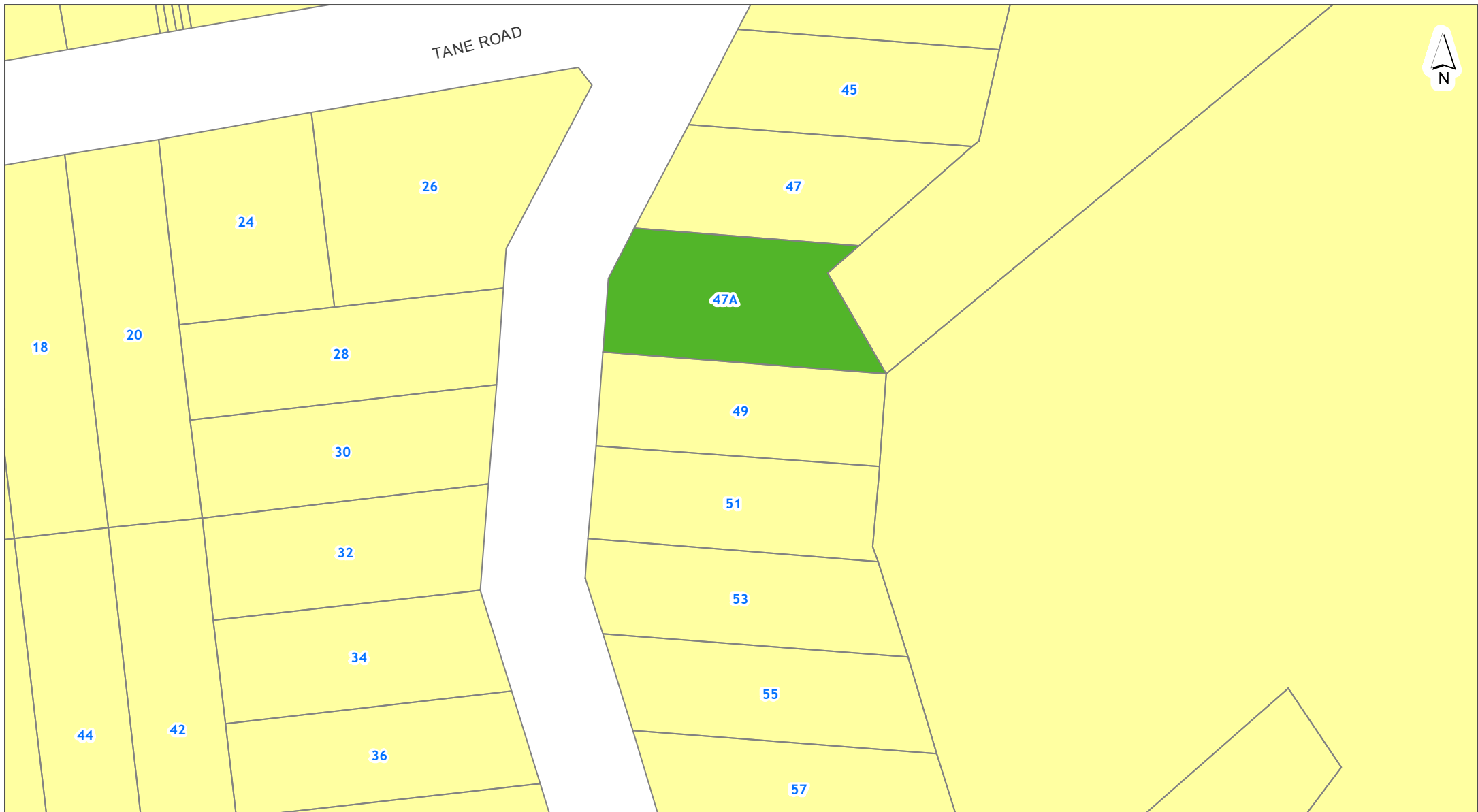

DISCLAIMER:
This map/plan is illustrative only and all information should be independently verified on site before taking any action.
Copyright Auckland Council. Land Parcel Boundary information from LINZ (Crown Copyright Reserved). Whilst due care has been taken, Auckland Council gives no warranty as to the accuracy and plan completeness of any information on this map/plan and accepts no liability for any error, omission or use of the information. Height datum: Auckland 1946.

Zones and Rural Urban Boundary
49 Tane Road Laingholm
LOT 522 DP 22223

0 7 14 21
Meters
Scale @ A4
= 1:1,000
Date Printed:
28/03/2022





NOTATIONS

Appeals to the Proposed Plan

 Appeals seeking changes to zones or management layers

Proposed Plan Modifications to Operative in part Plan

 Notice of Requirements

 Proposed Plan Changes

Tagging of Provisions:

[i] = Information only

[rp] = Regional Plan







[rcp] = Regional Coastal Plan

[rps] = Regional Policy Statement

[dp] = District Plan (only noted when dual provisions apply)

ZONING





Residential

-  Residential - Large Lot Zone
-  Residential - Rural and Coastal Settlement Zone
-  Residential - Single House Zone
-  Residential - Mixed Housing Suburban Zone
-  Residential - Mixed Housing Urban Zone
-  Residential - Terrace Housing and Apartment Buildings Zone







Business

-  Business - City Centre Zone
-  Business - Metropolitan Centre Zone
-  Business - Town Centre Zone
-  Business - Local Centre Zone
-  Business - Neighbourhood Centre Zone
-  Business - Mixed Use Zone
-  Business - General Business Zone
-  Business - Business Park Zone
-  Business - Heavy Industry Zone
-  Business - Light Industry Zone

Open space

-  Open Space - Conservation Zone
-  Open Space - Informal Recreation Zone
-  Open Space - Sport and Active Recreation Zone
-  Open Space - Civic Spaces Zone
-  Open Space - Community Zone
-  Water [i]



Rural

-  Rural - Rural Production Zone
-  Rural - Mixed Rural Zone
-  Rural - Rural Coastal Zone
-  Rural - Rural Conservation Zone
-  Rural - Countryside Living Zone
-  Rural - Waitakere Foothills Zone
-  Rural - Waitakere Ranges Zone

Future Urban

-  Future Urban Zone
-  Green Infrastructure Corridor (Operative in some Special Housing Areas)

Infrastructure

-  Special Purpose Zone - Airports & Airfields
Cemetery
Quarry
Healthcare Facility & Hospital
Tertiary Education
Māori Purpose
Major Recreation Facility
School
-  Strategic Transport Corridor Zone

Coastal

-  Coastal - General Coastal Marine Zone [rcp]
-  Coastal - Marina Zone [rcp/dp]
-  Coastal - Mooring Zone [rcp]
-  Coastal - Minor Port Zone [rcp/dp]
-  Coastal - Ferry Terminal Zone [rcp/dp]
-  Coastal - Defence Zone [rcp]
-  Coastal - Coastal Transition Zone



Precincts

--- Rural Urban Boundary

--- Indicative Coastline [i]

Overlays

Natural Resources

- Terrestrial [rp/dp]
 - Marine 1 [rcp]
 - Marine 2 [rcp]
 - Water Supply Management Areas Overlay [rp]
 - Natural Stream Management Areas Overlay [rp]
 - High-Use Stream Management Areas Overlay [rp]
 - Natural
 - Urban
 - High-Use Aquifer Management Areas Overlay [rp]
 - Quality-Sensitive Aquifer Management Areas Overlay [rp]
 - Wetland Management Areas Overlay [rp]
- } Significant Ecological Areas Overlay

Natural Heritage

- Verified position of tree
 - Unverified position of tree
 - Group of Trees
 - Outstanding Natural Features Overlay [rcp/dp]
 - Outstanding Natural Landscapes Overlay [rcp/dp]
 - Outstanding Natural Character Overlay [rcp/dp]
 - High Natural Character Overlay [rcp/dp]
 - Viewshafts
 - Height Sensitive Areas
 - Regionally Significant Volcanic Viewshafts Overlay Contours [i]
 - Locally Significant Volcanic Viewshafts Overlay [rcp/dp]
 - Locally Significant Volcanic Viewshafts Overlay Contours [i]
 - Modified
 - Natural
 - Local Public Views Overlay [rcp/dp]
 - Extent of Overlay
 - Subdivision Schedule
- } Notable Trees Overlay
- } Regionally Significant Volcanic Viewshafts & Height Sensitive Areas Overlay [rcp/dp]
- } Waitakere Ranges Heritage Area Overlay

Infrastructure

- Airport Approach Surface Overlay
 - Aircraft Noise Overlay
 - City Centre Port Noise Overlay [rcp / dp]
 - Quarry Buffer Area Overlay
 - National Grid Subdivision Corridor
 - National Grid Substation Corridor
 - National Grid Yard Compromised
 - National Grid Yard Uncompromised
- } National Grid Corridor Overlay

Historic Heritage & Special Character

- Historic Heritage Overlay Place [rcp/dp]
- Historic Heritage Overlay Extent of Place [rcp/dp]
- Special Character Areas Overlay Residential and Business
- Auckland War Memorial Museum Viewshaft Overlay [rcp/dp]
- Auckland War Memorial Museum Viewshaft Overlay Contours [i]
- Stockade Hill Viewshaft Overlay – 8m height area
- Stockade Hill Viewshaft [i]

Mana Whenua

- Sites & Places of Significance to Mana Whenua Overlay [rcp/dp]

Built Environment

- Identified Growth Corridor Overlay

Controls

- Key Retail Frontage
 - General Commercial Frontage
 - Adjacent to Level Crossings
 - General
 - Motorway Interchange Control
 - Centre Fringe Office Control
 - Height Variation Control
 - Parking Variation Control
 - Level Crossings With Sightlines Control
 - Arterial Roads
 - Business Park Zone Office Control
- } Building Frontage Control
- } Vehicle Access Restriction Control

- Hazardous Facilities
 - Infrastructure
 - Macroinvertebrate Community Index
 - Flow 1 [rp]
 - Flow 2 [rp]
 - Subdivision Variation Control
 - Indigenous Vegetation 749.7 ha
 - Freshwater Wetland 14.6 ha
 - Surf Breaks [rcp]
 - Cable Protection Areas Control [rcp]
 - Coastal Inundation 1 per cent AEP Plus 1m Control
- } Emergency Management Area Control
- } Stormwater Management Area Control
- } Kawau Island Rural Subdivision SEAs Control

Designations

- Designations

- Airspace Restriction Designations

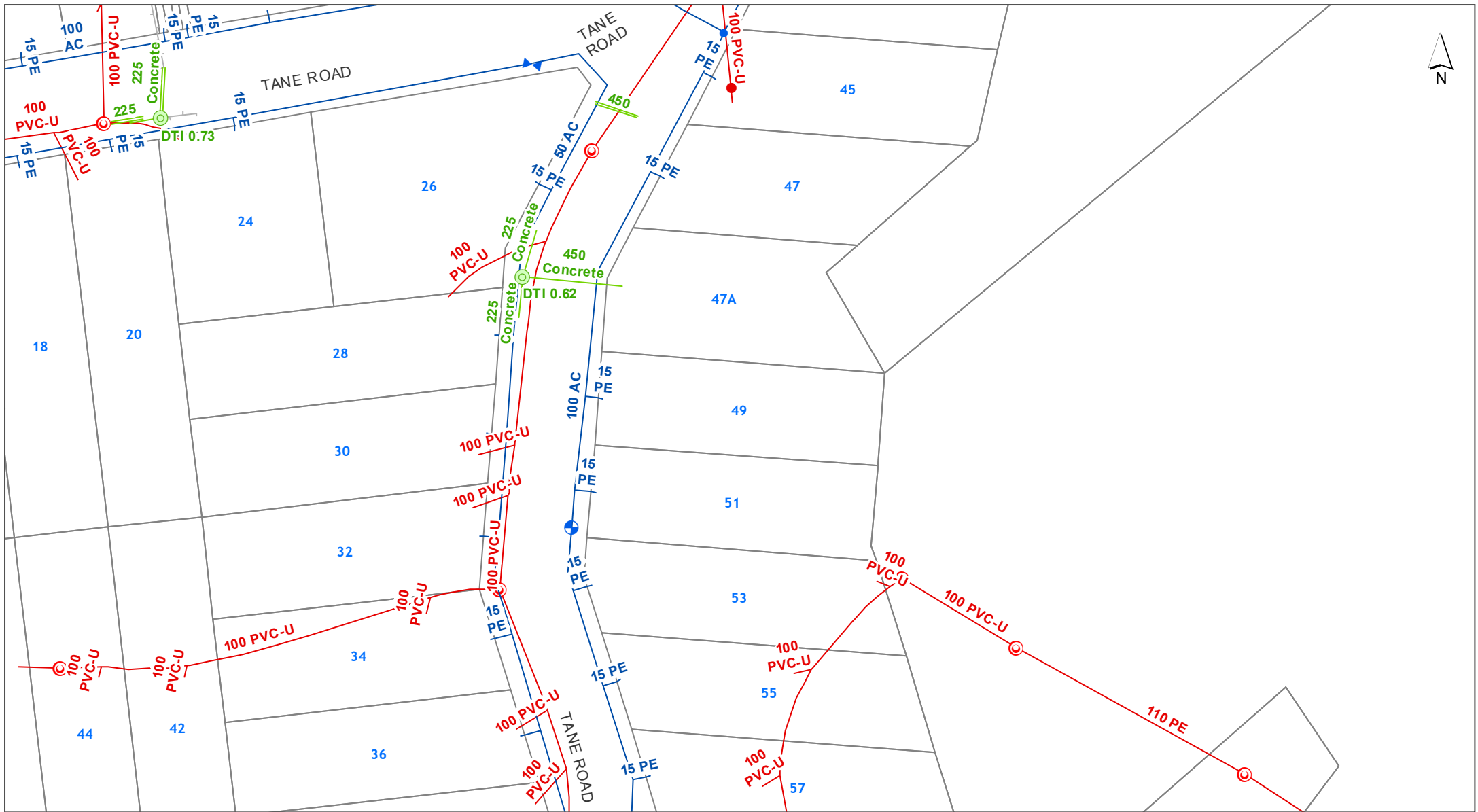

DISCLAIMER:
 This map/plan is illustrative only and all information should be independently verified on site before taking any action.
 Copyright Auckland Council. Land Parcel Boundary information from LINZ (Crown Copyright Reserved). Whilst due care has been taken, Auckland Council gives no warranty as to the accuracy and plan completeness of any information on this map/plan and accepts no liability for any error, omission or use of the information. Height datum: Auckland 1946.

Underground Services
49 Tane Road Laingholm
LOT 522 DP 22223

0 7 14 21
 Meters
 Scale @ A4
 = 1:1,000
 Date Printed:
 28/03/2022



Stormwater

Note: Unless otherwise specified in the text below, the *colour* of a Stormwater symbol is determined by the ownership or usage status, using the following colour scheme:

Public, **Private** or **Abandoned**

- | | | | |
|--|-------------------------------|--|---|
| | Treatment Device | | Overland Flowpath (Public) |
| | Septic Tank | | Overland Flowpath (Private) |
| | Septic Tank (Hi-Tech) | | Forebay (Public) |
| | Soakage System | | Forebay (Private) |
| | Inspection Chamber | | Treatment Facility (Public) |
| | Manhole (Standard / Custom) | | Treatment Facility (Private) |
| | Inlet & Outlet Structure | | Pump Station |
| | Inlet & Outlet (No Structure) | | Planting |
| | Catchpit | | Embankment |
| | Spillway | | Viewing Platform |
| | Safety Benching | | Bridge |
| | Culvert / Tunnel | | Erosion & Flood Control (Other Structure) |
| | Subsoil Drain | | Erosion & Flood Control (Wall Structure) |
| | Gravity Main | | |
| | Rising Main | | |
| | Connection | | |
| | Fence | | |
| | Lined Channel | | |
| | Watercourse | | |

Water

- | | |
|--|--|
| | Valve |
| | Hydrant |
| | Fitting |
| | Other Watercare Point Asset |
| | Other Watercare Linear Asset |
| | Local Pipe (Operational-NonPotable) |
| | Local Pipe (Operational-Potable) |
| | Local Pipe (Operational Not Vested) |
| | Local Pipe (Abandoned / Not Operational) |
| | Transmission Pipe (Operational-NonPotable) |
| | Transmission Pipe (Operational-Potable) |
| | Transmission Pipe (Not Operational) |
| | Transmission Pipe (Proposed) |
| | Pump Station |
| | Reservoir |
| | Other Structure (Local) |
| | Chamber (Transmission) |
| | Water Source (Transmission) |
| | Other Watercare Structures and Areas |

Wastewater

- | | |
|--|--|
| | Fitting |
| | Fitting (Non Watercare) |
| | Manhole |
| | Pipe (Non Watercare) |
| | Local Pipe (Operational) |
| | Local Pipe (Operational Not Vested) |
| | Local Pipe (Abandoned / Not Operational) |
| | Transmission Pipe (Operational) |
| | Transmission Pipe (Not Operational) |
| | Transmission Pipe (Proposed) |
| | Chamber |
| | Structure (Non Watercare) |
| | Pump Station |
| | Wastewater Catchment |

Utilities

- | | |
|--|---|
| | Transpower Site |
| | Pylon (Transpower) |
| | 110 kv - Electricity Transmission |
| | 220 kv - Electricity Transmission |
| | 400 kv - Electricity Transmission |
| | Aviation Jet A1 Fuel Pipeline |
| | Liquid Fuels Pipeline [Marsden to Wiri] |
| | Gas Transmission Pipeline |
| | High-Pressure Gas Pipeline |
| | Medium-Pressure Gas Pipeline |
| | Indicative Steel Mill Slurry Pipeline |
| | Indicative Steel Mill Water Pipeline |
| | Fibre Optic Cable (ARTA) |
| | Contour Interval |

Legend updated: 21/09/2020



DISCLAIMER:
This map/plan is illustrative only and all information should be independently verified on site before taking any action.
Copyright Auckland Council. Land Parcel Boundary information from LINZ (Crown Copyright Reserved). Whilst due care has been taken, Auckland Council gives no warranty as to the accuracy and plan completeness of any information on this map/plan and accepts no liability for any error, omission or use of the information. Height datum: Auckland 1946.

Hazards
49 Tane Road Laingholm
LOT 522 DP 22223

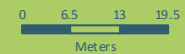

Scale @ A4
= 1:1,000

Date Printed:
28/03/2022



DISCLAIMER:
This map/plan is illustrative only and all information should be independently verified on site before taking any action.
Copyright Auckland Council. Land Parcel Boundary information from LINZ (Crown Copyright Reserved). Whilst due care has been taken, Auckland Council gives no warranty as to the accuracy and plan completeness of any information on this map/plan and accepts no liability for any error, omission or use of the information. Height datum: Auckland 1946.

Natural Hazards - Coastal Erosion ASCIE

49 Tane Road Laingholm

LOT 522 DP 22223

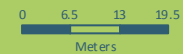

Scale @ A4
= 1:1,000

Date Printed:
28/03/2022



DISCLAIMER:
This map/plan is illustrative only and all information should be independently verified on site before taking any action.
Copyright Auckland Council. Land Parcel Boundary information from LINZ (Crown Copyright Reserved). Whilst due care has been taken, Auckland Council gives no warranty as to the accuracy and plan completeness of any information on this map/plan and accepts no liability for any error, omission or use of the information. Height datum: Auckland 1946.

Natural Hazards - Coastal Inundation

49 Tane Road Laingholm

LOT 522 DP 22223

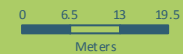

Scale @ A4
= 1:1,000

Date Printed:
28/03/2022



DISCLAIMER:
This map/plan is illustrative only and all information should be independently verified on site before taking any action.
Copyright Auckland Council. Land Parcel Boundary information from LINZ (Crown Copyright Reserved). Whilst due care has been taken, Auckland Council gives no warranty as to the accuracy and plan completeness of any information on this map/plan and accepts no liability for any error, omission or use of the information. Height datum: Auckland 1946.

Natural Hazards - Flooding

49 Tane Road Laingholm

LOT 522 DP 22223

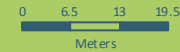

Scale @ A4
= 1:1,000

Date Printed:
28/03/2022





DISCLAIMER:
This map/plan is illustrative only and all information should be independently verified on site before taking any action.
Copyright Auckland Council. Land Parcel Boundary information from LINZ (Crown Copyright Reserved). Whilst due care has been taken, Auckland Council gives no warranty as to the accuracy and plan completeness of any information on this map/plan and accepts no liability for any error, omission or use of the information. Height datum: Auckland 1946.

Natural Hazards - Sea Spray

49 Tane Road Laingholm

LOT 522 DP 22223

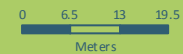

Scale @ A4
= 1:1,000

Date Printed:
28/03/2022



DISCLAIMER:
This map/plan is illustrative only and all information should be independently verified on site before taking any action.
Copyright Auckland Council. Land Parcel Boundary information from LINZ (Crown Copyright Reserved). Whilst due care has been taken, Auckland Council gives no warranty as to the accuracy and plan completeness of any information on this map/plan and accepts no liability for any error, omission or use of the information. Height datum: Auckland 1946.

Natural Hazards - Volcanic Cones

49 Tane Road Laingholm

LOT 522 DP 22223

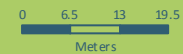

Scale @ A4
= 1:1,000

Date Printed:
28/03/2022



DISCLAIMER:
This map/plan is illustrative only and all information should be independently verified on site before taking any action.
Copyright Auckland Council. Land Parcel Boundary information from LINZ (Crown Copyright Reserved). Whilst due care has been taken, Auckland Council gives no warranty as to the accuracy and plan completeness of any information on this map/plan and accepts no liability for any error, omission or use of the information. Height datum: Auckland 1946.

Other
49 Tane Road Laingholm
LOT 522 DP 22223

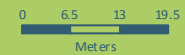

Scale @ A4
= 1:1,000

Date Printed:
28/03/2022



Hazards

Soil Warning Area

-  Fill (Franklin District only)
-  Advisory (Franklin District only)
-  Contamination (Franklin District only)
-  Erosion (Franklin District only)
-  Hazardous Activities & Industries List (HAIL) (Franklin District only)
-  Inundation (Franklin District only)
-  Rainfall Event (Franklin District only)
-  Slippage (Franklin District only)
-  Subsidence (Franklin District only)
-  Slippage / Subsidence / Erosion etc (Auckland City and Papakura District only)
-  Uncertified Fill (Auckland City and Papakura District only)
-  Organic Soil (Auckland City and Papakura District only)
-  Filled / Weak Ground (Auckland City and Papakura District only)
-  Refuse Tips Site / Weak Area (Auckland City and Papakura District only)
-  Unstable / Suspected Ground (Auckland City and Papakura District only)
-  Allochthon Waitemata (Rodney District only)
-  Motatau Complex (Rodney District only)
-  Puriri Mudstone (Rodney District only)
-  Mahurangi Limestone (Rodney District only)
-  Mangakahia Complex (Rodney District only)
-  Hukerenui Mudstone (Rodney District only)
-  Whangai Formation (Rodney District only)
-  Tangihua Complex (Rodney District only)
-  within 150m of Northland Allochthon (Rodney District only)











Hazards

Soil Warning Area continued









-  Soil D (Rodney District only)
-  within 150m of Soil D (Rodney District only)
-  Soil C (Rodney District only)
-  within 150m of Soil C (Rodney District only)
-  Soil B (Rodney District only)
-  within 150m of Soil B (Rodney District only)
-  Soil A (Rodney District only)
-  Gas Main Pipeline
-  Petroleum Pipeline
-  Closed Landfill (Auckland Council owned)
-  Closed Landfill (Privately owned)
-  Air Discharge (Franklin District only)
-  No Soakage (Franklin District only)
-  Indicative Steel Mill Slurry Line 20m Buffer (Franklin District only)
-  Indicative Steel Mill Water Line 20m Buffer (Franklin District only)

Natural Hazards

Overland Flow Path







-  Catchment area 100 Ha and above
-  Catchment area 3 Ha to 100 Ha
-  Catchment area 1 Ha and 3 Ha
-  Catchment area 4000 m² to 1 Ha
-  Catchment area 2000 m² to 4000 m²
-  1% AEP Flood Plain
-  Flood Prone Areas
-  Flood Sensitive Areas
-  Sea Spray
-  Volcanic Cones

Coastal Inundation

-  1% AEP
 -  1% AEP plus 1m sea level rise
 -  1% AEP plus 2m sea level rise
- Areas Susceptible to Coastal Instability and Erosion (ASCIE)**
-  ASCIE 2050 (RCP8.5)
 -  ASCIE 2080 (RCP8.5)
 -  ASCIE 2130 (RCP8.5)
 -  ASCIE 2130 (RCP8.5+)
 -  Marine Area (Based on MHWs10, from Unitary Plan)

Other

Cultural Heritage Index

-  Archaeological Site
-  Hayward and Diamond
-  Historic Botanical Site
-  Historic Structure
-  Maori Heritage Area
-  Maritime Site
-  Reported Historic Site

The information Council holds in relation to Special Land Features differs based on the area a property is located in. Those areas where information is held on a Special Land Feature is denoted in the legend above.

Legend updated: 22/07/2021

APPLICATION UNDER SECTIONS 74 & 75 OF THE
TOWN AND COUNTRY PLANNING ACT 1977

REPORT BY L.A. Thornton- TP FILE: H8/66
DATE 24 September 1984 BPA: 156/7
APPLICANT B.R. & D.G. Conning
ADDRESS OF PROPERTY 49 Tane Road, Laingholm
LEGAL DESCRIPTION LOT 522 DP 22223 AREA: 1000m²
ZONE Residential A
PROPOSED ZONE Non Urban Residential A1
MAP NO. H8
PROPOSAL Erect addition to dwelling (Refer attached plans)

DEPARTURE IS REQUIRED FROM ORDINANCES 5.5:5 AND 11.4:3C
FOLLOWING REASONS:

Proposed additions encroach the 3.0 metre side yard and exceed "daylight over the building" control.

STATUTORY REQUIREMENTS

The applicant's proposed use is one which is provided for as a predominant use in the District Scheme, however as the development does not comply with the relevant bulk and location controls an application is necessary. A development proposal of this nature would until recently have been the subject of a dispensation application under Section 76 of the Town and Country Planning Act 1977. A recent High Court decision however, means that the Ordinances in both the operative and proposed District Schemes dealing with dispensations are probably invalid. This being the case the Council may only grant an exception to the provisions of the operative District Scheme by consenting to a Specified Departure application, in accordance with the provisions of Section 74 of the Act. Principal regard however, should be had to the provisions of the proposed District Scheme which is the paramount planning document now that all objections and appeals to the relevant sections have been settled. In accordance with this Scheme the applicants proposal is a notified application under Section 75 of the Town and Country Planning Act which deals with Works Contrary to a Proposed Change.

However, it is proper when examining the proposal that regard be had to the provisions of Section 74 Specified Departures which would be relevant when the proposed District Scheme becomes operative. This Section provides that Council may consent to a Departure only in certain circumstances, including where:-

STATUTORY REQUIREMENTS (Cont'd)

- (b) The departure is in accord with the effect of a resolution which the Council has passed initiating a change or variation in the scheme, but which is of such urgency as to warrant its immediate authorisation in the public interest without waiting the time involved in completing the change or variation.

At its meeting of 31 July 1984 Council resolved as follows:

"That Scheme Change Number 1 be introduced immediately the reviewed District Scheme becomes operative."

Scheme Change Number 1 as outlined to the Council provides that development which does not comply with the provisions of the District Scheme relating to the height, bulk and location of buildings, be deemed to be a Conditional Use.

The intention of Scheme Change Number 1 is to enable minor infringements of the provisions of the District Scheme to receive the consent of Council, as they did in the past in accordance with the provision of Section 76 Dispensations and Waivers. This change however, cannot be publicly advertised until the proposed District Scheme becomes operative. Clearly it would be undesirable and contrary to the public interest to delay for this reason all development proposals which in some minor manner do not comply with the Scheme, yet comply with its objectives and policies. This being the case, it appears that such proposals can be appropriately considered under Section 74(2)b of the Town and Country Planning Act 1977. In view of the fact that once Scheme Change 1 becomes operative all such proposals will be assessed against the provisions of Section 72 Conditional Uses and the provisions of the Change itself it is proper that regard be had to these matters when assessing this proposal. Section 72 requires Council to have regard to:-

- (a) The suitability of the site for the proposed use, and
- (b) The likely effect of the proposed use on the existing and foreseeable future amenities of the neighbourhood, and on the health, safety, convenience, and the economic, cultural, social and general welfare of the people of the district.

Proposed Scheme Change Number 1 will, among other amendments insert the following into Ordinance 1.2:1, which explains the nature of predominant uses.

Predominant Uses

"The Council shall not grant its consent unless it is satisfied that the result would be better development of the site, or that it is unreasonable or impracticable to enforce the provision in respect of the particular site."

COMMENTS

The applicants seek Council's consent to permit the erection of an addition, comprising two bedrooms, to their dwelling that would fail to comply with "daylight over the building" and yard controls on their site at 49 Tane Road, Laingholm being Lot 522, DP 22223.

The dwelling is sited along the length of the section at a slight angle to the northern side boundary from which the closest point of the dwelling is 2.2 metres. The addition will be constructed onto the western end of the dwelling increasing its length by 3.6 metres and extending it to within 1.6 metres of the side boundary. Due to physical constraints of the site and the siting of the existing development it is not feasible to construct the addition elsewhere and in terms of the internal layout of the dwelling this proposal is most practical.

The addition would incorporate the same design features as the dwelling with 45° pitch roof, clerestory windows and would be of similar materials and finish. The daylight to boundary infringement is caused by the steep crossfall over the width of the site. The northern site boundary is approximately 2.75 metres below the base of the dwelling whereas in relation to the southern site boundary the dwelling has been excavated into the ground. The drive runs between the south side of the dwelling and the southern boundary and is also cut into the slope using retaining walls.

The site to the north is a Council owned plantation reserve which lies below the ground level at the common boundary. This site is unlikely to be used for residential purposes and therefore remain unaffected by the infringement. If the site was re-zoned for residential purposes then a dwelling would need to be designed to suit the site and adjoining development and this would be evident at the time of purchase. Furthermore the applicants site is to the south and the dwelling would not affect sunlight admission to a building on the adjoining site.

RECOMMENDATION

That consent be granted to the application by B.R. & D.G. Conning under Sections 74 and 75 of the Town and Country Planning Act 1977 to erect an addition to the dwelling that would encroach the 3.0 metre side yard and exceed "daylight over the building" control at 49 Tane Road, Laingholm, being Lot 522, DP 22223, for the following reasons:

1. Proposal is the most practical form of development taking into account the physical constraints of the site and the position of the existing dwelling, driveway and septic tank irrigation area.
2. The proposal would encourage better development of the site in that the addition blends in with the dwelling in terms of alignment, design and finish.
3. The adjoining site to the north is a plantation reserve and not likely to be built on, however, in the event that it became available for residential purposes the proposal would not detrimentally affect the site as the applicants site lies to the south and will not reduce sunlight admission.

WAITAKERE CITY COUNCIL

'AS BUILT' DRAINAGE PLAN

Drainage plans are necessary for all new work and extensions to drains, including septic tank effluent disposal systems. The plan is to be completed accurately to scale in ink, and must show clearly street boundary, property boundaries, outline of buildings as well as layout of ALL drains and inspection fittings.

Owner's Name: MR Connings

The scale of the 'As Built' Plan is to be 1:200. Please indicate on the 'As Built' plan if any other scale is used.

Address of Property: (No.) 49 (Street) TAKE RD

Please refer to additional notes overleaf.

Lot 522 D.P. LANGHORN

Drainlayer's Name: J. HOPKINS

ROAD BOUNDARY

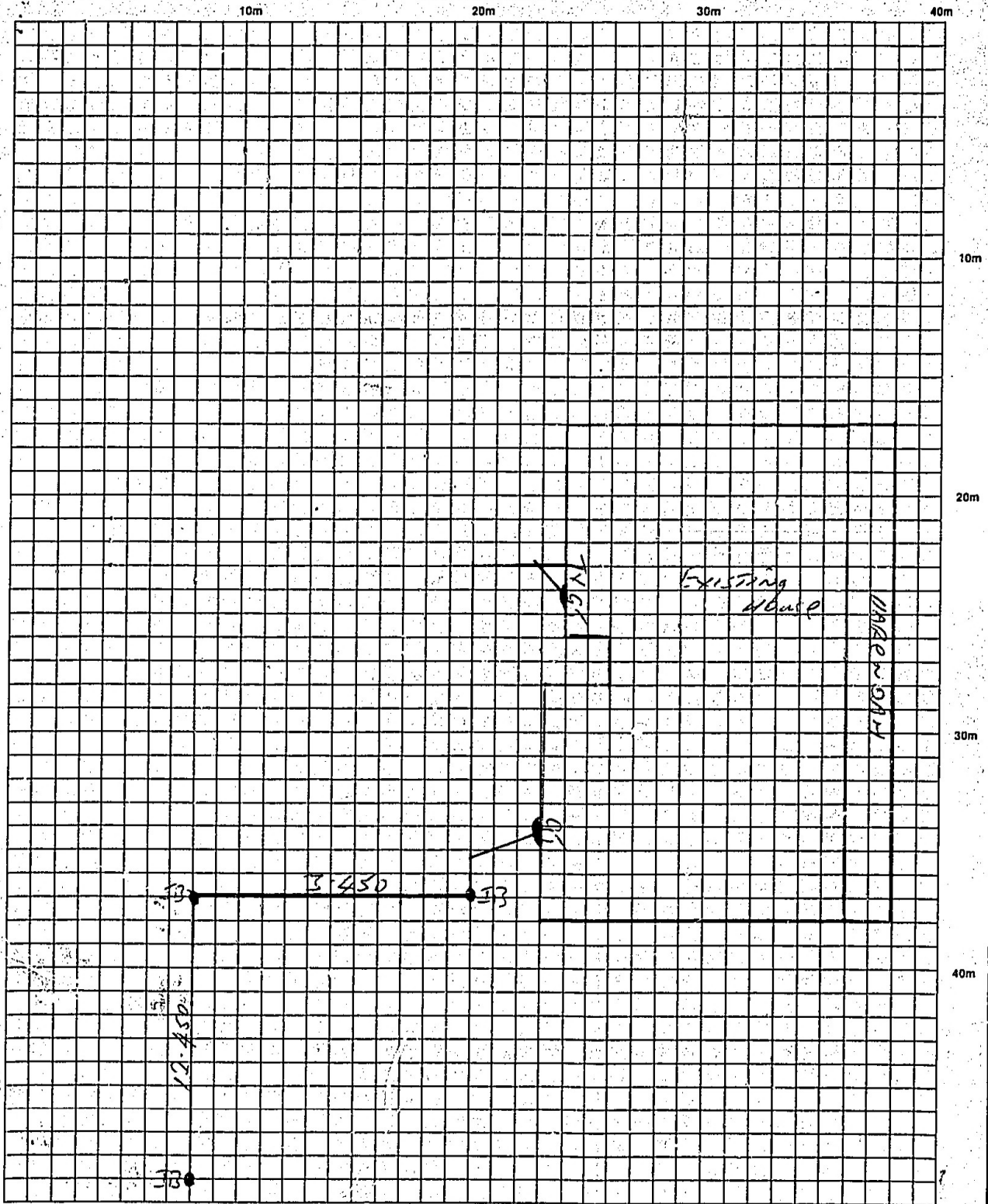

For Office Use Only:—

Drainage Permit No.

Date inspected 15.3.91 Inspector [Signature]

Building Permit No.

GRAPH FOR PLAN:—

Where drainage plans are necessary (see page 2) the graph below is to be completed accurately to scale in ink, and must show clearly street boundary, property boundaries, outline of buildings as well as layout of ALL drains and inspection fittings.

Owner's Name: B. Conroy

Address of Property: 69 TAVIE RD LANGFOLM

Scale: Where possible use 1:200 (one square equals one meter)

Lot 522 D.P. 46443

Otherwise Please Indicate Scale Used.

Drainlayer's Name: WADAMS BELL (Shawdon)

ROAD BOUNDARY

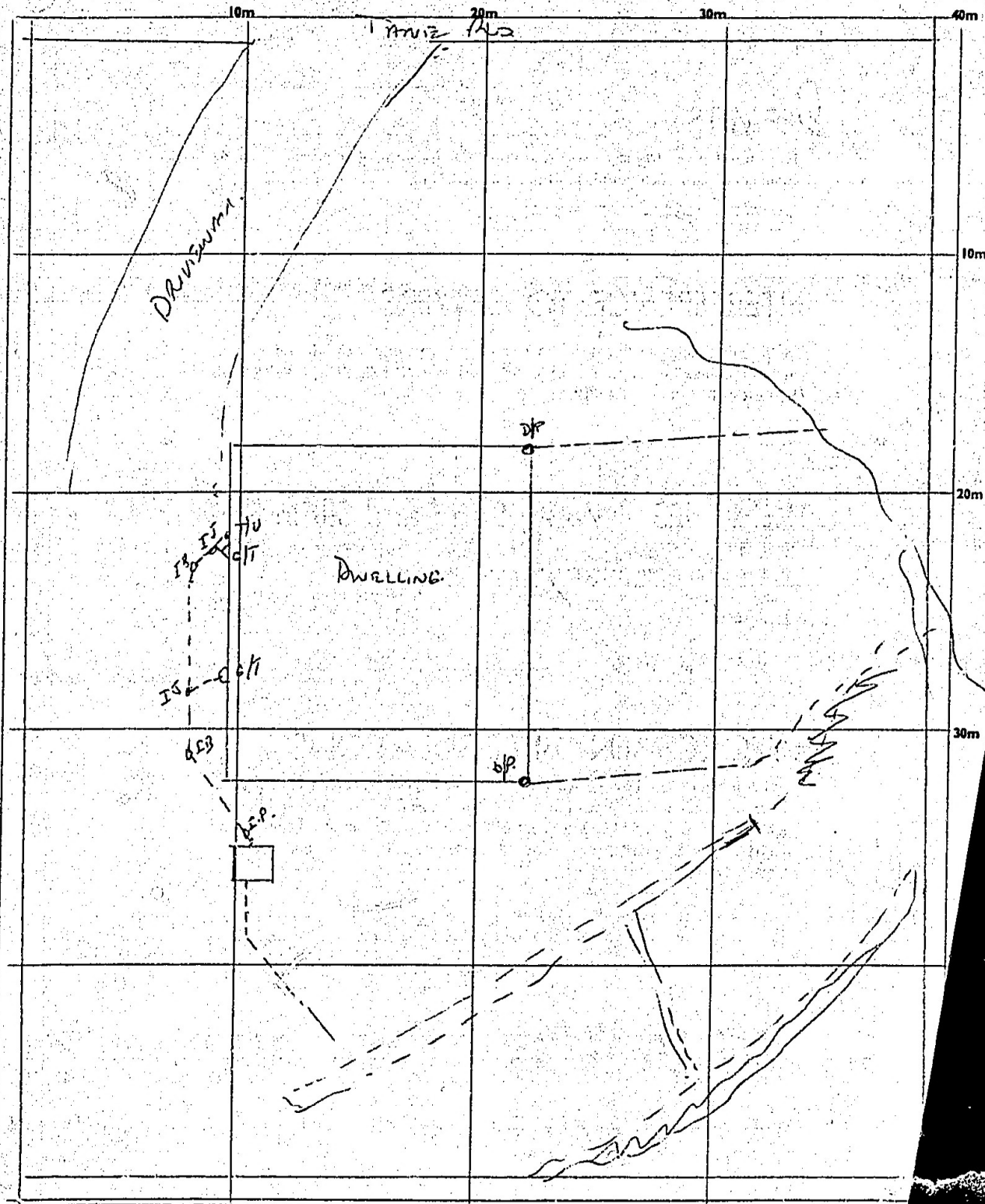

For Office Use Only:—

Drainage Permit No. 2485

Building Permit No. 4141

Remarks:

Date inspected 18/3/76 Inspector [Signature]