

**NOTE: THIS IS A LIVE DOCUMENT THAT CHANGES, PLEASE ENSURE YOU DOWNLOAD THE MOST UP TO DATE VERSION PRIOR TO MAKE AN OFFER OR ATTENDING AN AUCTION.**

**INTEREST: DURING MARKETING CAMPAIGNS DATES AND TIMEFRAMES SOMETIMES CHANGE. IF YOU HAVE NOT MADE US AWARE THAT YOU ARE INTERESTED IN PURSUING THE PROPERTY, WE WILL NOT BE ABLE TO INFORM YOU OF ANY CHANGES AND YOU MAY LOSE OUT.**

31 January 2022

**Re: 41 Western Road, Laingholm**

Thank you for your interest in the above property currently listed with us and for sale by **DEADLINE SALE**.

We have made available to you the following:

- Certificate of Title
- LIM
- Rates information from Auckland Council
- School Zones
- REA Code of Conduct
- REA Guide to Selling and Buying
- Sale & Purchase Agreement

41 Western Road, Laingholm 1576m<sup>2</sup> Lot 253 DP 19098 NA826/29. Zoning: Residential – Large Lot Zone

**THINGS WE WANT TO DRAW YOUR ATTENTION TO:**

**Land Information Memorandum (LIM)**

<b>Wind Zones</b> for this property	Specific engineering design
<b>Soil Issues</b>	30/06/2000 Stability Sensitive: Please note this property was previously shown under the Transitional District Plan as being located in a Stability sensitive area. <i>Stability sensitive - Titirangi and Laingholm is stability sensitive. This means that should you develop the property, you will require an engineer's report.</i>
<b>Flood Plain</b>	This site (property parcel) spatially intersects with a Flood Plain.

<b>Overland Flow Path</b>	This site (property parcel) spatially intersects with one or more Overland Flow Paths.
<b>Exposure Zones</b>	This property is classified as: Zone D High – Coastal areas with high risk of wind-blown sea-spray salt deposits.
<b>Building</b>	BPM-1974-30182 Dwelling 29/07/1974 Issued
<b>Unauthorised building work</b>	20/12/2004 A reference number is not recorded by Council for this type of record REQ-2004-1003: Auckland Council is aware that Unauthorised Works have been carried out on this property - Deck, Workshop enclosed within dwelling, sauna room. For further information, please contact the Western Compliance team.
<b>Waitakere Ranges Heritage Area</b>	This property is located within the Waitākere Ranges Heritage Area as defined in the Waitākere Ranges Heritage Area Act 2008.

**Settlement Date on Offer:** Flexible, discuss with agent.

**Disclosures:**

- An aerial photo has been provided. This is an indicative boundary. The only way to accurately determine the boundary of a property is by obtaining a survey.
- The large garden shed next to the driveway isn't included in the chattels as the vendors will be taking this with them.
- There is a note on the LIM dated 20/12/2004 referring to REQ-2004-1003 Unauthorised building work. Safe and sanitary attached.

We recommend that you get a building inspection report. We also recommend that when purchasing a property, you seek legal advice, complete due diligence and arrange your finance.

This information has been supplied to us by a third party. Accordingly, the Vendor and Austar Realty Limited are merely passing over this information as supplied to us by others. While we have passed on this information supplied by a third party, we have not checked, audited, or reviewed records or documents and therefor to the maximum extent permitted by law neither the Vendor nor Austar Realty Limited or any of its' salespersons or employees accept any responsibility for the accuracy of the materials. Intending purchasers are advised to conduct their own investigation

Regards

Bronwyn Scott-Woods & Adrian Gomez



**The ProAgent Team**

Bronwyn Scott-Woods  
021 613 632 | bronwyn.scott-woods@raywhite.com

Adrian Gomez  
021 839 499 | adrian.gomez@raywhite.com

Austar Realty Ltd Licensed (REAA 2008) | 423 Titirangi Road, Titirangi 0604



**STATEMENT OF PASSING OVER INFORMATION:**

This information has been supplied to us by a third party. Accordingly, the Vendor and Austar Realty Limited are merely passing over this information as supplied to us by others. While we have passed on this information supplied by a third party, we have not checked, audited, or reviewed the records or documents and therefore to the maximum extent permitted by law neither the Vendor nor Austar Realty Limited or any of its' salespersons or employees accept any responsibility for the accuracy of the materials. Intending purchasers are advised to conduct their own investigation.

Austar Realty Ltd  
PO Box 151098  
New Lynn  
AUCKLAND 0640



---

<b>Applicant</b>	Austar Realty Ltd
<b>LIM address</b>	41 Western Road Laingholm
<b>Application number</b>	8270429019
<b>Customer Reference</b>	RAY WHITE TITIRANGI
<b>Date issued</b>	12-Dec-2022
<b>Legal Description</b>	LOT 253 DP 19098
<b>Certificates of title</b>	NA826/29

---

**Disclaimer**

This Land Information Memorandum (LIM) has been prepared for the applicant for the purpose of section 44A of the Local Government Official Information and Meetings Act 1987.

The LIM includes information which:

- Must be included pursuant to section 44A of the Local Government Official Information and Meetings Act 1987
- Council at its discretion considers should be included because it relates to land
- Is considered to be relevant and reliable

This LIM does not include other information:

- Held by council that is not required to be included
- Relating to the land which is unknown to the council
- Held by other organisations which also hold land information

Council has not carried out an inspection of the land and/or buildings for the purpose of preparing this LIM. Council records may not show illegal or unauthorised building or works on the land.

The applicant is solely responsible for ensuring that the land or any building on the land is suitable for a particular purpose and for sourcing other information held by the council or other bodies. In addition, the applicant should check the Certificate of Title as it might also contain obligations relating to the land.

The text and attachments of this document should be considered together.

This Land Information Memorandum is valid as at the date of issue only.

## s44A(2)(a) Information identifying any special feature or characteristics of the land

This information should not be regarded as a full analysis of the site features of this land, as there may be features that the Council is unaware of. The applicant is solely responsible for ensuring that the land is suitable for a particular purpose including development.

### Site Contamination

No land contamination data are available in Council's regulatory records.

### Wind Zones

Wind Zone(s) for this property: Specific engineering design (not covered by NZS 3604:2011)

The wind zones are based on wind speed data specific to all building sites as outlined in NZS 3604:2011. Other factors such as topographic classes, site exposure and ground roughness determine the actual wind bracing demands and bracing elements required for the building.

For further information refer to NZS 3604:2011 Section 5 — Bracing Design

### Soil Issues

Soil issues recorded. The land may not be suitable for particular development or land use purposes. A soil report may be required to/must be submitted with any building and/or resource consent application.

Effective Date	Description	Details
30/06/2000	Stability Sensitive	Please note this property was previously shown under the Transitional District Plan as being located in a Stability sensitive area.

If any soil information/reports have been prepared in relation to this property, they will be available for viewing at an Auckland Council Service Centre.

### Flooding

This statement entitled "Flooding" appears on all LIMs.

Known flooding information is displayed on the map attached to this LIM entitled "Special Land Features – Natural Hazards - Flooding".

The information shown in the "Special Land Features - Natural Hazards - Flooding" map is also shown on the Auckland Council online map viewer (Geomaps), at [www.aucklandcouncil.govt.nz](http://www.aucklandcouncil.govt.nz), which is updated from time to time.

Any proposed development may require a flooding assessment to be provided by the applicant.

The absence of flooding on the "Special Land Features - Natural Hazards - Flooding" map does not exclude the possibility of the site flooding, particularly from Overland Flow Paths which may be on other properties.

### Flood Plain

This site (property parcel) spatially intersects with a Flood Plain, as displayed on the map attached to this LIM entitled “Special Land Features - Natural Hazards - Flooding”, and may flood during significant rainfall events.

Flood Plains represent the predicted area of land inundated by runoff from a 1% Annual Exceedance Probability (AEP) magnitude event, often referred to as a ‘1 in 100-year event’.

Flood Plains are generally determined by computer based hydrological and hydraulic modelling.

The Auckland Unitary Plan contains policies and rules relating to development and/or works within or adjacent to Flood Plains.

Note: The terms “Flood Plain” and “Floodplain” are used interchangeably.

### **Overland Flow Path**

This site (property parcel) spatially intersects with one or more Overland Flow Paths, as displayed on the map attached to this LIM entitled “Special Land Features – Natural Hazards - Flooding”.

Overland Flow Paths are lines representing the predicted route of overland flow, based on analysis of a Digital Terrain Model (derived from aerial laser survey). Overland Flow Paths do not show the width or extent of flow.

Overland Flow Paths are based solely on the terrain and are indicative only.

Overland Flow Paths may flood depending on the amount of rain.

The Auckland Unitary Plan contains policies and rules relating to development and/or works within or adjacent to Overland Flow Paths.

Note: The terms “Flow Path” and “Flowpath” are used interchangeably.

### **Exposure Zones**

New Zealand Standard 3604:2011 classifies all properties in New Zealand into zones based on environmental features including wind, earthquake, snow load and exposure. These zones are relevant to building requirements, such as strength of buildings, materials that should be used and maintenance. All building sites are classified as being in Exposure Zones Extreme Sea Spray, B, C, or D, depending on the severity of exposure to wind driven salt.

This property is classified as: Zone D

High — Coastal areas with high risk of wind-blown sea-spray salt deposits. This is defined as within 500m of the sea including harbours, or 100m from tidal estuaries and sheltered inlets. The coastal area also includes all offshore islands including Waiheke Island, Great Barrier Island. Within each of the zones there are different environmental locations that require fittings and fixtures appropriate to its designation as outlined Tables 4.1 to 4.3 in NZS 3604:2011 being either "closed", "sheltered" or "exposed". For further information refer to NZS 3604:2011 Section 4 — Durability.

### **Coastal Erosion**

This explanation appears on all LIMs, not just sites that may be susceptible to coastal erosion.

The map entitled “Natural Hazards - Coastal Erosion” shows information on potential coastal erosion and resulting land instability, if any, in relation to this site.

Coastal erosion is the wearing away of land due to coastal processes such as waves and currents. Coastal

instability is the movement of land (typically as a landslide) resulting from the loss of support caused by coastal erosion.

Where applicable, the map shows lines that indicate areas susceptible to coastal instability and erosion (ASCIE) within the next 100 years. The lines do not show the future position of the coast. Rather, they show the landward edge of the area that might become unstable as a result of coastal erosion. The area between this line and the sea is considered to be potentially susceptible to erosion, or instability caused by erosion.

The lines represent three timescales, and take into account projected sea level rise based on carbon emission scenarios known as representative concentration pathways (RCP):

- 2050 (0.28 m of sea level rise; RCP 8.5)
- 2080 (0.55 m of sea level rise; RCP 8.5)
- 2130 (1.18 m of sea level rise; RCP 8.5)
- 2130 (1.52 m of sea level rise; RCP 8.5+)

The RCP projections are from the Intergovernmental Panel on Climate Change fifth assessment report (2015), and the related sea level rise values align with Ministry for the Environment Coastal Hazards and Climate Change Guidance for Local Government (2017).

The lines are based on data from a regional study ("Predicting Auckland's Exposure to Coastal Instability and Erosion", available on the Council website). The lines may not take into account local variability, and are not intended for site-specific use.

Development on sites affected by potential coastal erosion may be subject to Auckland Unitary Plan activity controls and may require a detailed coastal hazard assessment report to be completed by a qualified expert.

#### s44A(2)(b) Information on private and public stormwater and sewerage drains

Information on private and public stormwater and sewerage drains is shown on the **underground services map** attached.

Note: Private drainage is the responsibility of the land owner up to and including the point of connection to the public sewer or drain.

#### s44(2)(ba) Information notified to Council by a drinking water supplier under Section 69ZH of the Health Act 1956

Prospective purchasers should be aware of other drinking water systems connected to this property. There may also be private drinking water supply systems such as rainwater tanks or private water bores. You are advised to clarify the drinking water supply with the current landowner.

No Information has been notified to Council.

#### s44A(2)(bb) Information Council holds regarding drinking water supply to the land

For metered water information, please contact **Watercare (09) 442 2222** for services provided to this property.

#### s44A(2)(c) Information relating to any rates owing in relation to the land

<b>Billing Number/ Rate Account:</b>	12341794488
<b>Rates levied for the Year 2022/2023 :</b>	\$2,525.08
<b>Total rates to clear for the current year (including any arrears and postponed rates):</b>	\$1,262.52

The rates figures are provided as at 8 a.m. 12/12/2022. It is strongly advised these are not used for settlement purposes.

s44A(2)(d) Consents, Certificates, Notices, Orders or Requisitions affecting the land or any buildings on the land(da) the information required to be provided to a territorial authority under section 362T(2) of the Building Act 2004:s44A and (2)(e) Information concerning any Certificate issued by a Building Certifier pursuant to the Building Act 1991 or the Building Act 2004

Note: if the land is part of a cross lease title or unit title, consents and permits for the other flats or units may be included in this LIM. If the land has been subdivided there may be consents and permits included that relate to the original property.

It is recommended that the full property file is viewed and compared with the actual building and activities on the land to identify any illegal or unauthorised building works or activities.

### **Financial / development contributions**

---

Financial and development contributions are relevant for recently subdivided land, vacant lots, new residential unit(s) or where there is further development of a site. If any financial or development contribution has not been paid, Council can recover outstanding amount(s) from a subsequent owner of the land.

Please note that financial contributions and development contributions may be paid in land, cash or a combination of these. The form of payment of contributions may be subject to negotiation but final discretion remains with the Council.

### **Resource Management**

---

#### **Planning**

There are **NO** Planning resource consents recorded.

#### **Subdivisions**

There are **NO** Subdivision resource consents recorded.

#### **Engineering Approvals**

There are **NO** Engineering approvals recorded.

If there are any conditions, then only that portion of the consent will be included in the attachments section. The applicant should satisfy themselves as to whether all conditions of resource consents for this property have been met.

## Further Information

The Council may hold additional information for this property, for example concerning resource consents for discharges to air, land or water issued by the former Auckland Regional Council prior to 1 November 2010. If you would like Auckland Council to search for this type of information, please contact us.

## Building

41 Western Road Laingholm

Application No.	Description	Issue Date	Status
BPM-1974-30182	Dwelling	29/07/1974	Issued (See Note 1)

Note	Description
1	Permit issued prior to the Building Act 1991 taking effect. Code Compliance Certificates (CCC) were not required.

Please note that prior to the Building Act 1991; Councils were not required to maintain full records of building consents [etc] issued under the Building Act. While Auckland Council has always endeavoured to maintain full records of pre-Building Act 1991 matters, not all records for this period have survived and in other cases where building work is documented, information may be incomplete. Council does not accept responsibility for any omission.

It is recommended that the Council property file is viewed and compared with the actual building and activities on site to identify any illegal or unauthorised building works or activities.

## Unauthorised Building Works

Prior to the Auckland Council amalgamation, legacy Councils had different processes for dealing with Unauthorised/Unconsented Work. These records are listed below.

From 1<sup>st</sup> August 2011, Independent Building reports or plans, for unauthorised work that was carried out without a permit prior to 1992, may be submitted to Council to be placed on the relevant Property File, subject to payment of a fee. These reports are not included in a LIM.

Effective Date	Reference	Description
20/12/2004	A reference number is not recorded by Council for this type of record	REQ-2004-1003: Auckland Council is aware that Unauthorised Works have been carried out on this property - Deck, Workshop enclosed within dwelling, sauna room. For further information, please contact the Western Compliance team.

## Compliance Schedules (Building Warrant of Fitness)

The Council has no record of a Compliance Schedule for this property/building.

If it is evident that any specified systems such as lifts or commercial fire alarms are present in the building,



the owner must ensure there is a current compliance schedule or building warrant of fitness.

## Swimming/Spa Pool Barriers

---

The Council has no record of a swimming pool or spa pool being registered on this property. Swimming pools and spa pools must have a barrier that complies with the Building Act 2004.

Pool barrier information is available for viewing at <http://www.aucklandcouncil.govt.nz>

## Licences

---

There are NO current licences recorded

### s44A(2)(ea) Information notified under Section 124 of the Weathertight Homes Resolution Services Act 2006

The Council has not been notified of any information under Section 124 of the Weathertight Homes Resolution Services Act 2006 relating to this property.

### s44A (2)(f) Information relating to the use to which the land may be put and any conditions attached to that use

Purchasers or those intending to develop the land should satisfy themselves that the land is suitable for any intended use or future development proposal. In addition to any site specific limitations recorded below, general restrictions that apply across the region may be relevant to any development proposals on this property.

## Auckland Unitary Plan - Operative in Part (AUP:OP)

The **Auckland Unitary Plan - Operative in part(AUP:OP)** applies to this property and should be carefully reviewed and considered, as it may have implications for how this property can be developed and/or used. Those parts of the Auckland Unitary Plan that are operative replace the corresponding parts of legacy regional and district plans. However, certain parts of the AUP:OP are the subject of appeals and have not become operative. If a property is subject to an appeal this will be identified on the attached Unitary Plan Property Summary Report. Where this is the case, both the Auckland Unitary Plan Decisions version and the legacy regional and district plans will need to be considered.

The AUP:OP zones, controls, overlays, precincts, and designations that apply to this property are set out in the Property Summary Report, which is attached to this memorandum.

The AUP:OP can be viewed here:

<https://www.aucklandcouncil.govt.nz/unitaryplan>

The legacy regional and district plans can be viewed here:

<https://www.aucklandcouncil.govt.nz/districtplans>

<https://www.aucklandcouncil.govt.nz/regionalplans>

The appeals to the AUP:OP can be viewed here:

<https://www.aucklandcouncil.govt.nz/unitaryplanappeals>

## Auckland Council District Plan - Hauraki Gulf Islands Section (Operative 2013) (DP:HGI)

While the regional provisions in the AUP:OP apply to the Hauraki Gulf Islands, and are set out in the

Property Summary Report attached to this memorandum, the AUP:OP does not contain any district provisions for the Hauraki Gulf Islands. If the Property Summary Report attached to this memorandum lists its zone as “Hauraki Gulf Islands”, the district provisions that apply are in the Auckland Council District Plan Hauraki Gulf Islands Section (Operative 2013) (**DP:HGI**).

The relevant maps of the DP:HGI are attached to this memorandum, if applicable. The text of the DP:HGI can be found here:

<https://www.aucklandcouncil.govt.nz/aurakigulfislands>

### **Plan Changes and Notices of Requirement**

Changes to the AUP:OP and DP:HGI may be proposed from time to time. These proposed plan changes may relate to either the maps or the text of those plans. Any proposed changes to the AUP:OP relevant to this property will be listed as a modification in the Property Summary Report attached to this memorandum. However, proposed changes to the DP:HGI will not appear on the Property Summary report. That information can be found on the Auckland Council website.

Please refer to the AUP:OP for information on any proposed Plan Changes or see the Auckland Council modifications website at:

<https://www.aucklandcouncil.govt.nz/unitaryplanmodifications>

Information relating to any proposed Plan Changes to DP:HGI can be found here:

<https://www.aucklandcouncil.govt.nz/aurakigulfislands>

From time to time a requiring authority, such as a Ministry of the Crown or a council controlled organisation, may notify Auckland Council that they require certain land to be designated for a certain purpose. If this property is the subject of such a notice of requirement, that notice may have implications for how this property can be developed or used from the date it is received by Council.

If this property is not on the Hauraki Gulf Islands, any notices of requirement applicable will be listed as a modification in the Property Summary Report attached to this memorandum.

If this property is on the Hauraki Gulf Islands, any notice of requirement will be available on the Auckland Council Website.

Information on all current notices of requirement can be found on the modifications page here:

<https://www.aucklandcouncil.govt.nz/unitaryplanmodifications>

Copies of the appeals to the Auckland Unitary Plan can be viewed online at:

<https://www.aucklandcouncil.govt.nz/unitaryplanappeals>

### **Auckland Unitary Plan**

Please note that the Auckland Unitary Plan (Operative in part) applies to this property. The Unitary Plan should be carefully reviewed and considered, as it may have implications for how this property can be developed or used. Parts of the Unitary Plan that are relevant to this property relating to zones, overlays, controls, designations and other restrictions are identified in the Property Summary Report attached to this LIM.

The Unitary Plan can be accessed at Council service centres and libraries and can be found on the following internet page:

<http://www.aucklandcouncil.govt.nz/EN/planspoliciesprojects/plansstrategies/unitaryplan/Pages/home.aspx>

## Information concerning Caveat, Bond, Encumbrance, Consent Notice and Covenant

---

For any information concerning Caveats, Bonds, Encumbrances, Consent Notices or Covenants, please refer to the Certificate of Title for this property.

### s44A(2)(g) Information regarding the land which has been notified to Council by another statutory organisation

#### Waitākere Ranges Heritage Area

This property is located within the Waitākere Ranges Heritage Area as defined in the Waitākere Ranges Heritage Area Act 2008. A link to the Act and further information on the heritage area can be found on the council's website at:

<https://www.aucklandcouncil.govt.nz/arts-culture-heritage/heritage-walks-places/Pages/waitakere-ranges-heritage-area.aspx>

### s44A(2)(h) Information regarding the land which has been notified to Council by any network utility operator pursuant to the Building Act 1991 or Building Act 2004

Underground Services and District Plan maps are attached.

Please note: Height restrictions apply where overhead power lines cross the site. Works near water services utilities may require approval. Works near high-pressure Gas, Oil or LPG pipelines create risk of damage and must first be approved. Please contact the relevant Utility provider in your area for further information.

Any escape of gas or liquid from the pipelines is potentially dangerous and requires immediate action as soon as discovered (Dial 111 and ask for the Fire Service).

## Attachments

As the placement of the building/s on the attached maps is based on aerial photography we cannot guarantee the accuracy. A formal survey will indicate the exact location of the boundaries.

---

- Auckland Unitary Plan Property Summary Report
- Auckland Unitary Plan - Operative in part Maps and Map Legend
- Auckland Council District Plan - Hauraki Gulf Islands Section (if applicable)
- Underground Services & Utilities Map and Map Legend
- Special Land Features Map and Map Legend

Please note Map Legends have been created for use across the region and may contain features which were not captured by the previous legacy Councils; therefore the information may not be available for these maps. Please contact the Resource Management Planning Team in your area for further information on any features which may or may not appear on your map.

## Auckland Unitary Plan Operative in part (15th November 2016) Property Summary Report

### Address

41 Western Road Laingholm

### Legal Description

LOT 253 DP 19098

### Appeals

### Modifications

Plan Changes - Plan Change 78 - Intensification - Multiple Layers - [View PDF](#) - Proposed - 18/08/2022

### Zones

Residential - Large Lot Zone

### Precinct

### Controls

Controls: Macroinvertebrate Community Index - Native

Controls: Macroinvertebrate Community Index - Urban

Controls: Stormwater Management Area Control - TITIRANGI / LAINGHOLM 1 - Flow 1

### Overlays

Natural Heritage: Waitakere Ranges Heritage Area Overlay - Extent of Overlay

Natural Heritage: Waitakere Ranges Heritage Area Overlay - WRHA\_06 - Subdivision Schedule

Natural Resources: Significant Ecological Areas Overlay - SEA\_T\_5539 - Terrestrial

### Designations

Designations: Airspace Restriction Designations - ID 1102 - Protection of aeronautical functions - obstacle limitation surfaces - Auckland International Airport Ltd - Confirmed



DISCLAIMER:  
This map/plan is illustrative only and all information should be independently verified on site before taking any action.  
Copyright Auckland Council. Land Parcel Boundary information from LINZ (Crown Copyright Reserved). Whilst due care has been taken, Auckland Council gives no warranty as to the accuracy and plan completeness of any information on this map/plan and accepts no liability for any error, omission or use of the information. Height datum: Auckland 1946.

**Built Environment**  
**41 Western Road Laingholm**  
**LOT 253 DP 19098**

0 7 14 21  
Meters  
Scale @ A4  
= 1:1,000  
Date Printed:  
12/12/2022



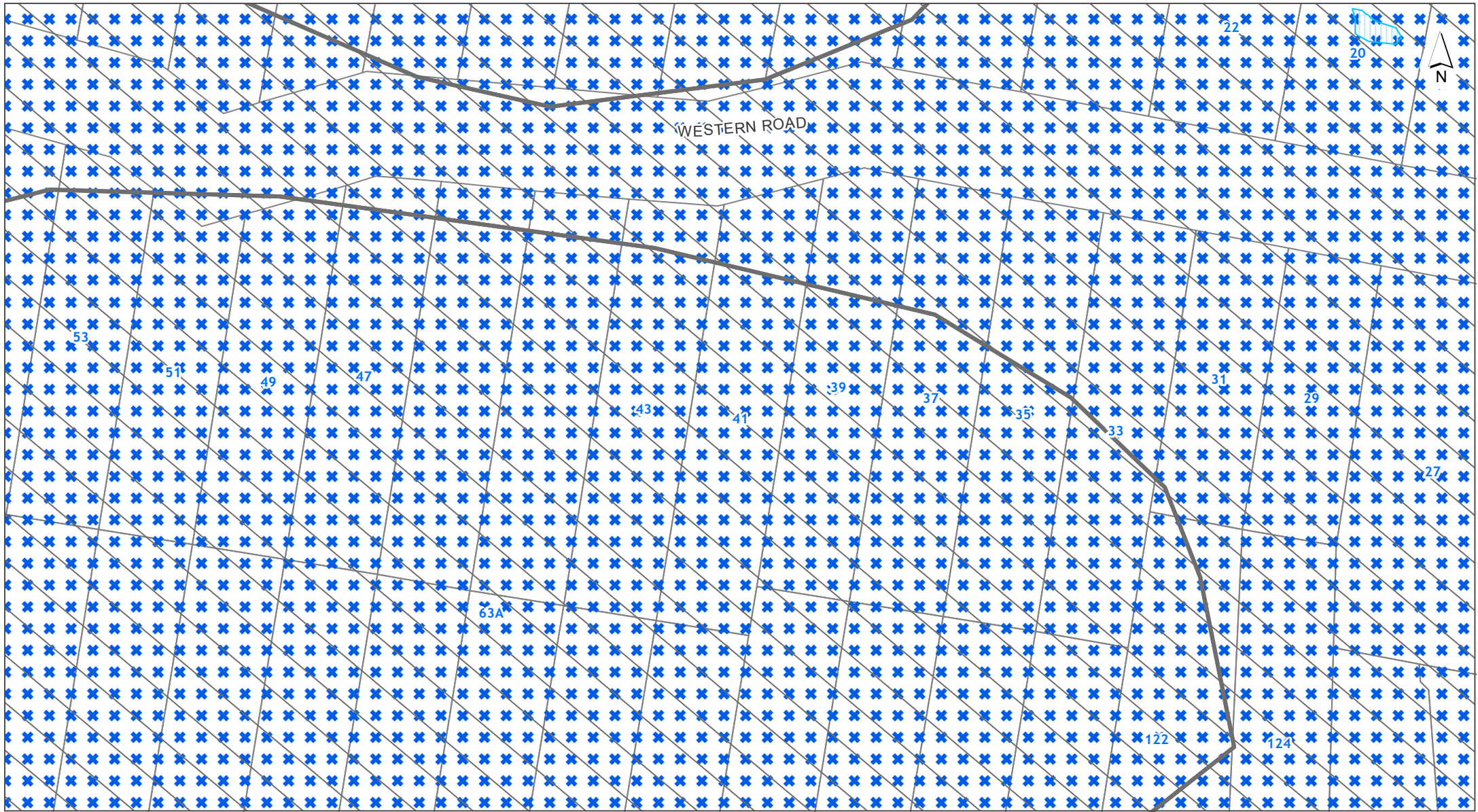

DISCLAIMER:  
This map/plan is illustrative only and all information should be independently verified on site before taking any action.  
Copyright Auckland Council. Land Parcel Boundary information from LINZ (Crown Copyright Reserved). Whilst due care has been taken, Auckland Council gives no warranty as to the accuracy and plan completeness of any information on this map/plan and accepts no liability for any error, omission or use of the information. Height datum: Auckland 1946.

Controls  
41 Western Road Laingholm  
LOT 253 DP 19098



Scale @ A4  
= 1:1,000

Date Printed:  
12/12/2022



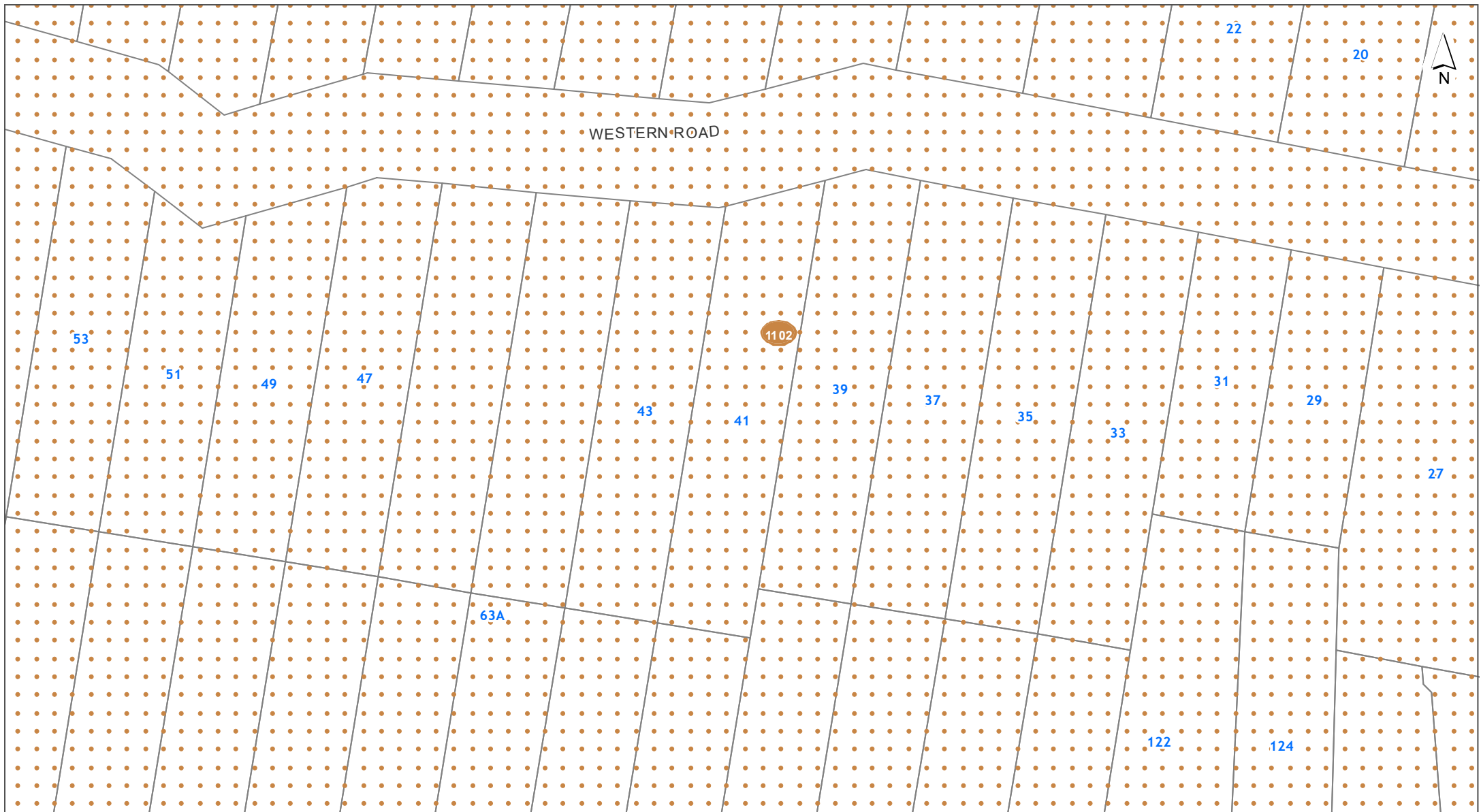

**DISCLAIMER:**  
This map/plan is illustrative only and all information should be independently verified on site before taking any action.  
Copyright Auckland Council. Land Parcel Boundary information from LINZ (Crown Copyright Reserved). Whilst due care has been taken, Auckland Council gives no warranty as to the accuracy and plan completeness of any information on this map/plan and accepts no liability for any error, omission or use of the information. Height datum: Auckland 1946.

**Designations**  
**41 Western Road Laingholm**  
**LOT 253 DP 19098**

0 7 14 21  
Meters  
Scale @ A4  
= 1:1,000  
Date Printed:  
12/12/2022







DISCLAIMER:  
This map/plan is illustrative only and all information should be independently verified on site before taking any action.  
Copyright Auckland Council. Land Parcel Boundary information from LINZ (Crown Copyright Reserved). Whilst due care has been taken, Auckland Council gives no warranty as to the accuracy and plan completeness of any information on this map/plan and accepts no liability for any error, omission or use of the information. Height datum: Auckland 1946.

Historic Heritage and Special Character

41 Western Road Laingholm

LOT 253 DP 19098



Scale @ A4  
= 1:1,000

Date Printed:  
12/12/2022





DISCLAIMER:  
This map/plan is illustrative only and all information should be independently verified on site before taking any action.  
Copyright Auckland Council. Land Parcel Boundary information from LINZ (Crown Copyright Reserved). Whilst due care has been taken, Auckland Council gives no warranty as to the accuracy and plan completeness of any information on this map/plan and accepts no liability for any error, omission or use of the information. Height datum: Auckland 1946.

Infrastructure  
41 Western Road Laingholm  
LOT 253 DP 19098

0 7 14 21  
Meters  
Scale @ A4  
= 1:1,000  
Date Printed:  
12/12/2022





DISCLAIMER:  
This map/plan is illustrative only and all information should be independently verified on site before taking any action.  
Copyright Auckland Council. Land Parcel Boundary information from LINZ (Crown Copyright Reserved). Whilst due care has been taken, Auckland Council gives no warranty as to the accuracy and plan completeness of any information on this map/plan and accepts no liability for any error, omission or use of the information. Height datum: Auckland 1946.

Mana Whenua  
41 Western Road Laingholm  
LOT 253 DP 19098

0 7 14 21  
Meters  
Scale @ A4  
= 1:1,000  
Date Printed:  
12/12/2022



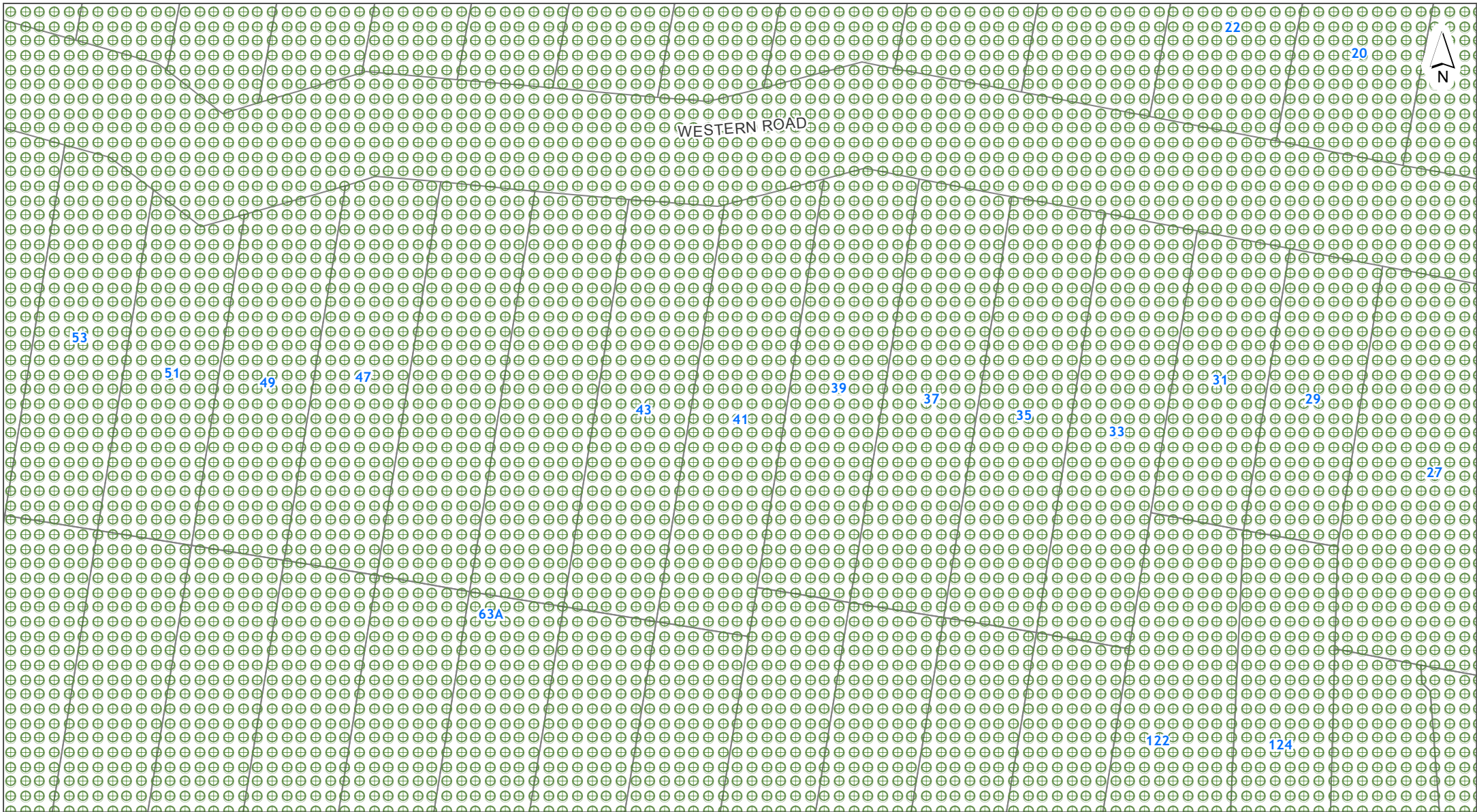

**DISCLAIMER:**  
 This map/plan is illustrative only and all information should be independently verified on site before taking any action.  
 Copyright Auckland Council. Land Parcel Boundary information from LINZ (Crown Copyright Reserved). Whilst due care has been taken, Auckland Council gives no warranty as to the accuracy and plan completeness of any information on this map/plan and accepts no liability for any error, omission or use of the information. Height datum: Auckland 1946.

**Natural Heritage**  
**41 Western Road Laingholm**  
**LOT 253 DP 19098**

0 7 14 21  
 Meters  
 Scale @ A4  
 = 1:1,000  
 Date Printed:  
 12/12/2022



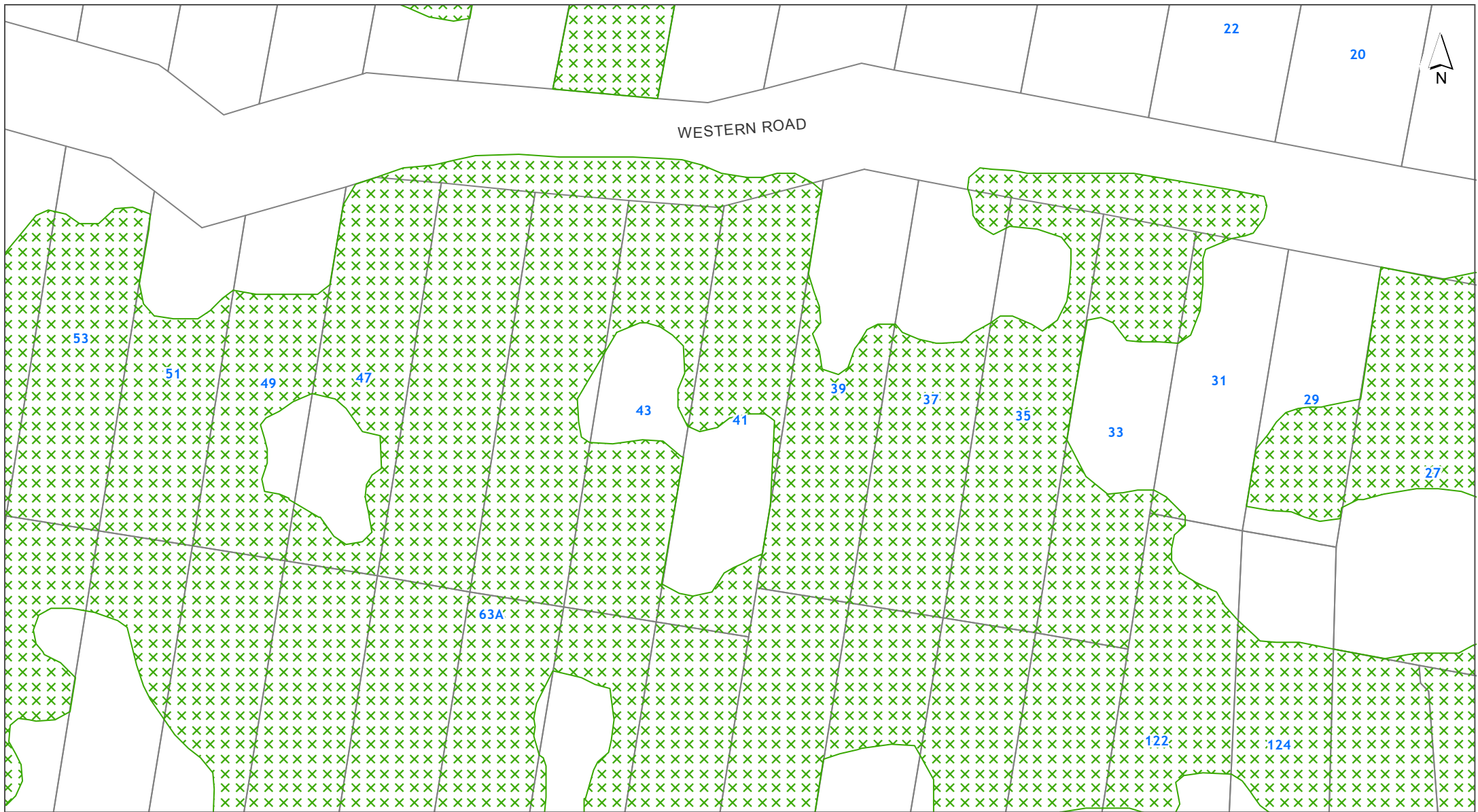

DISCLAIMER:  
This map/plan is illustrative only and all information should be independently verified on site before taking any action.  
Copyright Auckland Council. Land Parcel Boundary information from LINZ (Crown Copyright Reserved). Whilst due care has been taken, Auckland Council gives no warranty as to the accuracy and plan completeness of any information on this map/plan and accepts no liability for any error, omission or use of the information. Height datum: Auckland 1946.

Natural Resources  
41 Western Road Laingholm  
LOT 253 DP 19098

0 7 14 21  
Meters  
Scale @ A4  
= 1:1,000  
Date Printed:  
12/12/2022





DISCLAIMER:  
This map/plan is illustrative only and all information should be independently verified on site before taking any action.  
Copyright Auckland Council. Land Parcel Boundary information from LINZ (Crown Copyright Reserved). Whilst due care has been taken, Auckland Council gives no warranty as to the accuracy and plan completeness of any information on this map/plan and accepts no liability for any error, omission or use of the information. Height datum: Auckland 1946.

Precincts  
41 Western Road Laingholm  
LOT 253 DP 19098

0 7 14 21  
Meters  
Scale @ A4  
= 1:1,000  
Date Printed:  
12/12/2022





DISCLAIMER:  
This map/plan is illustrative only and all information should be independently verified on site before taking any action.  
Copyright Auckland Council. Land Parcel Boundary information from LINZ (Crown Copyright Reserved). Whilst due care has been taken, Auckland Council gives no warranty as to the accuracy and plan completeness of any information on this map/plan and accepts no liability for any error, omission or use of the information. Height datum: Auckland 1946.

Zones and Rural Urban Boundary  
41 Western Road Laingholm  
LOT 253 DP 19098

0 7 14 21  
Meters  
Scale @ A4  
= 1:1,000  
Date Printed:  
12/12/2022



## NOTATIONS

### Appeals to the Proposed Plan

 Appeals seeking changes to zones or management layers

### Proposed Modifications

 Notice of Requirements

 Plan Changes

 Future Coastal Hazards Plan Change

### Tagging of Provisions:

[ i ] = Information only

[ rp ] = Regional Plan



[ rcp ] = Regional Coastal Plan

[ rps ] = Regional Policy Statement

[ dp ] = District Plan (only noted when dual provisions apply)

## ZONING

### Residential

-  Residential - Large Lot Zone
-  Residential - Rural and Coastal Settlement Zone
-  Residential - Single House Zone
-  Residential - Mixed Housing Suburban Zone
-  Residential - Mixed Housing Urban Zone
-  Residential - Terrace Housing and Apartment Buildings Zone







### Business

-  Business - City Centre Zone
-  Business - Metropolitan Centre Zone
-  Business - Town Centre Zone
-  Business - Local Centre Zone
-  Business - Neighbourhood Centre Zone
-  Business - Mixed Use Zone
-  Business - General Business Zone
-  Business - Business Park Zone
-  Business - Heavy Industry Zone
-  Business - Light Industry Zone

### Open space

-  Open Space - Conservation Zone
-  Open Space - Informal Recreation Zone
-  Open Space - Sport and Active Recreation Zone
-  Open Space - Civic Spaces Zone
-  Open Space - Community Zone
-  Water [i]



### Rural

-  Rural - Rural Production Zone
-  Rural - Mixed Rural Zone
-  Rural - Rural Coastal Zone
-  Rural - Rural Conservation Zone
-  Rural - Countryside Living Zone
-  Rural - Waitakere Foothills Zone
-  Rural - Waitakere Ranges Zone

### Future Urban

-  Future Urban Zone
-  Green Infrastructure Corridor (Operative in some Special Housing Areas)

### Infrastructure

-  Special Purpose Zone - Airports & Airfields  
Cemetery  
Quarry  
Healthcare Facility & Hospital  
Tertiary Education  
Māori Purpose  
Major Recreation Facility  
School
-  Strategic Transport Corridor Zone

### Coastal

-  Coastal - General Coastal Marine Zone [rcp]
-  Coastal - Marina Zone [rcp/dp]
-  Coastal - Mooring Zone [rcp]
-  Coastal - Minor Port Zone [rcp/dp]
-  Coastal - Ferry Terminal Zone [rcp/dp]
-  Coastal - Defence Zone [rcp]
-  Coastal - Coastal Transition Zone



Precincts

--- Rural Urban Boundary

--- Indicative Coastline [i]



# Overlays

## Natural Resources

- Terrestrial [rp/dp]
  - Marine 1 [rcp]
  - Marine 2 [rcp]
  - Water Supply Management Areas Overlay [rp]
  - Natural Stream Management Areas Overlay [rp]
  - High-Use Stream Management Areas Overlay [rp]
  - Natural
  - Urban
  - High-Use Aquifer Management Areas Overlay [rp]
  - Quality-Sensitive Aquifer Management Areas Overlay [rp]
  - Wetland Management Areas Overlay [rp]
- } Significant Ecological Areas Overlay

## Natural Heritage

- Verified position of tree
  - Unverified position of tree
  - Group of Trees
  - Outstanding Natural Features Overlay [rcp/dp]
  - Outstanding Natural Landscapes Overlay [rcp/dp]
  - Outstanding Natural Character Overlay [rcp/dp]
  - High Natural Character Overlay [rcp/dp]
  - Viewshafts
  - Height Sensitive Areas
  - Regionally Significant Volcanic Viewshafts Overlay Contours [i]
  - Locally Significant Volcanic Viewshafts Overlay [rcp/dp]
  - Locally Significant Volcanic Viewshafts Overlay Contours [i]
  - Modified
  - Natural
  - Local Public Views Overlay [rcp/dp]
  - Extent of Overlay
  - Subdivision Schedule
- } Notable Trees Overlay
- } Regionally Significant Volcanic Viewshafts & Height Sensitive Areas Overlay [rcp/dp]
- } Waitakere Ranges Heritage Area Overlay

## Infrastructure

- Airport Approach Surface Overlay
  - Aircraft Noise Overlay
  - City Centre Port Noise Overlay [rcp / dp]
  - Quarry Buffer Area Overlay
  - National Grid Subdivision Corridor
  - National Grid Substation Corridor
  - National Grid Yard Compromised
  - National Grid Yard Uncompromised
- } National Grid Corridor Overlay

## Historic Heritage & Special Character

- Historic Heritage Overlay Place [rcp/dp]
- Historic Heritage Overlay Extent of Place [rcp/dp]
- Special Character Areas Overlay Residential and Business
- Auckland War Memorial Museum Viewshaft Overlay [rcp/dp]
- Auckland War Memorial Museum Viewshaft Overlay Contours [i]
- Stockade Hill Viewshaft Overlay – 8m height area
- Stockade Hill Viewshaft [i]

## Mana Whenua

- Sites & Places of Significance to Mana Whenua Overlay [rcp/dp]

## Built Environment

- Identified Growth Corridor Overlay

# Controls

- Key Retail Frontage
  - General Commercial Frontage
  - Adjacent to Level Crossings
  - General
  - Motorway Interchange Control
  - Centre Fringe Office Control
  - Height Variation Control
  - Parking Variation Control
  - Level Crossings With Sightlines Control
  - Arterial Roads
  - Business Park Zone Office Control
- } Building Frontage Control
- } Vehicle Access Restriction Control

- Hazardous Facilities
  - Infrastructure
  - Macroinvertebrate Community Index
  - Flow 1 [rp]
  - Flow 2 [rp]
  - Subdivision Variation Control
  - Indigenous Vegetation 749.7 ha
  - Freshwater Wetland 14.6 ha
  - Surf Breaks [rcp]
  - Cable Protection Areas Control [rcp]
  - Coastal Inundation 1 per cent AEP Plus 1m Control
- } Emergency Management Area Control
- } Stormwater Management Area Control
- } Kawau Island Rural Subdivision SEAs Control

# Designations

- Designations

- Airspace Restriction Designations

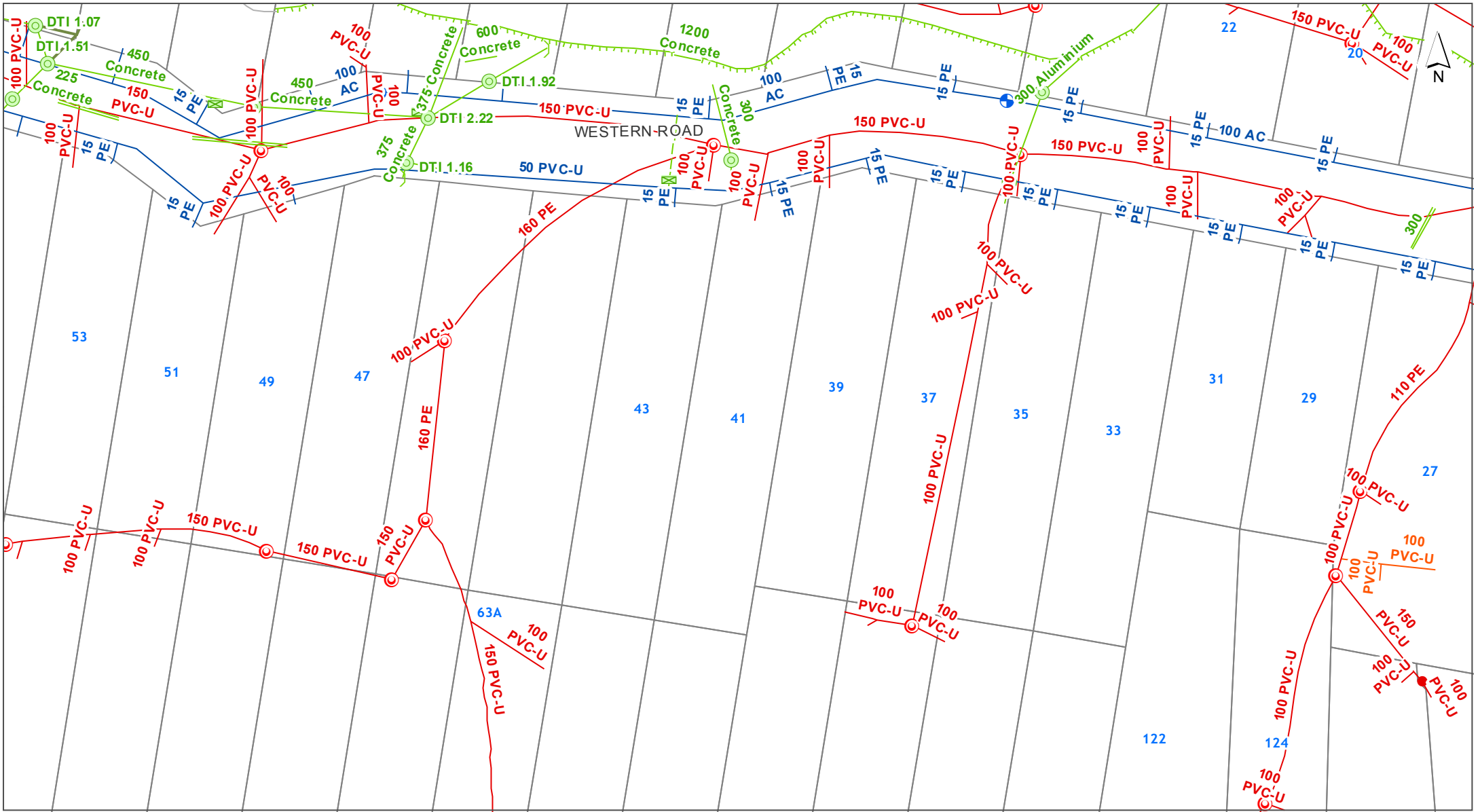

DISCLAIMER:  
 This map/plan is illustrative only and all information should be independently verified on site before taking any action.  
 Copyright Auckland Council. Land Parcel Boundary information from LINZ (Crown Copyright Reserved). Whilst due care has been taken, Auckland Council gives no warranty as to the accuracy and plan completeness of any information on this map/plan and accepts no liability for any error, omission or use of the information. Height datum: Auckland 1946.

**Underground Services**  
**41 Western Road Laingholm**  
**LOT 253 DP 19098**

0 7 14 21  
 Meters  
 Scale @ A4  
 = 1:1,000  
 Date Printed:  
 12/12/2022



Stormwater

Note: Unless otherwise specified in the text below, the *colour* of a Stormwater symbol is determined by the ownership or usage status, using the following colour scheme:

**Public**, **Private** or **Abandoned**

- |  |                               |  |   |
|--|-------------------------------|--|---|
|  | Treatment Device              |  | Overland Flowpath (Public)                |
|  | Septic Tank                   |  | Overland Flowpath (Private)               |
|  | Septic Tank (Hi-Tech)         |  | Forebay (Public)                          |
|  | Soakage System                |  | Forebay (Private)                         |
|  | Inspection Chamber            |  | Treatment Facility (Public)               |
|  | Manhole (Standard / Custom)   |  | Treatment Facility (Private)              |
|  | Inlet & Outlet Structure      |  | Pump Station                              |
|  | Inlet & Outlet (No Structure) |  | Planting                                  |
|  | Catchpit                      |  | Embankment                                |
|  | Spillway                      |  | Viewing Platform                          |
|  | Safety Benching               |  | Bridge                                    |
|  | Culvert / Tunnel              |  | Erosion & Flood Control (Other Structure) |
|  | Subsoil Drain                 |  | Erosion & Flood Control (Wall Structure)  |
|  | Gravity Main                  |  |   |
|  | Rising Main                   |  |   |
|  | Connection                    |  |   |
|  | Fence                         |  |   |
|  | Lined Channel                 |  |   |
|  | Watercourse                   |  |   |

Water

- |  |  |
|--|--|
|  | Valve                                      |
|  | Hydrant                                    |
|  | Fitting                                    |
|  | Other Watercare Point Asset                |
|  | Other Watercare Linear Asset               |
|  | Local Pipe (Operational-NonPotable)        |
|  | Local Pipe (Operational-Potable)           |
|  | Local Pipe (Operational Not Vested)        |
|  | Local Pipe (Abandoned / Not Operational)   |
|  | Transmission Pipe (Operational-NonPotable) |
|  | Transmission Pipe (Operational-Potable)    |
|  | Transmission Pipe (Not Operational)        |
|  | Transmission Pipe (Proposed)               |
|  | Pump Station                               |
|  | Reservoir                                  |
|  | Other Structure (Local)                    |
|  | Chamber (Transmission)                     |
|  | Water Source (Transmission)                |
|  | Other Watercare Structures and Areas       |

Wastewater

- |  |  |
|--|--|
|  | Fitting                                  |
|  | Fitting (Non Watercare)                  |
|  | Manhole                                  |
|  | Pipe (Non Watercare)                     |
|  | Local Pipe (Operational)                 |
|  | Local Pipe (Operational Not Vested)      |
|  | Local Pipe (Abandoned / Not Operational) |
|  | Transmission Pipe (Operational)          |
|  | Transmission Pipe (Not Operational)      |
|  | Transmission Pipe (Proposed)             |
|  | Chamber                                  |
|  | Structure (Non Watercare)                |
|  | Pump Station                             |
|  | Wastewater Catchment                     |

Utilities

- |  |   |
|--|---|
|  | Transpower Site                         |
|  | Pylon (Transpower)                      |
|  | 110 kv - Electricity Transmission       |
|  | 220 kv - Electricity Transmission       |
|  | 400 kv - Electricity Transmission       |
|  | Aviation Jet A1 Fuel Pipeline           |
|  | Liquid Fuels Pipeline [Marsden to Wiri] |
|  | Gas Transmission Pipeline               |
|  | High-Pressure Gas Pipeline              |
|  | Medium-Pressure Gas Pipeline            |
|  | Indicative Steel Mill Slurry Pipeline   |
|  | Indicative Steel Mill Water Pipeline    |
|  | Fibre Optic Cable (ARTA)                |
|  | Contour Interval                        |

Legend updated: 21/09/2020



**DISCLAIMER:**  
This map/plan is illustrative only and all information should be independently verified on site before taking any action.  
Copyright Auckland Council. Land Parcel Boundary information from LINZ (Crown Copyright Reserved). Whilst due care has been taken, Auckland Council gives no warranty as to the accuracy and plan completeness of any information on this map/plan and accepts no liability for any error, omission or use of the information. Height datum: Auckland 1946.

**Hazards**  
**41 Western Road Laingholm**  
**LOT 253 DP 19098**

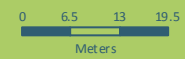

**Scale @ A4**  
**= 1:1,000**  
**Date Printed:**  
**12/12/2022**





**DISCLAIMER:**  
This map/plan is illustrative only and all information should be independently verified on site before taking any action.  
Copyright Auckland Council. Land Parcel Boundary information from LINZ (Crown Copyright Reserved). Whilst due care has been taken, Auckland Council gives no warranty as to the accuracy and plan completeness of any information on this map/plan and accepts no liability for any error, omission or use of the information. Height datum: Auckland 1946.

**Natural Hazards - Coastal Erosion ASCIE**

**41 Western Road Laingholm**

**LOT 253 DP 19098**

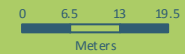

**Scale @ A4  
= 1:1,000**

**Date Printed:  
12/12/2022**





**DISCLAIMER:**  
This map/plan is illustrative only and all information should be independently verified on site before taking any action.  
Copyright Auckland Council. Land Parcel Boundary information from LINZ (Crown Copyright Reserved). Whilst due care has been taken, Auckland Council gives no warranty as to the accuracy and plan completeness of any information on this map/plan and accepts no liability for any error, omission or use of the information. Height datum: Auckland 1946.

**Natural Hazards - Coastal Inundation**

**41 Western Road Laingholm**

**LOT 253 DP 19098**

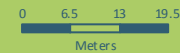

**Scale @ A4**  
**= 1:1,000**

**Date Printed:**  
**12/12/2022**



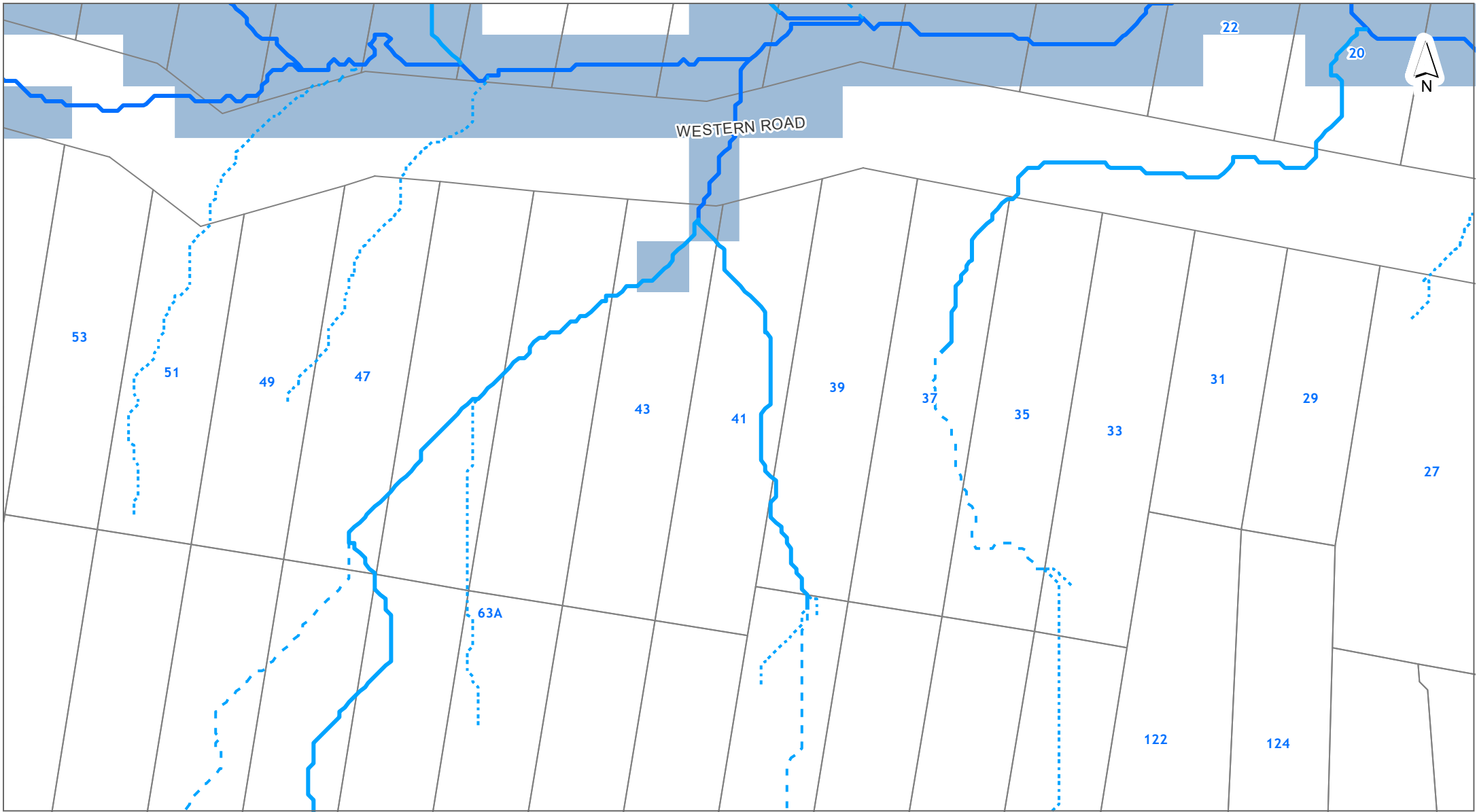

**DISCLAIMER:**  
This map/plan is illustrative only and all information should be independently verified on site before taking any action.  
Copyright Auckland Council. Land Parcel Boundary information from LINZ (Crown Copyright Reserved). Whilst due care has been taken, Auckland Council gives no warranty as to the accuracy and plan completeness of any information on this map/plan and accepts no liability for any error, omission or use of the information. Height datum: Auckland 1946.

**Natural Hazards - Flooding**

**41 Western Road Laingholm**

**LOT 253 DP 19098**

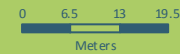

**Scale @ A4**  
**= 1:1,000**

**Date Printed:**  
**12/12/2022**



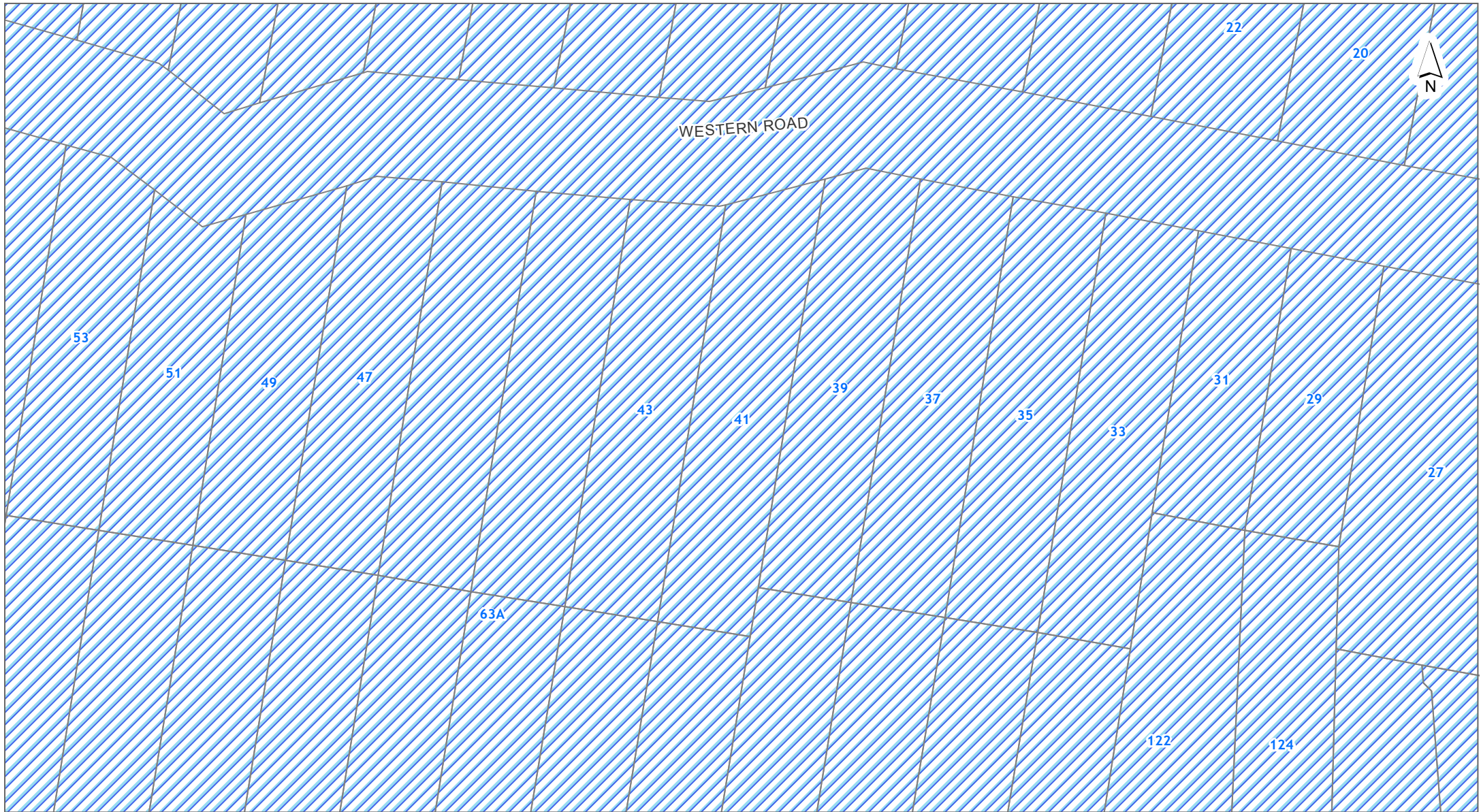

**DISCLAIMER:**  
This map/plan is illustrative only and all information should be independently verified on site before taking any action.  
Copyright Auckland Council. Land Parcel Boundary information from LINZ (Crown Copyright Reserved). Whilst due care has been taken, Auckland Council gives no warranty as to the accuracy and plan completeness of any information on this map/plan and accepts no liability for any error, omission or use of the information. Height datum: Auckland 1946.

**Natural Hazards - Sea Spray**

**41 Western Road Laingholm**

**LOT 253 DP 19098**

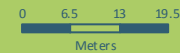

**Scale @ A4**  
**= 1:1,000**

**Date Printed:**  
**12/12/2022**







**DISCLAIMER:**  
This map/plan is illustrative only and all information should be independently verified on site before taking any action.  
Copyright Auckland Council. Land Parcel Boundary information from LINZ (Crown Copyright Reserved). Whilst due care has been taken, Auckland Council gives no warranty as to the accuracy and plan completeness of any information on this map/plan and accepts no liability for any error, omission or use of the information. Height datum: Auckland 1946.

**Natural Hazards - Volcanic Cones**

**41 Western Road Laingholm**

**LOT 253 DP 19098**

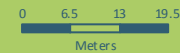

**Scale @ A4  
= 1:1,000**

**Date Printed:  
12/12/2022**





DISCLAIMER:  
This map/plan is illustrative only and all information should be independently verified on site before taking any action.  
Copyright Auckland Council. Land Parcel Boundary information from LINZ (Crown Copyright Reserved). Whilst due care has been taken, Auckland Council gives no warranty as to the accuracy and plan completeness of any information on this map/plan and accepts no liability for any error, omission or use of the information. Height datum: Auckland 1946.

Other  
41 Western Road Laingholm  
LOT 253 DP 19098

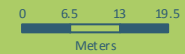

Scale @ A4  
= 1:1,000

Date Printed:  
12/12/2022





Hazards

Soil Warning Area

-  Fill (Franklin District only)
-  Advisory (Franklin District only)
-  Contamination (Franklin District only)
-  Erosion (Franklin District only)
-  Hazardous Activities & Industries List (HAIL) (Franklin District only)
-  Inundation (Franklin District only)
-  Rainfall Event (Franklin District only)
-  Slippage (Franklin District only)
-  Subsidence (Franklin District only)
-  Slippage / Subsidence / Erosion etc (Auckland City and Papakura District only)
-  Uncertified Fill (Auckland City and Papakura District only)
-  Organic Soil (Auckland City and Papakura District only)
-  Filled / Weak Ground (Auckland City and Papakura District only)
-  Refuse Tips Site / Weak Area (Auckland City and Papakura District only)
-  Unstable / Suspected Ground (Auckland City and Papakura District only)
-  Allochthon Waitemata (Rodney District only)
-  Motatau Complex (Rodney District only)
-  Puriri Mudstone (Rodney District only)
-  Mahurangi Limestone (Rodney District only)
-  Mangakahia Complex (Rodney District only)
-  Hukerenui Mudstone (Rodney District only)
-  Whangai Formation (Rodney District only)
-  Tangihua Complex (Rodney District only)
-  within 150m of Northland Allochthon (Rodney District only)











Hazards

Soil Warning Area continued









-  Soil D (Rodney District only)
-  within 150m of Soil D (Rodney District only)
-  Soil C (Rodney District only)
-  within 150m of Soil C (Rodney District only)
-  Soil B (Rodney District only)
-  within 150m of Soil B (Rodney District only)
-  Soil A (Rodney District only)
-  Gas Main Pipeline
-  Petroleum Pipeline
-  Closed Landfill (Auckland Council owned)
-  Closed Landfill (Privately owned)
-  Air Discharge (Franklin District only)
-  No Soakage (Franklin District only)
-  Indicative Steel Mill Slurry Line 20m Buffer (Franklin District only)
-  Indicative Steel Mill Water Line 20m Buffer (Franklin District only)

Natural Hazards

Overland Flow Path







-  Catchment area 100 Ha and above
-  Catchment area 3 Ha to 100 Ha
-  Catchment area 1 Ha and 3 Ha
-  Catchment area 4000 m<sup>2</sup> to 1 Ha
-  Catchment area 2000 m<sup>2</sup> to 4000 m<sup>2</sup>
-  1% AEP Flood Plain
-  Flood Prone Areas
-  Flood Sensitive Areas
-  Sea Spray
-  Volcanic Cones

Coastal Inundation

-  1% AEP
  -  1% AEP plus 1m sea level rise
  -  1% AEP plus 2m sea level rise
- Areas Susceptible to Coastal Instability and Erosion (ASCIE)**
-  ASCIE 2050 (RCP8.5)
  -  ASCIE 2080 (RCP8.5)
  -  ASCIE 2130 (RCP8.5)
  -  ASCIE 2130 (RCP8.5+)
  -  Marine Area (Based on MHWs10, from Unitary Plan)

Other

Cultural Heritage Index

-  Archaeological Site
-  Hayward and Diamond
-  Historic Botanical Site
-  Historic Structure
-  Maori Heritage Area
-  Maritime Site
-  Reported Historic Site

The information Council holds in relation to Special Land Features differs based on the area a property is located in. Those areas where information is held on a Special Land Feature is denoted in the legend above.

Legend updated: 22/07/2021



# Guardian Housing Services Ltd

Building Performance, Safety & Compliance Specialists

Tel: 849 5511 | Mobile: 021 500 269 | PO Box 57059 Owairaka Auckland  
Email: [bill@guardianhousing.co.nz](mailto:bill@guardianhousing.co.nz) | [www.guardianhousing.co.nz](http://www.guardianhousing.co.nz)

**Job Ref: 4810**

25<sup>th</sup> January 2023

Mr. A Bakker.  
41 Western Road,  
Langholm,  
**AUCKLAND.**

**STATEMENT OF PASSING OVER INFORMATION:**

This information has been supplied to us by a third party. Accordingly the Vendor and Austar Realty Limited are merely passing over this information as supplied to us by others. While we have passed on this information supplied by a third party, we have not checked, audited, or reviewed the records or documents and therefore to the maximum extent permitted by law neither the Vendor nor Austar Realty Limited or any of its salespersons or employees accept any responsibility for the accuracy of the materials, intending purchasers are advised to conduct their own investigation.

Dear Sir

**RE: SAFE AND SANITARY REPORT, RUMPUS ROOM AND DECK AT THE REAR OF THE DWELLING, 41 WESTERN ROAD, LANGHOLM.**



## **1. INTRODUCTION**

- 1.1 This report has been prepared at the request of Mr. Bakker in order to advise of works undertaken without the necessary approvals or permissions.
- 1.2 Guardian Housing Services Ltd have been engaged to inspect the property and provide opinion as reasonably as practically possible as to whether the room that has been established at the rear of the dwelling and the deck at the rear accessed from the upper level can be considered as being Safe and Sanitary in terms of Section 121 and 123 of the New Zealand Building Act 2004.

## **2. INSPECTION**

- 2.1 A visual inspection only was undertaken on the 25<sup>th</sup> January 2023 in fine weather conditions. This inspection was undertaken by Bill Cartwright who is an employee of Guardian Housing Services Ltd.
- 2.2 This report is not intended to address compliance with the current building code requirements, nor does it address any matters associated with any other Acts or By-Laws that could be impacted by the works being the subject of this report, in particular the Resource Management Act and District Plan requirements. The reader of this report should make their own enquiries relating to any matters outside the scope of this report.
- 2.3 The exact timelines as to when this work was undertaken are unknown. We have been advised that as far as can be reasonably established it was pre-1992.

I am suitably experienced to provide my opinions on this matter on behalf of Guardian Housing Services Ltd; my experience and qualifications are as follows.

I have a trade Certificate in Carpentry and many years of practical experience as a builder, a building inspector, and for the last 16 years as a Building Consultant.

My work experience in summary is as follows:

1970 – 1975:	Apprenticeship in carpentry;
1975 – 1984:	Labour only and contract building;
1984 – 1996:	Building inspector for Council;
1996 – 2002:	Team manager building inspections, Auckland City Council;
2002 – 2009:	Company director of Citywide Building Consultants.
2004 to 2009:	Company director of Sure Build Ltd
2009-2011:	Company director of Eden Pacific Building Consultants Ltd
2011 to Present:	Company director Guardian Housing Services Ltd

I am currently a Licensed Building Practitioner under the current scheme and a member of the Building Officials Institute of NZ. My views expressed in this report are my own independent opinions on behalf of Guardian Housing Services Ltd.

### **3. HISTORY AND SCOPE OF WORKS**

- 3.1 The dwelling is a multi-level pull home located on a steeply sloping section; The dwelling was constructed (circa) 1974. The construction is of lightweight timber frame supported all timber poles which are concrete embedded into the ground. The dwelling is clad on the exterior using vertical Cedar weatherboards plywood and has timber casement joinery.
- 3.2 At some point of time and possibly even at the time of the initial construction a timber frame deck has been erected at the rear of the house and it's accessed from the upper-level living areas. the deck is supported by some of the timber foundation poles which would have been installed as part of the initial construction.
- 3.3 The construction of the deck is of timber joists supported on timber bearers that are through bolted and notched into the foundation piles. The deck has been the subject of some repairs and maintenance over time with a new deck surface being installed, this deck surface is of open slatted (wide) timber boards. A safety barrier has been provided on two sides that is 1 meter in height.
- 3.4 It is evident that this deck would most likely have been constructed at the time of the initial construction of the dwelling (or soon after) however is not shown on the approved plans.
- 3.5 It must always be taken into consideration that decks have limitations to the loading capabilities, particularly the older style of constructed decks. It is the responsibility of the owner to ensure that a deck is used in a responsible manner and not to overload these areas. Regular maintenance is also required to ensure that the structural integrity is not compromised.

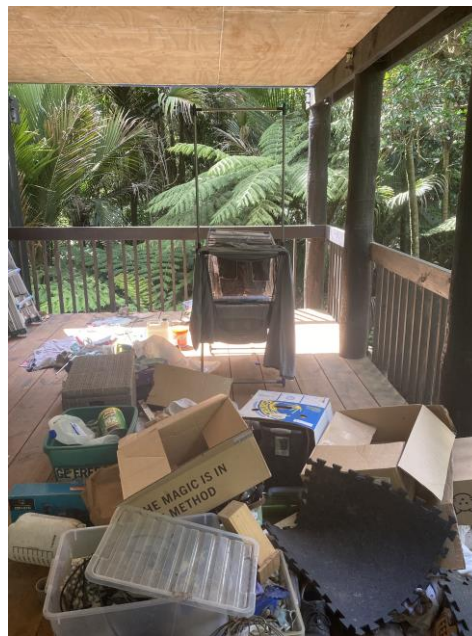

- 3.6 Located at the rear of the dwelling and beneath the deck a room has been established that has supported by the original foundation poles. This room is of timber frame construction and has matching timber joinery. We have been advised that this room was constructed by a former owner of the property and was used as a hobby room. subsequent to that this area has been more recently renovated to serve as a bedroom/ rumpus room area.

3.7 The room has been provided with sufficient window area for natural light and sufficient opening windows to provide for natural ventilation requirements. The ceiling height exceeds the minimum requirements (2.100 as stated in the Auckland council webpage) and was warm and dry at the time of this assessment. There is internal access to the rest of the dwelling from this room.

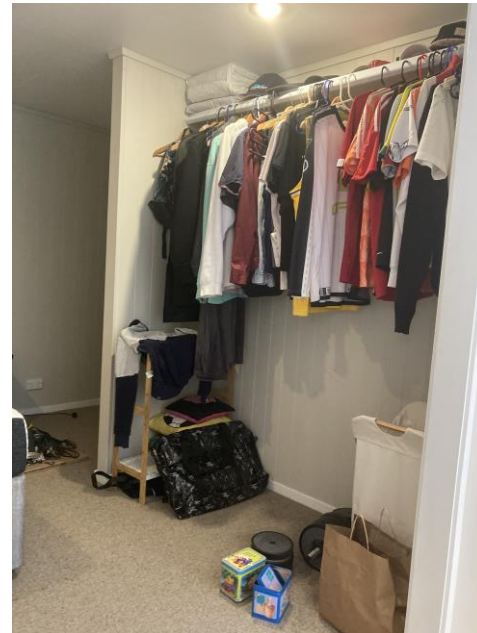



## 4. CONCLUSION

- 4.1 These works appear to have been constructed in an acceptable manner with no visible signs of weakness or problems, which would have an adverse impact on the structural integrity of the property.
- 4.2 Sufficient ventilation is provided to control internal moisture and we could detect no evidence of any mould or other associated internal moisture problems.
- 4.3 It is now a requirement to install smoke detectors (if not installed) within 3 meters of all sleeping rooms, please insure these are installed, tested regularly and maintained.
- 4.4 A building is deemed to be dangerous, if, in the normal course of events (excluding earthquakes) the building is likely to cause injury or death (whether by collapse or otherwise) to any persons in it, or any persons on other property, or damage to other property. In the event of fire, injury or death to any persons in the building or to person on other property is likely due to fire hazard or the occupancy of the building.

### ***A building is deemed to be insanitary if:-***

- 1) ***Is offensive or likely to be injurious to health because (a) of how it is situated or constructed: or (b) it is in a state of disrepair; or***
- 2) ***Has insufficient or defective provisions against moisture penetration as to cause dampness in the building or in any adjoining building; or***
- 3) ***Does not have a supply of potable water that is adequate for its intended use; or***
- 4) ***Does not have sanitary facilities that are adequate for its intended use***

We are of the opinion that the works in question cannot be deemed either “dangerous” or “insanitary” in terms of the above criteria and therefore we would confirm that in our opinion it can be considered safe and sanitary in terms of Section 121 and 123 of The New Zealand Building Act 2004 for its current intended use.

This opinion is based on a visual inspection of those parts of the building reasonably accessible, no invasive or destructive inspection methods were used in this assessment; therefore no opinion can be given in respect of such concealed work.

We hope this report provides the necessary information you require to proceed with this matter, however, should you require any further assistance please do not hesitate to contact the author directly on 021 500 269 or the office on 849 5511

The following two paragraphs (a and b) have been included at the request of Guardian Housing Services Ltd insurance company. (a) This property report is a visual one only of the building elements which could be seen easily, and does not include any item that is closed in or concealed including flooring, walls, ceiling, framing, plumbing and drainage, heating and ventilation and wiring etc. Therefore we are unable to report that any such part of the structure is free from defect. (b) This property report does not include the structural, electrical, plumbing or gas piping and fitting, home heating state of the premises, as our consultants are not qualified for this but can arrange for these areas to be inspected by those people whose qualifications enable them to do so."

This report and all consulting services provided by Guardian Housing Services Ltd or the Consultants employed by the firm are provided solely for the use for the client who gave the instructions. Guardian Housing Services Ltd does not now and will not hereafter assume any responsibility to any person other than the client for any reason whatsoever including breach on contract, negligence (including negligent mis-statement) or wilful act or default of the Company or others by reason of or arising out of the provision of this report or consultancy services. Any person, other than the client, who uses or relies upon this report or the matters contained in it, does so at the risk of that person.

This report has been completed with the specific purpose stated in this report. No responsibility is accepted to any person including the client in the event that the report is used for any other purpose.

This report relates to the situation at the date of the preparation of the report and is relevant to circumstances which prevail at the time.

Guardian Housing Services Ltd does not, as a matter of policy, contract out of the provisions of The Consumer Guarantees Act 1993. Therefore if there is any conflict between any statement contained in this report and any provision contained in The Consumer Guarantees Act 1993 then the provisions of The Consumer Guarantees Act 1993 shall prevail.

The whole or any part of this report may not be included in any published document or circular or statement except with the prior written approval of Guardian Housing Services Ltd as to the form and context in which it may appear.

Substances such as asbestos, other chemicals, toxic waste or other potentially hazardous materials have not been detected except to the extent that the same are reported upon and this report comments on the presence of such hazardous materials only to the extent that it has been possible to determine their presence by a superficial examination of the premises which cannot reveal hidden substances. If the client is concerned about the presence of asbestos, other chemicals, and toxic wastes or other potentially hazardous materials then a more thorough examination of the premises may be required including permission to remove certain building materials in order to examine what lies underneath. While due care has been taken to note the presence of such asbestos, other chemicals, toxic wastes or other potentially hazardous materials such as mould, mildew and moisture as are visible upon a superficial examination of the premises. This report does not constitute an environmental audit and the same cannot be undertaken without additional work and research being carried out with the consent of the client and with additional cost to the client.

Any freestanding fire appliance or inbuilt fireplace is outside the scope of this report. Should this property contain either of these and you wish the condition to be assessed we recommend an approved installer be contacted.

Signed for and on Behalf of Guardian Housing Services Ltd.

Yours sincerely

A handwritten signature in black ink, appearing to read 'Bill Cartwright', written over a horizontal line.

**BILL CARTWRIGHT**  
**GUARDIAN HOUSING SERVICES LTD**